

SMMSe / SHRMe VRF Indoor Unit MMD-AP0156BHPUL—Concealed Duct

TOSHIBA
Carrier

Submittal Data

Job Name _____ Location _____
Tag _____



A210775

SMMSe / SHRMe CONCEALED DUCT FEATURES

- R-410A Refrigerant
- Twelve sizes from 7,500 to 54,000 Btu/h
- Standard condensate pump with 24.3 in. lift capability
- Quiet operation, as low as 30 dBA
- Rear return configurable for bottom return
- Auto or manually set three fan speeds
- Five-year parts limited warranty

INDOOR UNIT MODEL		MMD-AP0156BHPUL
PERFORMANCE		
Cooling Rated Capacity	Btu/h	15,400
Heating Rated Capacity	Btu/h	17,000
Fan Type (Qty)	Centrifugal (1)	
External Static Pressure (ESP)	in. WG	0.4 (Factory default)
		0.6 (Max)
Standard Airflow (H / M / L)	CFM	589 / 489 / 394
Sound Pressure (H / M / L)*	dBA	44 / 41 / 35
FILTER (Standard)		
Type	Washable	
Quantity	2	
MERV Corresponding Value	5	
Dimensions (W x L x D)	in.	105/8 x 19-5/8 x 5/8
ELECTRICAL		
Power Supply	V/Ph/Hz	208-230/1/60
Power Consumption (Input)	kW	0.13
Full Load Amps (FLA)	A	1.53
Minimum Circuit Amps (MCA)	A	1.91
Maximum Overcurrent Protection (MOCP)	A	15.0

MOTOR		
Motor Type	DC	
Motor Watts	150	
PHYSICAL DATA		
Pipe Connection Size - Liquid	in.	3/8 (Flare)
Pipe Connection Size - Suction	in.	5/8 (Flare)
Pipe Connection Size - Drain (OD)	in.	1-1/4
Pipe Connection Size - Drain (ID)	in.	1
Refrigerant	R-410A	
External Finish	Zinc Hot Dipped Steel Plate	
Unit Width	in.	39-3/8
Unit Height	in.	10-7/8
Unit Depth	in.	29-5/8
Net Weight	lb	73

ACCESSORIES

- ☐ Wired Remote Controller (7-Day Programmable) RBC-AMS54E-UL
- ☐ Simple Wired Remote Control RBC-AS41UL
- ☐ Stand-Alone Receiver with Wireless Remote TCB-AX32UL
- ☐ Remote Sensor TCB-TC41LUL
- ☐ Wired Remote Controller - RBC-AMT32UL
- ☐ Auxiliary OA Flange TCB-FF151US-UL
- ☐ Zoning Duct Flange TCB-SF80C6BP-UL

* The actual values in an external operating environment are generally higher than the indicated values due to ambient noise.

DIMENSIONAL DRAWING
CONCEALED DUCT MMD-AP0156BHPUL

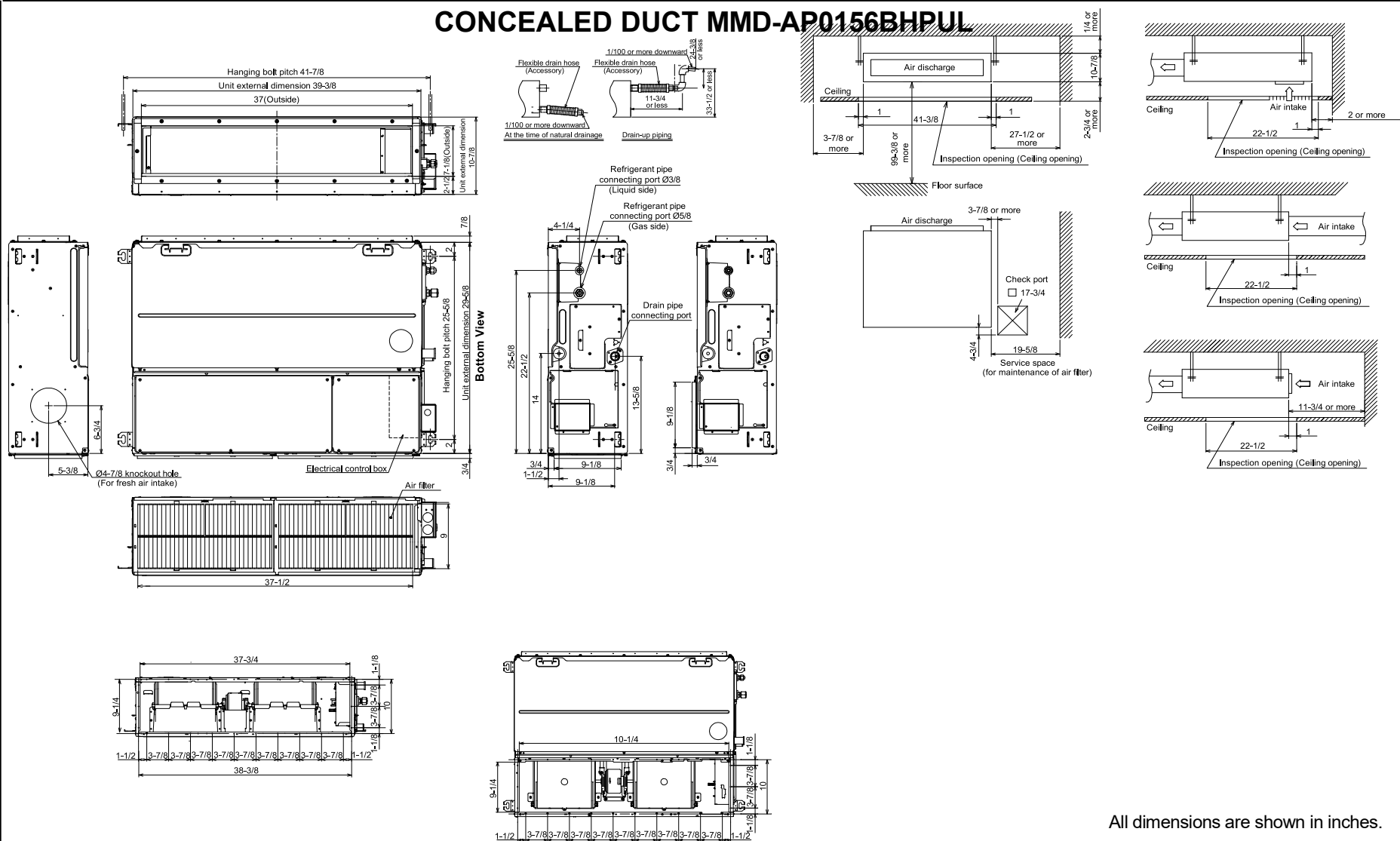

All dimensions are shown in inches.

A210777



© 2021 Carrier. All rights reserved.
A Carrier Company

Edition Date: 12/21
Printed in U.S.A.

Form No: MMD-AP0156BHPUL_02
Replaces: MMD-AP0156BHPUL_01

Manufacturer reserves the right to discontinue, or change at any time, specifications or designs without notice and without incurring obligations.