

SMMSu / SHRMu VRF Indoor Unit MMD-UP0151BHP-UL—Concealed Duct

TOSHIBA
Carrier

Submittal Data

Job Name _____ Location _____
Tag _____



A210775

SMMSu / SHRMu CONCEALED DUCT FEATURES

- R-410A Refrigerant
- Twelve sizes from 7,500 to 54,000 Btu/h
- Standard condensate pump with 24.3 in. lift capability
- Quiet operation, as low as 30 dBA
- Rear return configurable for bottom return
- Auto or manually set three fan speeds
- Five-year parts limited warranty

| | | |
|---------------------------------------|-----------------|-----------------------|
| INDOOR UNIT MODEL | | MMD-UP0151BHP-UL |
| PERFORMANCE | | |
| Cooling Rated Capacity | Btu/h | 15,400 |
| Heating Rated Capacity | Btu/h | 17,000 |
| Fan Type (Qty) | Centrifugal (1) | |
| External Static Pressure (ESP) | in. WG | 0.4 (Factory default) |
| | | 0.6 (Max) |
| Standard Airflow (H / M / L) | CFM | 589 / 489 / 394 |
| Sound Pressure (H / M / L)* | dBA | 44 / 41 / 35 |
| FILTER (Standard) | | |
| Type | Washable | |
| Quantity | 2 | |
| MERV Corresponding Value | 5 | |
| Dimensions (W x L x D) | in. | 105/8 x 19-5/8 x 5/8 |
| ELECTRICAL | | |
| Power Supply | V/Ph/Hz | 208-230/1/60 |
| Power Consumption (Input) | kW | 0.13 |
| Full Load Amps (FLA) | A | 1.53 |
| Minimum Circuit Amps (MCA) | A | 1.91 |
| Maximum Overcurrent Protection (MOCP) | A | 15.0 |

| | | |
|-----------------------------------|-----------------------------|-------------|
| MOTOR | | |
| Motor Type | DC | |
| Motor Watts | 150 | |
| PHYSICAL DATA | | |
| Pipe Connection Size - Liquid | in. | 3/8 (Flare) |
| Pipe Connection Size - Suction | in. | 5/8 (Flare) |
| Pipe Connection Size - Drain (OD) | in. | 1-1/4 |
| Pipe Connection Size - Drain (ID) | in. | 1 |
| Refrigerant | R-410A | |
| External Finish | Zinc Hot Dipped Steel Plate | |
| Unit Width | in. | 39-3/8 |
| Unit Height | in. | 10-7/8 |
| Unit Depth | in. | 29-5/8 |
| Net Weight | lb | 73 |

ACCESSORIES

- ☐ Wired Remote Controller (7-Day Programmable) RBC-AMS54E-UL / RBC-AWSU52-UL
- ☐ Simple Wired Remote Control RBC-AS41UL
- ☐ Remote Sensor TCB-TC41U-UL
- ☐ Auxiliary OA Flange TCB-FF151US-UL
- ☐ Zoning Duct Flange TCB-SF56C6BP-UL
- ☐ Filter Kit TCB-FW561DP-UL

* The actual values in an external operating environment are generally higher than the indicated values due to ambient noise.

DIMENSIONAL DRAWING
CONCEALED DUCT MMD-UP0151BHP-UL

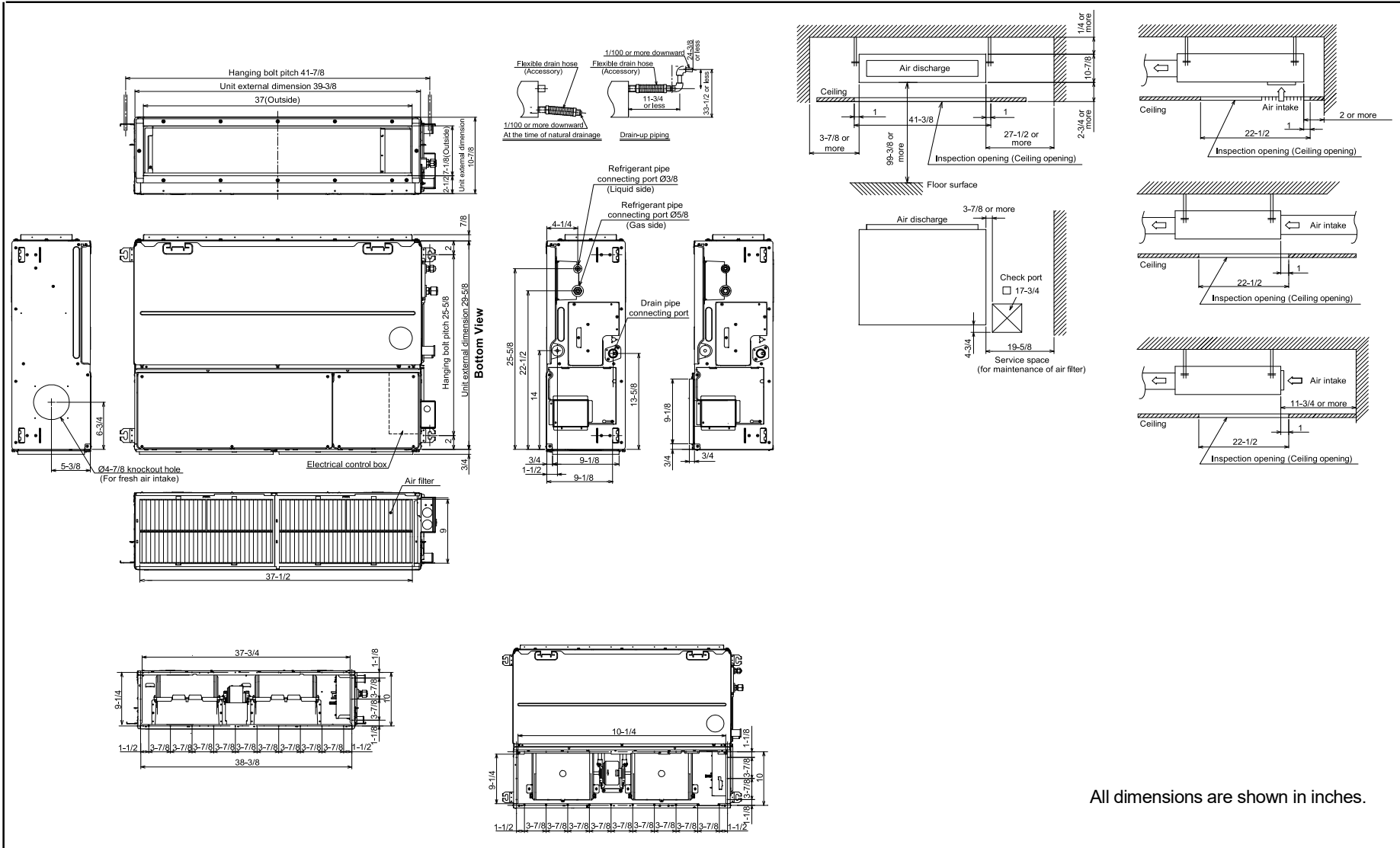

All dimensions are shown in inches.

A210777



© 2023 Carrier. All rights reserved.
A Carrier Company

Edition Date: 01/23
Printed in U.S.A.

Form No: MMD-UP0151BHP-UL_01
Replaces: MMD-AP0156BHPUL 02

Manufacturer reserves the right to discontinue, or change at any time, specifications or designs without notice and without incurring obligations.