



Installation Instructions

Part No. CRFLUEDS011A00, CRFLUEDS012A00

CONTENTS

	Page
GENERAL	1
SAFETY CONSIDERATIONS	1
INSTALLATION	1
MAINTENANCE	5

Read these instructions completely before attempting to install this accessory.

Table 1 — Package Contents

ACCESSORY PACKAGE NO.	QTY	DESCRIPTION
CRFLUEDS011A00 (Low Heat)	1	Duct Assembly
	1	Chimney
	1	Top Assembly
	1	Duct Assembly
	4	Support Bracket
	1	Bag of 48 Screws
CRFLUEDS012A00 (High Heat)	1	Duct Assembly
	1	Chimney
	1	Top Assembly
	2	Duct Assembly
	4	Support Bracket
	1	Bag of 48 Screws

Table 2 — Model Usage

ACCESSORY PART NUMBER	USAGE ^a
CRFLUEDS011A00	48V*C, 48V*E, 48V*T, 48V*V
CRFLUEDS012A00	48V*D, 48V*F, 48V*U, 48V*W

NOTE(S):

a. The asterisk is used as a wild card for characters and numbers.

GENERAL

This installation instruction contains installation information for the Applied Rooftop unit, V Series chimney. The chimney is installed for better control of exhaust gas flow and to prevent exhaust gas recirculation into the unit.

SAFETY CONSIDERATIONS

Installation of this accessory can be hazardous due to system pressures, electrical components, and equipment location (such as a roof or elevated structure). Only trained, qualified installers and service technicians should install, start-up, and service this equipment.

When installing this accessory, observe precautions in the literature, labels attached to the equipment, and any other safety precautions that apply:

- Follow all safety codes
- Wear safety glasses and work gloves
- Use care in handling and installing this accessory

It is important to recognize safety information. This is the safety-alert symbol: . When you see this symbol on the unit and in instructions or manuals, be alert to the potential for personal injury.

Understand the signal words DANGER, WARNING, CAUTION, and NOTE. These words are used with the safety-alert symbol. DANGER identifies the most serious hazards which **will** result in severe personal injury or death. WARNING signifies hazards which **could** result in personal injury or death. CAUTION is used to identify unsafe practices, which **may** result in minor personal injury or product and property damage. NOTE is used to highlight suggestions which **will** result in enhanced installation, reliability, or operation.

WARNING

ELECTRICAL SHOCK HAZARD

Failure to follow this warning could result in personal injury and/or death.

Before beginning any modification, be certain that the main-line electrical disconnect switch is in the OFF position. Close the main gas supply shutoff valve. Tag disconnect switch and gas valve with suitable warning labels.

CAUTION

PERSONAL INJURY HAZARD

Failure to follow this caution may result in personal injury.

Sheet metal parts may have sharp edges or burrs. Use care and wear appropriate protective clothing, safety glasses and gloves when handling parts and servicing air conditioning equipment.

INSTALLATION

The number of openings on the chimney differs based on heat size; see Tables 1 and 2 for package contents and model usage.

1. Determine the heat capacity of the unit:
 - a. For 48V 27-35 Tons:
 - 380 MBH is Low Heat
 - 650 MBH is High Heat
 - b. For 48V 40-50 Tons:
 - 380 MBH is Low Heat

- 730 MBH is High Heat
2. The chimney for 48V comes pre-assembled for low and high heat furnace. See Fig. 1 and 2.
 3. Attach mounting bracket and flue discharge assembly to the chimney stack.
 4. Remove all flue exhaust hoods (Fig. 3) from the unit skin.
 5. Locate the flue discharge and mounting bracket location on the unit and install the flue deflector using the supplied self-drilling screws in the kit. See Fig. 4-7.

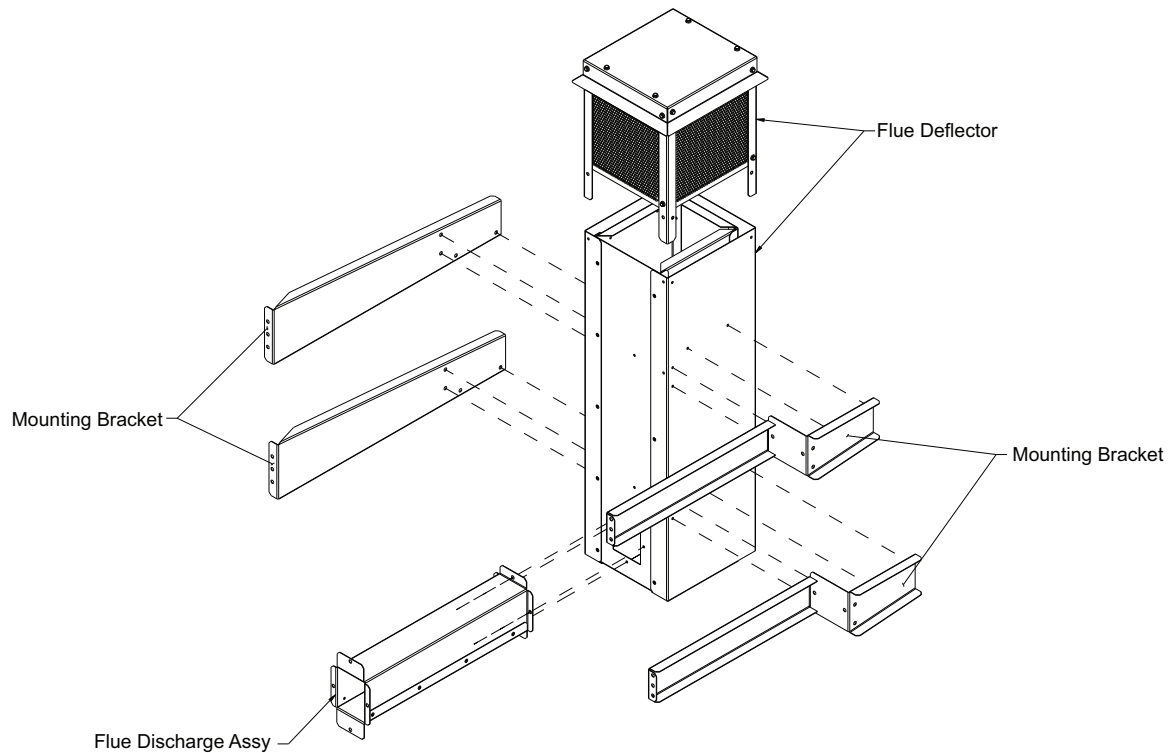

Fig. 1 — Flue Discharge Deflector Assembly (Low Heat)

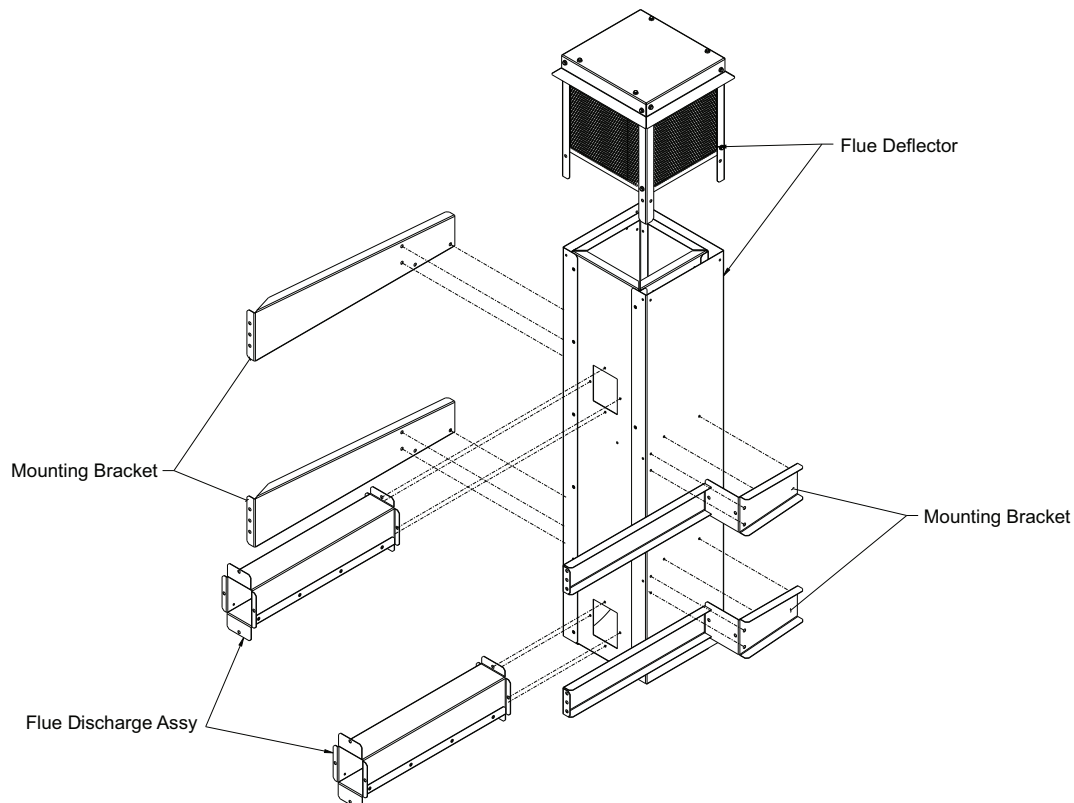

Fig. 2 — Flue Discharge Deflector Assembly (High Heat)



Fig. 3 — Flue Exhaust Hood

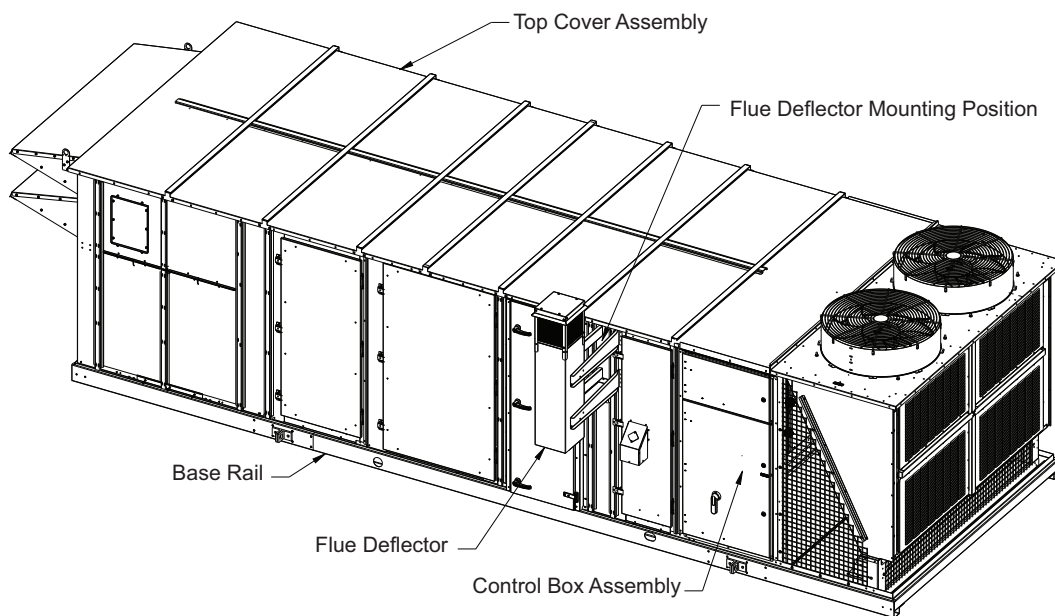

Fig. 4 — Flue Discharge Deflector Mounting Position (Low Heat)

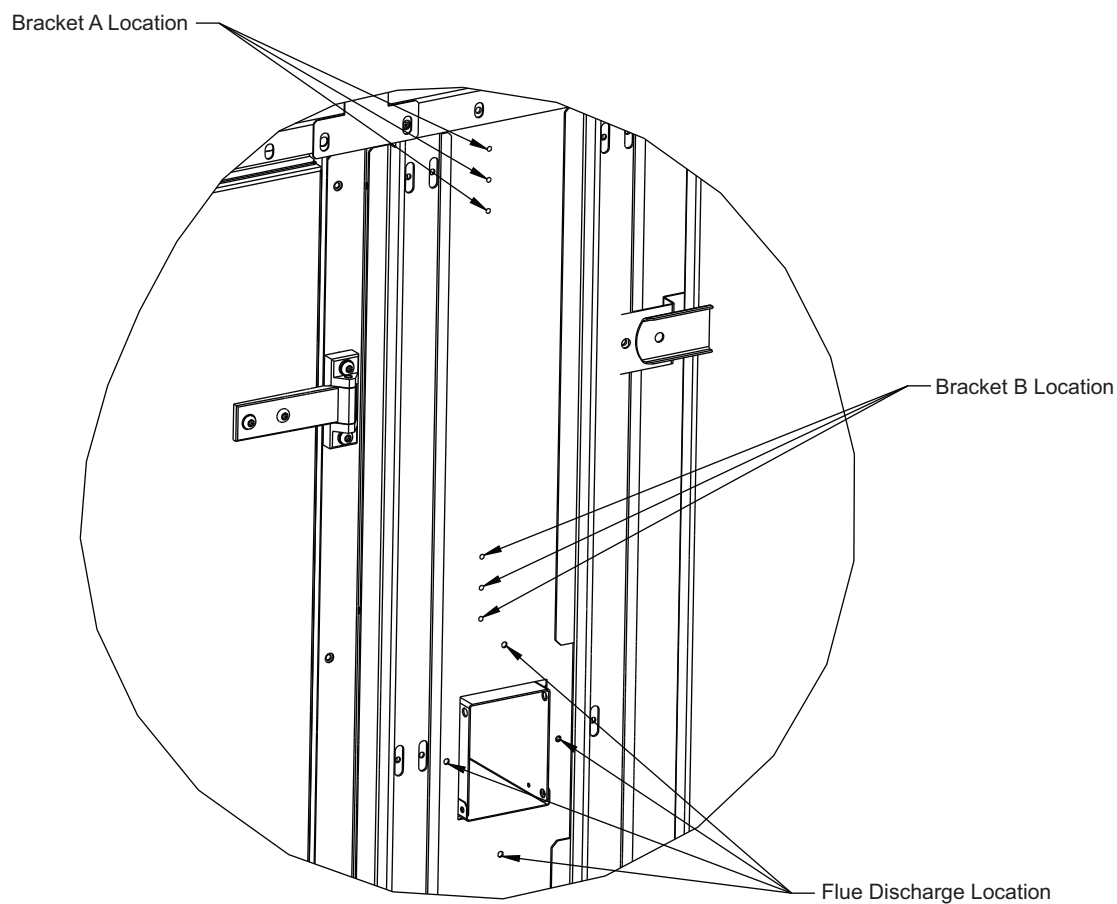

Fig. 5 — Flue Discharge Deflector Mounting Position — Low Heat (Detail View)

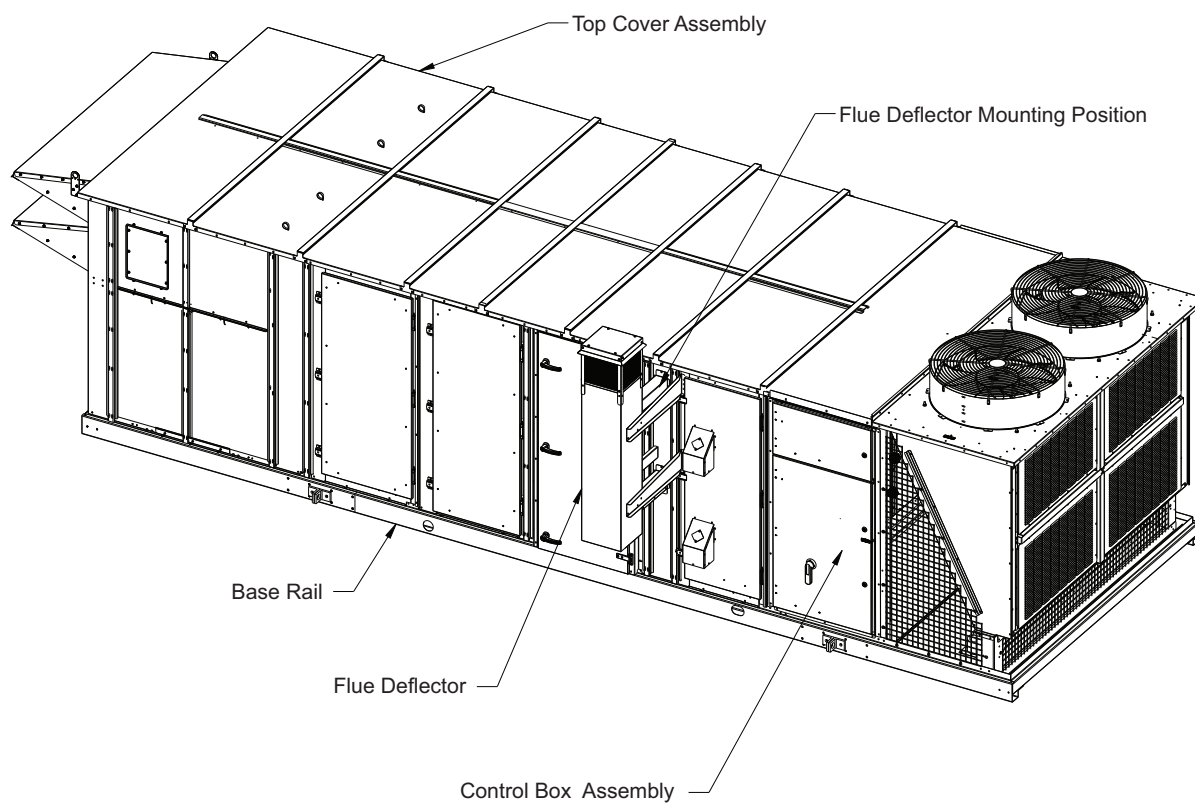

Fig. 6 — Flue Discharge Deflector Mounting Position (High Heat)

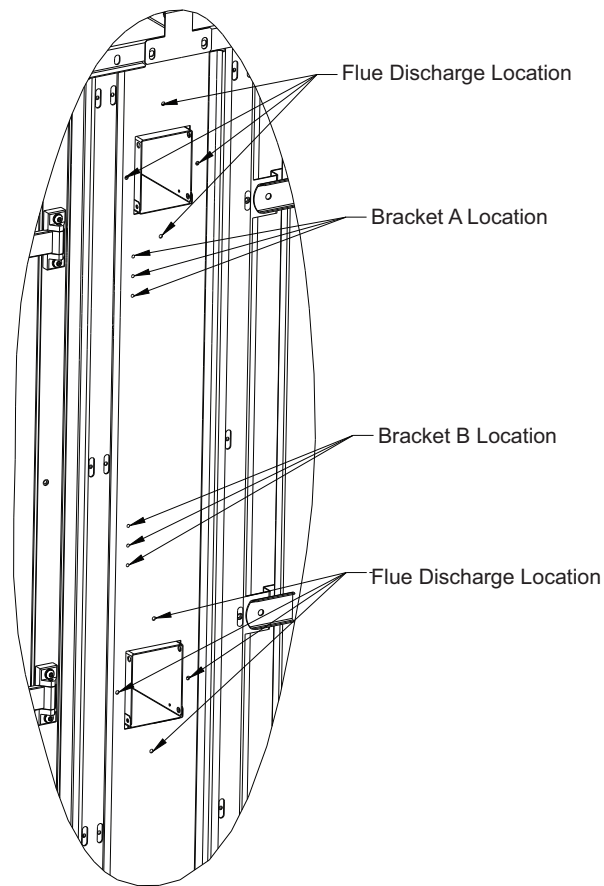

Fig. 7 — Flue Discharge Deflector Mounting Position — High Heat (Detail View)
MAINTENANCE

IMPORTANT: To guard against leakage, verify there are no unfilled screw holes.

Inspect screens on bottom chimney piece and on deflector assembly and remove any debris to ensure proper airflow and heating efficiency. Inspect full length of flue stack for any blockages which could impair flue performance. Inspect every fall, and periodically during heating season.

