



# California Direct Purchasing Contract - CMAS



## What is Direct Purchasing & Who Can Use It?

California Multiple Award Schedules (CMAS) allows state and local agencies ("Authorized User") the ability to replace equipment and services quickly and efficiently in support of their missions and everyday needs.

By definition, a state or local government agency is any city, county, district, or other local governmental body, including California State University (CSU) and University of California (UC) systems, K-12 public schools and community colleges.

## How Do I Buy?

Three easy steps...

- Contact your local Sigler representative for equipment, controls or parts needs
- Communicate your intention to use CMAS direct purchasing contract
- Your local representative will work with Carrier to fulfill your requirements in accordance with the terms of the contract

Please visit the [CMAS FAQs](#) for more information.

## CONTRACT INFORMATION

Contract No:

**4-20-51-0084A**

Contract Period:

**2/19/2020 to 3/19/2024**

For Use By:

**State & Local Governments**

Carrier Contact:

**Brian Meneghan | 518-415-2003**

[brian.meneghan@carrier.com](mailto:brian.meneghan@carrier.com)

Reseller:

**Sigler SoCal | Joseph Morales**

[jmorales@siglers.com](mailto:jmorales@siglers.com)

**Sigler NoCal | Jimme Wood**

[jiwood@siglers.com](mailto:jiwood@siglers.com)

Helpful Links:

[CMAS](#) | [State of Emergency Use](#) | [FEMA Co-Op](#)

## Competitively-Priced OEM & Aftermarket Parts

Our experienced parts team is dedicated to serving commercial national accounts and can help satisfy your parts needs for both Factory Authorized Parts designed for Carrier equipment as well as our Totaline aftermarket brand which can be used on **ANY BRAND** of equipment.

You can reach our parts specialists at **833-763-0260**

or via email at [carriernationalparts@carrier.com](mailto:carriernationalparts@carrier.com)

Turn to the experts in cooling, heating, ventilating, heat pumps, and heat recovery chillers and electrification for temporary and permanent facilities.

### Chillers

- Air-Cooled: 10 to 500 tons
- Water-Cooled: 16 to 3,400 tons
- Screw, scroll, centrifugal
- Heat Recovery



30XV  
Air-Cooled Liquid  
Screw Chiller



19DV  
Water-Cooled  
Centrifugal Chiller



30RB  
Air-Cooled Liquid  
Scroll Chiller



19XR  
Semi-Hermetic  
Centrifugal Chiller

### Air Handlers

- 1,000 to 300,000 Cfm
- Single/Double Wall
- Custom
- Indoor/Outdoor



39CC  
Custom Air Handler



39M  
Semi-Custom Air  
Handler



39L  
Indoor Air Handler



39S  
Indoor/Outdoor Small  
Air Handler

### Air Terminals

- Single-duct units
- Series fan-powered
- Fan coil unit
- Unit ventilator



45N  
Fan-Powered  
Air Terminal



40UV  
Unit Ventilator



42CG  
Cabinet Fan Coil

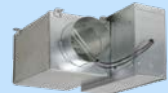

35E  
Single-Duct Terminal

### Packaged Rooftop Units

- 3-Phase Heat Pumps
- Cooling Only
- Electric Heat
- Hybrid Heat



48A  
Single Packaged  
Rooftop Unit



48FC  
Gas Heat/Electric  
Cooling



50LC  
Electric Cooling  
Unit



50KCQ  
3-Phase  
Heat Pump



62X  
Dedicated  
Outdoor Air Unit

### Water Source Heat Pumps

- Console Units
- Vertical
- Horizontal
- Water-to-Water



50PEC  
Console WSHP



50PSW  
Water-to-Water  
WSHP



50PCV  
Constant Volume  
WSHP



50HQP  
Large Capacity  
WSHP

### Controls

- i-Vu® Building Automation System
- Sensors
- Thermostats
- BACnet Controllers
- Carrier Comfort Network



i-Vu® Building  
Automation System



Carrier Connect  
BACnet Thermostats



ZS Series  
Sensors



CCN TouchPilot™  
Controller



i-Vu®  
RTU Open

Talk with an Expert in Temporary and Rapid-Deployment HVAC Solutions Today.

