



Installation Instructions

Part No. CRSMKDET003C00, CRSMKDET006A00, and CRSMKDET007A00

CONTENTS

	Page
SAFETY CONSIDERATIONS	1
GENERAL	2
INSTALLATION	2
Check Package Contents	2
Return Air Smoke Detector - CRSMKDET003C00 (Standard and Extended Standard Chassis)	4
Supply Air Smoke Detector (Standard and Extended Standard Chassis)	6
Return Air Smoke Detector - CRSMKDET006A00 (Compact Chassis with Vertical Return)	6
Return Air Smoke Detector - CRSMKDET007A00 (Compact Chassis with Horizontal Return)	8
Supply Air Smoke Detector (Compact Chassis) ...	8
OPERATION	10
Configuring the SmartVu Controller	10
MAINTENANCE	10
Cleaning Procedure	10
• AIR FILTERS	
• PHOTO DETECTOR BOARD	
Filter Replacement	10
Board Replacement	10
• SMOKE DETECTOR BOARD REPLACEMENT	
• POWER BOARD REPLACEMENT	
TROUBLESHOOTING	11
Smoke Entry Tests	11
• AIRFLOW TEST	
• SMOKE RESPONSE TEST	
Standby, Alarm, and Sensitivity Tests	11
• STANDBY AND TROUBLE TEST	
• ALARM TEST	
• SENSITIVITY TEST	

SAFETY CONSIDERATIONS

Installation of this accessory can be hazardous due to system pressures, electrical components, and equipment location (such as a roof or elevated structure). Only trained, qualified installers and service technicians should install, start-up, and service this equipment.

When installing this accessory, observe precautions in the literature, labels attached to the equipment, and any other safety precautions that apply:

- Follow all safety codes
- Wear safety glasses and work gloves
- Use care in handling and installing this accessory

It is important to recognize safety information. This is the safety-alert symbol: . When you see this symbol on the unit and in

instructions or manuals, be alert to the potential for personal injury.

Understand the signal words DANGER, WARNING, CAUTION, and NOTE. These words are used with the safety-alert symbol. DANGER identifies the most serious hazards which will result in severe personal injury or death. WARNING signifies hazards which could result in personal injury or death. CAUTION is used to identify unsafe practices, which may result in minor personal injury or product and property damage. NOTE is used to highlight suggestions which will result in enhanced installation, reliability, or operation.

⚠ CAUTION

The National Fire Protection Association (NFPA) has established that DUCT DETECTORS MUST NOT BE USED AS A SUBSTITUTE FOR OPEN AREA DETECTOR PROTECTION as a means of providing life safety. Nor are they a substitute for early warning in a building's regular fire detection system. Carrier supports this position and strongly recommends that the user read NFPA Standards 90A, 72, and 101. This smoke detector is listed per UL 268A.

NOTICE

OPERATIONAL TEST ALERT

Failure to follow this ALERT can result in an unnecessary evacuation of the facility.

If the smoke detector is connected to a fire alarm system, first notify the proper authorities that the detector is undergoing maintenance, then disable the relevant circuit to avoid generating a false alarm.

NOTICE

OPERATIONAL TEST ALERT

Failure to follow this ALERT can result in an unnecessary evacuation of the facility.

This test places the duct detector into the alarm state. Unless part of the test, disconnect all auxiliary equipment from the controller before performing the test. If the duct detector is connected to a fire alarm system, notify the proper authorities before performing the test.

⚠ WARNING

This device will not operate without electrical power. Fire situations may cause an interruption of power. The system safeguards should be discussed with your local fire protection specialist.

⚠ WARNING

This device will not sense smoke unless the ventilation system is operating and the cover is installed.

⚠ WARNING

For this detector to function properly, it MUST be installed according to the instructions in this manual. Furthermore, the detector MUST be operated within ALL electrical and environmental specifications listed in this manual. Failure to comply with these requirements may prevent the detector from activating when smoke is present in the air duct.

GENERAL

An HVAC (heating, ventilation and air-conditioning) system supplies conditioned air to virtually every area of a building. Smoke introduced into this air duct system will be distributed throughout the entire building. Smoke detectors designed for use inside the unit are used to sense the presence of smoke passing through the unit.

The smoke detector utilizes photoelectric technology for the detection of smoke. This detection method, when combined with an efficient ducting design, samples air passing through the unit. If sufficient smoke is sensed, an alarm signal is initiated and the SmartVu controls will shut down the unit. With the unit shut down, the unit will not blow toxic smoke and fire gases throughout the areas served by the duct system.

INSTALLATION

⚠ CAUTION

When installing the smoke detector in the unit, follow all local codes. Damage to unit may result.

Check Package Contents

Remove accessory packaging and inspect shipment for damage. If any damage is found, file a claim with the shipping agent immediately. If any item is missing or any part does not assemble properly, notify your Carrier distributor.

See Fig. 1 for smoke detector wiring connections. See Fig. 2 for smoke detector parts and components. See Table 1 for accessory usage. See Table 2 for accessory package contents.

Table 1 — Accessory Package Usage

ACCESSORY KIT NUMBER	48/50V UNIT SIZE	MN POS (4)	MN POS (5)
CRSMKDET003C00	28-98	2,3,4,5	A,B,C,D,E,F,G,H
CRSMKDET006A00	28-50	2,3	S,T,U,V,W,X,Y,Z
CRSMKDET007A00	28-50	4,5	S,T,U,V,W,X,Y,Z

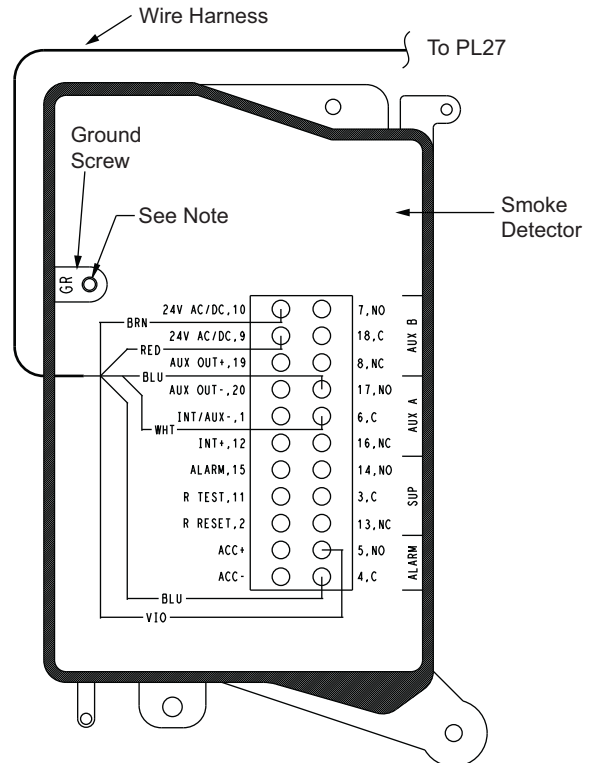

NOTE: Use ground screw in smoke detector to secure wire tie. Use wire tie to provide strain relief for harness.

Fig. 1 — Smoke Detector Wiring Connections

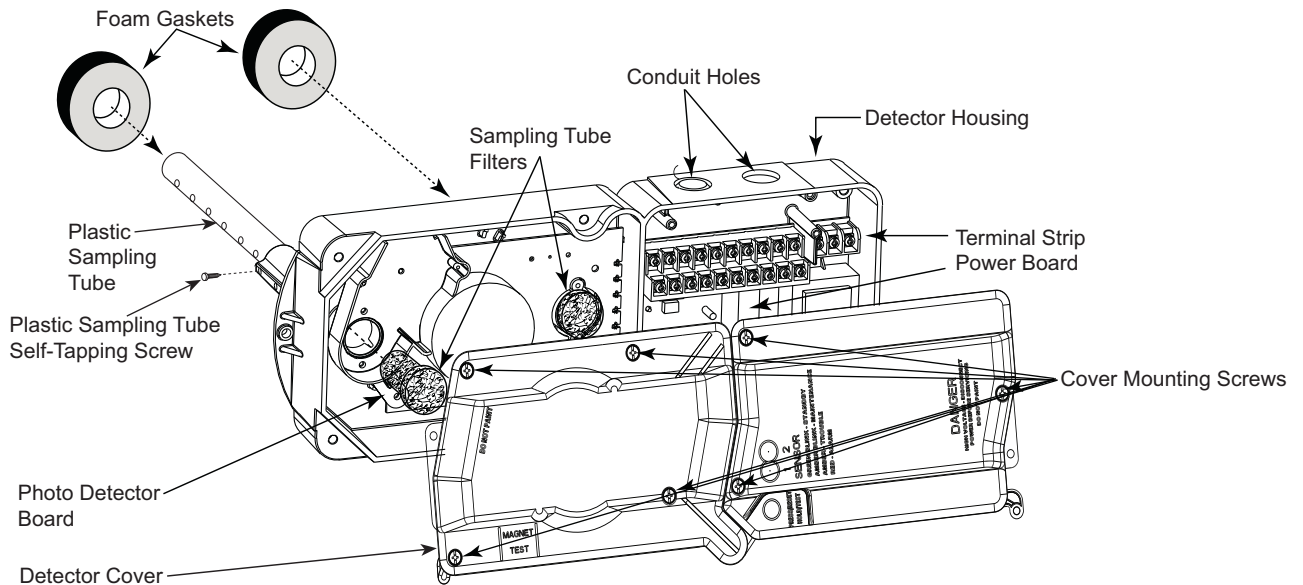

Fig. 2 — Smoke Detector Parts and Components

Table 2 – Accessory Package Contents

ACCESSORY KIT NUMBER	PART NUMBER	PACKAGE CONTENTS	QUANTITY
CRSMKDET003C00	48EJ509917	Smoke Detector	1
	50HE503749	Smoke Sampling Tube DST5	1
	48VV025255	Bracket	1
	48VV004997	Bracket	1
	48VV005032	Bracket	2
	AL56AU168	Screw, PL PND	3
	HY93NH085	Snap Bushing	1
	48VV003932	Harness Assembly	1
	HY76TB110	Wire Tie	2
	AL56ZA003	Screw Fastener	3
LF31MF001	Tape	12 ft	
CRSMKDET006A00	48EJ509917	Smoke Detector	1
	48VV003961	Bracket (Compact Chassis-Vertical Return)	1
	48VV003962	Bracket (Compact Chassis-Vertical Return)	1
	48VV003963	Bracket (Compact Chassis-Vertical Return)	1
	HY93NH085	Snap Bushing	1
	50HE503749	Smoke Sampling Tube	1
	AL56AU168	Screw, PL PND no. 8 x 75	3
	AL56ZA003	Screw Fastener	8
	48VV003932	Harness Assembly (27-50T RASD Jumper)	1
	99SR12011201	Seal Strip	0.9 ft
	LF31-68	Foil Tape	1
	KA56GR093	Grommet Fastener	1
	RN20DS012	Exhaust Tube	1
LF31MF001	Tape	12 ft	
CRSMKDET007A00	48EJ509917	Smoke Detector	1
	48VV001247	Sampling Tube Bracket	1
	48VV003932	Harness Assembly (27-50T RASD Jumper)	1
	48VV004515	Bracket (Compact Chassis-Horizontal Return)	1
	48VV004516	Bracket (Compact Chassis-Horizontal Return)	1
	AL56ZA003	Screw Fastener	7
	HY76TB110	Wire Tie (Self Clinching)	2
	HY76TB130	Wire Tie (Various Sizes)	3
	HY93NH085	Snap Bushing	1
	RN20DS023	Smoke Sampling Tube	1
	AL56AU168	Screw, PL PND no. 8 x 75	3
	LF31-68	Foil Tape	1
	RN20DS012	Exhaust Tube	1
	LF31MF001	Tape	12 ft

Return Air Smoke Detector - CRSMKDET003C00 (Standard and Extended Standard Chassis)

⚠ WARNING

Prior to installation of this accessory, make sure all power is disconnected to the unit and locked out. Failure to disconnect power supply prior to servicing may result in serious injury.

NOTE: For horizontal applications it is easiest to install the smoke detector prior to making duct connections.

IMPORTANT: Installation instructions for compact chassis units differ and are not covered in this section.

See Fig. 4 and 5 for return air smoke detector mounting locations on standard and extended standard chassis units. Follow Steps 1-20 for installation.

1. Determine the type of relief the unit is equipped with:
 - a. Units without relief option or end-mounted power exhaust:

Remove the side bottom panels to gain access to the return air section. Retain all fasteners for reinstallation. See Fig. 3 for panel access locations.
 - b. Units with side-mounted barometric relief or power exhaust:
 - 1) Remove the top and side panels securing the relief hood assembly. Retain all fasteners for reinstallation. See Fig. 3 for panel access locations.
 - 2) Remove the side-mounted power exhaust assembly, as required, to fully access the return air section. See Fig. 3 for panel access locations.
2. Locate the pre-drilled holes on the economizer frame assembly for installation of the smoke detector sensor mounting bracket. See Fig. 5 and 6 for part number and bracket locations.
3. Locate the pre-drilled holes at the bottom of the economizer frame assembly for installation of the sampling tube support bracket. See Fig. 7 for sampling tube bracket part number and installation location.
4. Remove the smoke detector cover. The cover screws are captive and will remain attached to the cover. Refer to Fig. 2 for component (cover and screw) locations.
5. Install the foam gaskets onto each sampling tube connection on the smoke detector. Refer to Fig. 2 for foam gasket locations.
6. Remove one conduit knockout from the smoke detector housing.
7. Route the stripped wire harness leads through the conduit opening and terminate wiring at the smoke detector terminals as shown in Fig. 1.
8. Insert the smoke detector sensor assembly into the openings in the mounting bracket.

NOTE: Do not secure the smoke detector at this time. See Fig. 4 for mounting bracket and sampling tube locations.
9. Install the tube end plug into the sampling tube, as shown in Fig. 8.

Insert the sampling tube into the lower port of the smoke detector sensor module where it interfaces with the photo detector board as shown in Fig. 2 and 4.
10. Slide the sampling tube through the sampling tube support brackets. See Fig. 4-7 for installation example and part locations.

11. Ensure sampling holes face the opposite direction of the return airflow.
12. Fully insert the sampling tube into the smoke detector housing.
13. Secure the smoke detector module to the mounting bracket using the provided self-tapping screws.
14. Connect wiring harness PL27 as shown in Fig. 1.

⚠ CAUTION

Do not overtighten the screws. May result in damage to smoke detector.

15. Verify the smoke detector, sampling tube, and all mounting brackets are properly secured.
16. Reinstall the side panels and/or side-mounted power exhaust assembly using the retained fasteners. See Fig. 3 for power exhaust assembly example.
17. Restore power to the unit.
18. Configure SmartVu controller as specified in the Controls, Start-Up, Operation, Service, and Troubleshooting Guide.
19. Perform standby, alarm, and sensitivity tests in “Standby, Alarm, and Sensitivity Tests” on page 11.

NOTE: At minimum, the magnet test should be performed to verify smoke detector wiring.
20. Check for alarms and verify proper operation. Correct any issues before placing the unit into service.

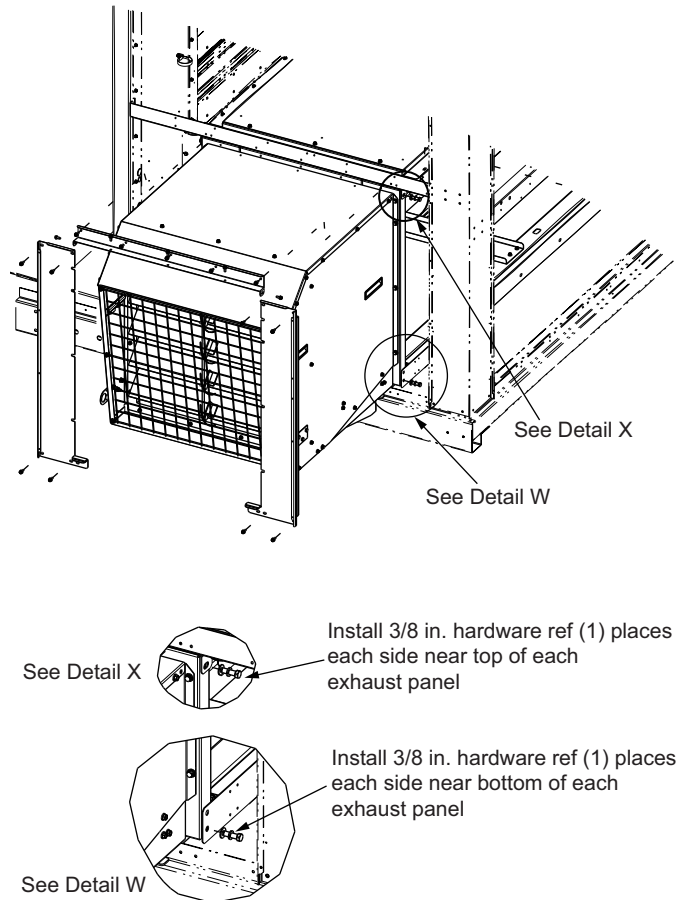

Fig. 3 — Power Exhaust Module (Side Access)

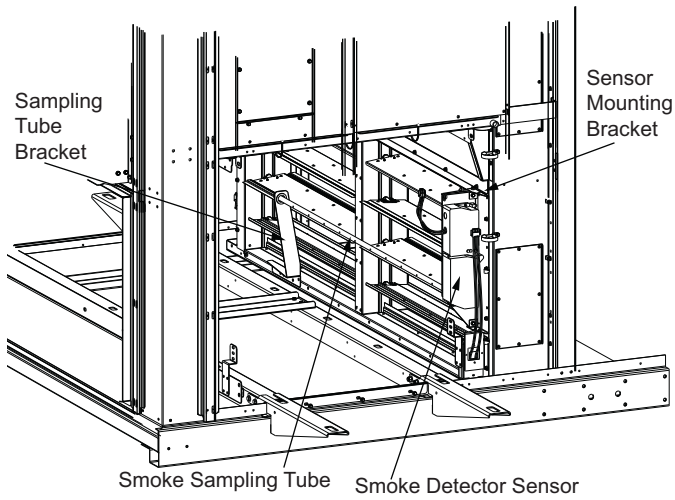

Fig. 4 – Return Air Smoke Detector Installed – Standard and Extended Chassis (Unit Sizes 28-98)

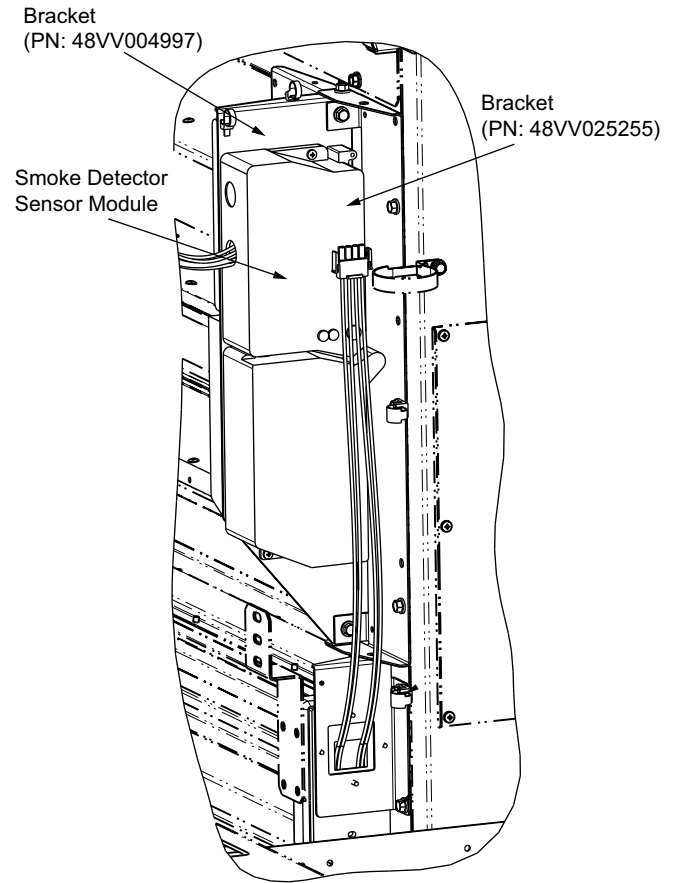

Fig. 6 – Sensor Module Installed on Bracket (Standard Chassis)

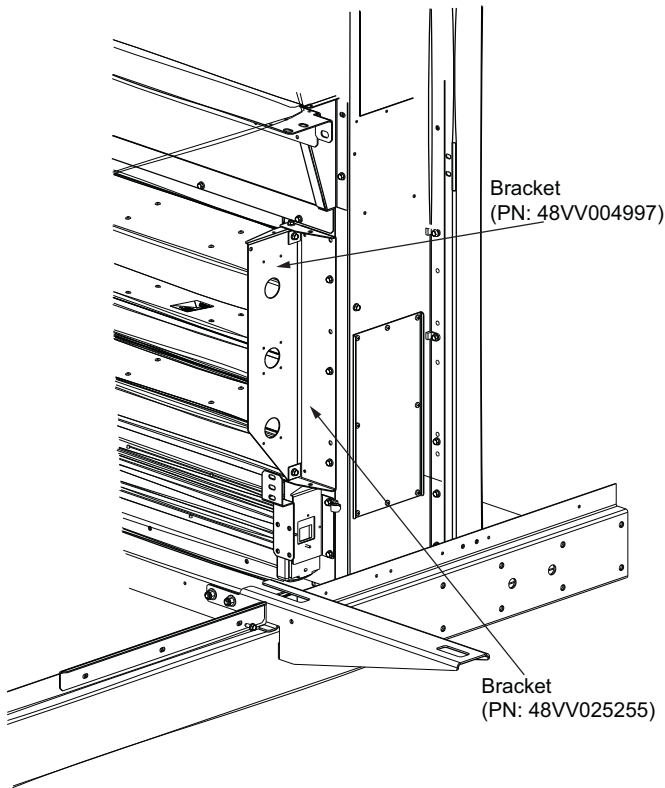
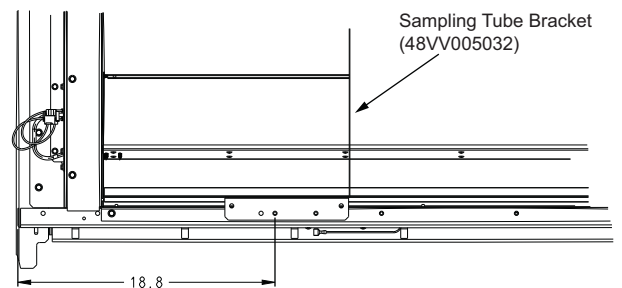

Fig. 5 – Smoke Detector Sensor Bracket (Compact Chassis with Vertical Return Shown)



NOTE: Dimensions are in inches.

Fig. 7 – Sampling Tube Holder Mounting Location

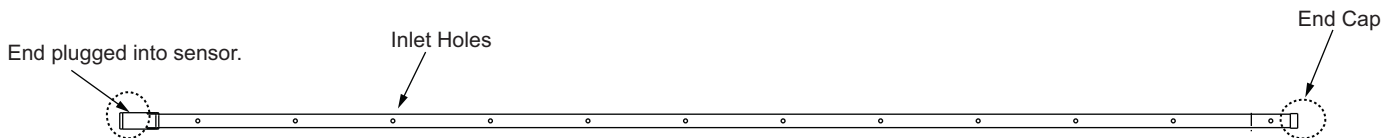

Fig. 8 – Sampling Tube Configuration

Supply Air Smoke Detector (Standard and Extended Standard Chassis)

The unit does not have provisions for field mounting a supply air smoke detector accessory. For applications where supply air smoke detection is required, smoke detector sensors shall be field-installed in the supply air duct. Installation must be performed in accordance with applicable codes, standards, and the smoke detector manufacturer's installation instructions.

NOTE: Secure mounting and proper sensor placement are the responsibility of the installing contractor.

Return Air Smoke Detector - CRSMKDET006A00 (Compact Chassis with Vertical Return)

See Fig. 9 for return air smoke detector mounting locations on compact chassis with vertical return units only. Follow Steps 1-19 for installation.

1. Determine the type of relief the unit is equipped with:
 - a. Units without relief option:
Remove the front lower access panels to provide front access to the return air section of the unit. Retain all screws for reinstallation. See Fig. 9 for smoke detector installation example.
 - b. Units with barometric relief or power exhaust:
Remove the screws securing the relief hood assembly and remove the barometric dampers or exhaust fan assembly to access the return air section of the unit. Retain all screws to reinstallation. See Fig. 10 for damper/exhaust fan and retaining screw locations.
2. To install the smoke detector bracket assembly, access to the economizer section is required through the filter access door. The access door is located on the right side of the unit when facing the outside air hood.
3. Locate and remove the sensor access cover on the economizer assembly to install the smoke detector sensor mounting brackets, as shown in Fig. 11.
4. Remove the smoke detector cover. The cover screws are captive and will remain attached to the cover. Refer to Fig. 2 for component locations.
5. Install the foam gaskets onto each sampling tube connection on the smoke detector. Refer to Fig. 2 for foam gasket locations.
6. Remove one conduit knockout from the smoke detector housing.
7. Route the stripped wire harness leads through the conduit opening and terminate wiring at the smoke detector terminals as shown in Fig. 1.
8. Insert the smoke detector sensor assembly into the openings in the mounting bracket referenced in Fig. 9 and 11.
NOTE: Do not secure the smoke detector at this time.

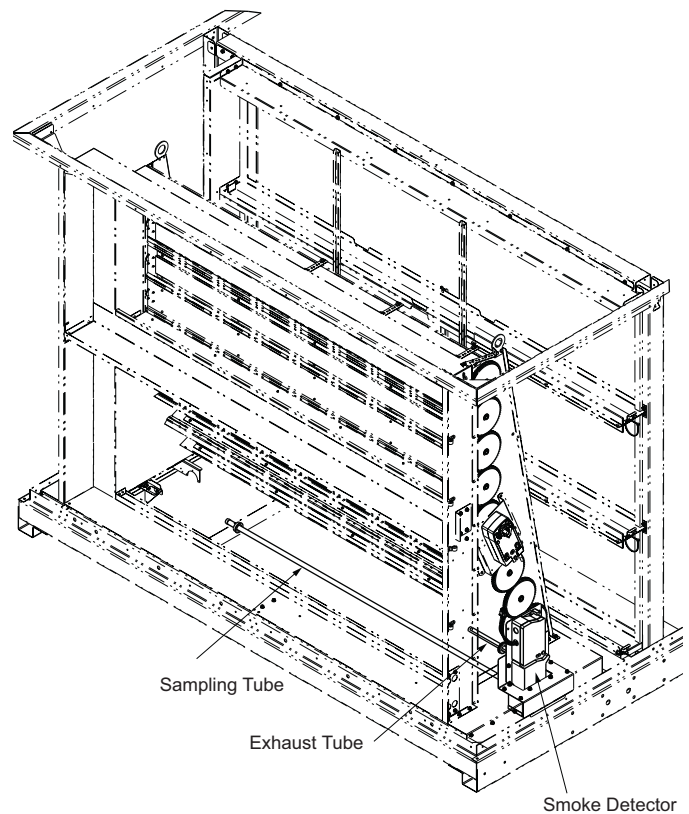

Fig. 9 — Smoke Detector Installed (Compact Chassis with Vertical Return Shown)

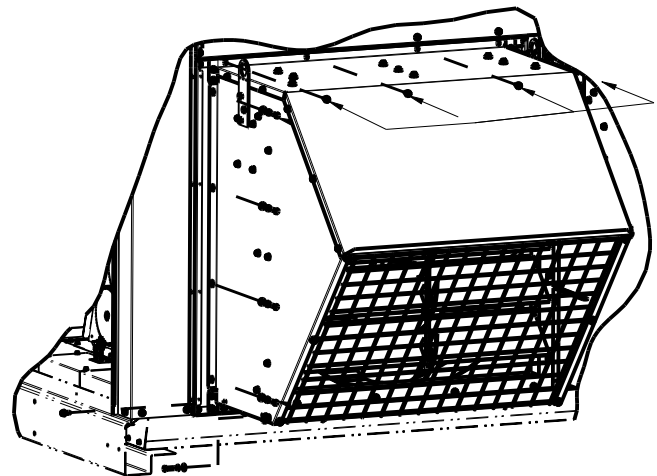

Fig. 10 — Remove Barometric or Exhaust Hood Panel for Access

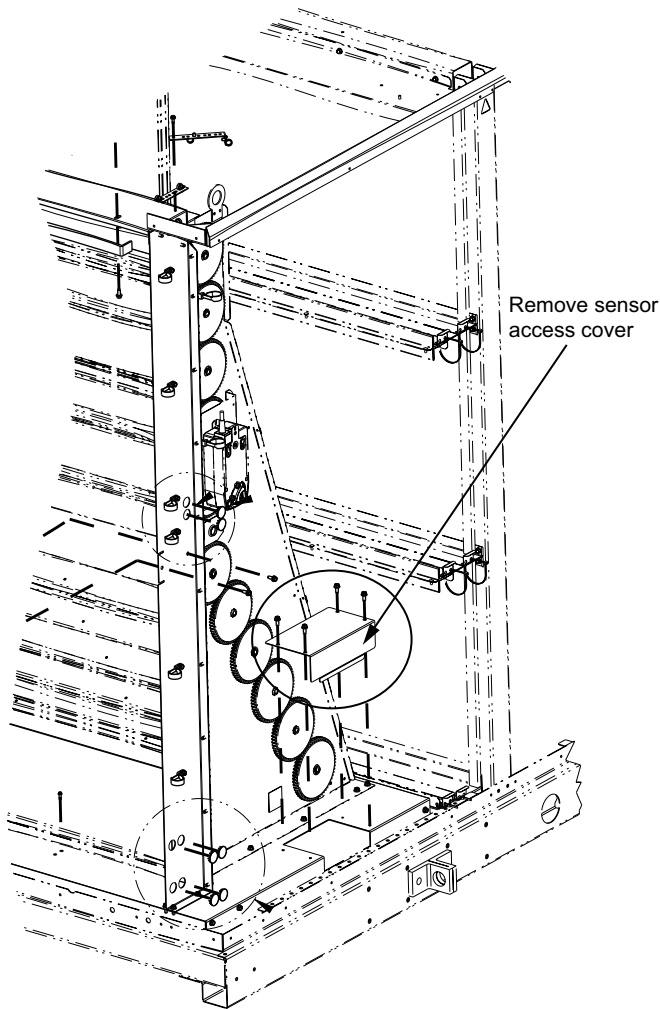

Fig. 11 — Remove Access Cover to Install Smoke Detector

9. Install the end plug onto the sampling tube as shown in Fig. 8. Insert the sampling tube into the sampling tube bracket, then install the tube into the lower port of the smoke detector sensor module, where it interfaces with the photo detector board as shown in Fig. 2.
10. Ensure sampling holes face the opposite direction of return airflow.
11. Remove the end cap from the exhaust tube supplied with the accessory. Cover the exhaust tube holes with foil tape as required. Insert the exhaust tube into the smoke detector sensor module to allow airflow through the sensor as shown in Fig. 12.
12. Secure the smoke detector to the mounting bracket using the provided self-tapping screws. See Fig. 12 for assembly.
13. Connect wiring harness PL27 as shown in Fig. 1.
14. Verify that the smoke detector, sampling tube, and all mounting brackets are properly secured.
15. Reinstall the side panels and/or side-mounted power exhaust assembly using the retained fasteners.
16. Restore power to the unit.
17. Configure SmartVu controller as specified in the Controls, Start-Up, Operation, Service, and Troubleshooting Guide.
18. Perform standby, alarm, and sensitivity tests in “Standby, Alarm, and Sensitivity Tests” on page 11.
NOTE: At minimum, the magnet test should be performed to verify smoke detector wiring.
19. Check for alarms and verify proper operation. Correct any issues before placing the unit into service.

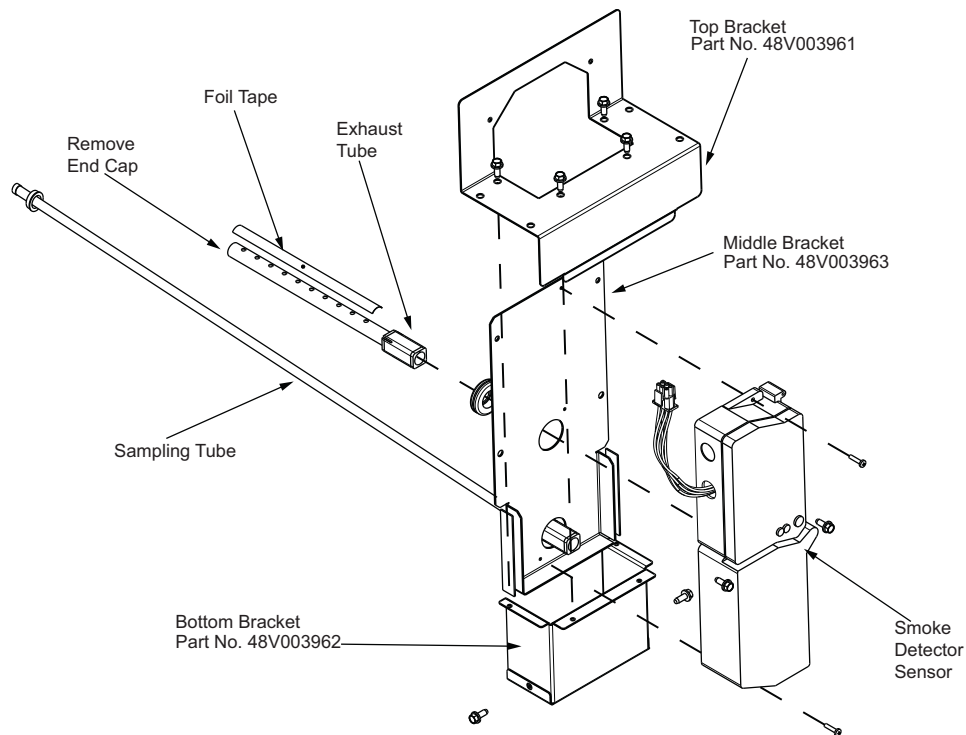

Fig. 12 — Smoke Detector Bracket Assembly (Compact Chassis with Vertical Return)

Return Air Smoke Detector - CRSMKDET007A00 (Compact Chassis with Horizontal Return)

See Fig. 13 for return air smoke detector mounting locations on compact chassis with horizontal return units only. Follow Steps 1-19 for installation.

1. Determine the type of relief in the unit:
For compact chassis units with a horizontal return, the smoke detector accessory can be field-installed in the return air opening section without removal of any factory relief option. See Fig. 13 for smoke detector installation example.
2. Install the smoke detector in the return air opening before connecting the return air duct. Mount the accessory from the left side of the unit when facing the outside air hood to allow proper access.
3. Identify the mounting location and install the mounting bracket assembly in the return air opening. See Fig. 14 for mounting bracket example.
NOTE: The measurements shown are from the post location where the bracket will be installed.
4. Remove the smoke detector cover. The cover screws are captive and will remain attached to the cover. Refer to Fig. 2 for component locations.
5. Install the foam gaskets onto each sampling tube connection on the smoke detector. Refer to Fig. 2 for foam gasket locations.
6. Remove one conduit knockout from the smoke detector housing.
7. Route the stripped wire harness leads through the conduit opening and terminate wiring at the smoke detector terminals as shown in Fig. 1.
8. Insert the smoke detector sensor assembly into the openings in the mounting bracket referenced in Fig. 15.
NOTE: Do not secure the smoke detector at this time.
9. Install the end plug onto the sampling tube as shown in Fig. 8. Insert the sampling tube into the sampling tube bracket, then install the tube into the lower port of the smoke detector sensor module, where it interfaces with the photo detector board as shown in Fig. 2.
10. Ensure sampling holes face opposite the direction of return airflow.
11. Remove the end cap from the exhaust tube supplied with the accessory. Cover the exhaust tube holes with foil tape as required. Insert the exhaust tube into the smoke detector sensor module to allow airflow through the sensor. See Fig. 15 for end cap location and bracket assembly.
12. Secure the smoke detector to the mounting bracket using the provided self-tapping screws. See Fig. 14 for assembly.
13. Connect wiring harness PL27 as shown in Fig. 1.
14. Verify that the smoke detector, sampling tube, and all mounting brackets are properly secured.

15. After the smoke detector assembly is installed, connect the return air duct to the return air opening of the unit.
16. Restore power to the unit.
17. Configure SmartVu controller as specified in the Controls, Start-Up, Operation, Service, and Troubleshooting Guide.
18. Perform standby, alarm, and sensitivity tests in “Standby, Alarm, and Sensitivity Tests” on page 11.
NOTE: At minimum, the magnet test should be performed to verify smoke detector wiring.
19. Check for alarms and verify proper operation. Correct any issues before placing the unit into service.

Supply Air Smoke Detector (Compact Chassis)

The unit does not have provisions for field mounting a supply air smoke detector accessory. For applications where supply air smoke detection is required, smoke detector sensors shall be field-installed in the supply air duct. Installation must be performed in accordance with applicable codes, standards, and the smoke detector manufacturer’s installation instructions.

NOTE: Secure mounting and proper sensor placement are the responsibility of the installing contractor.

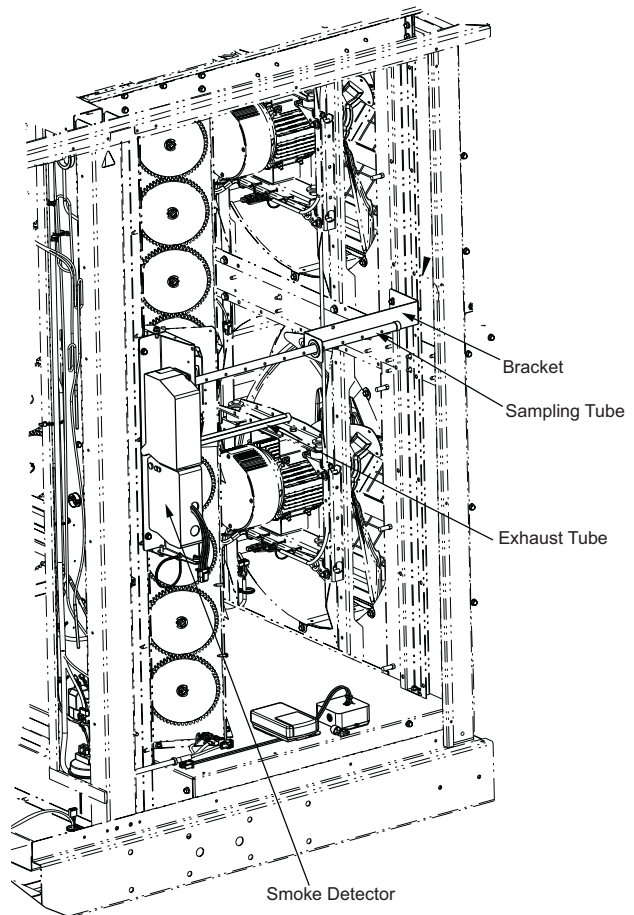

Fig. 13 — Smoke Detector Installed (Compact Chassis with Horizontal Return)

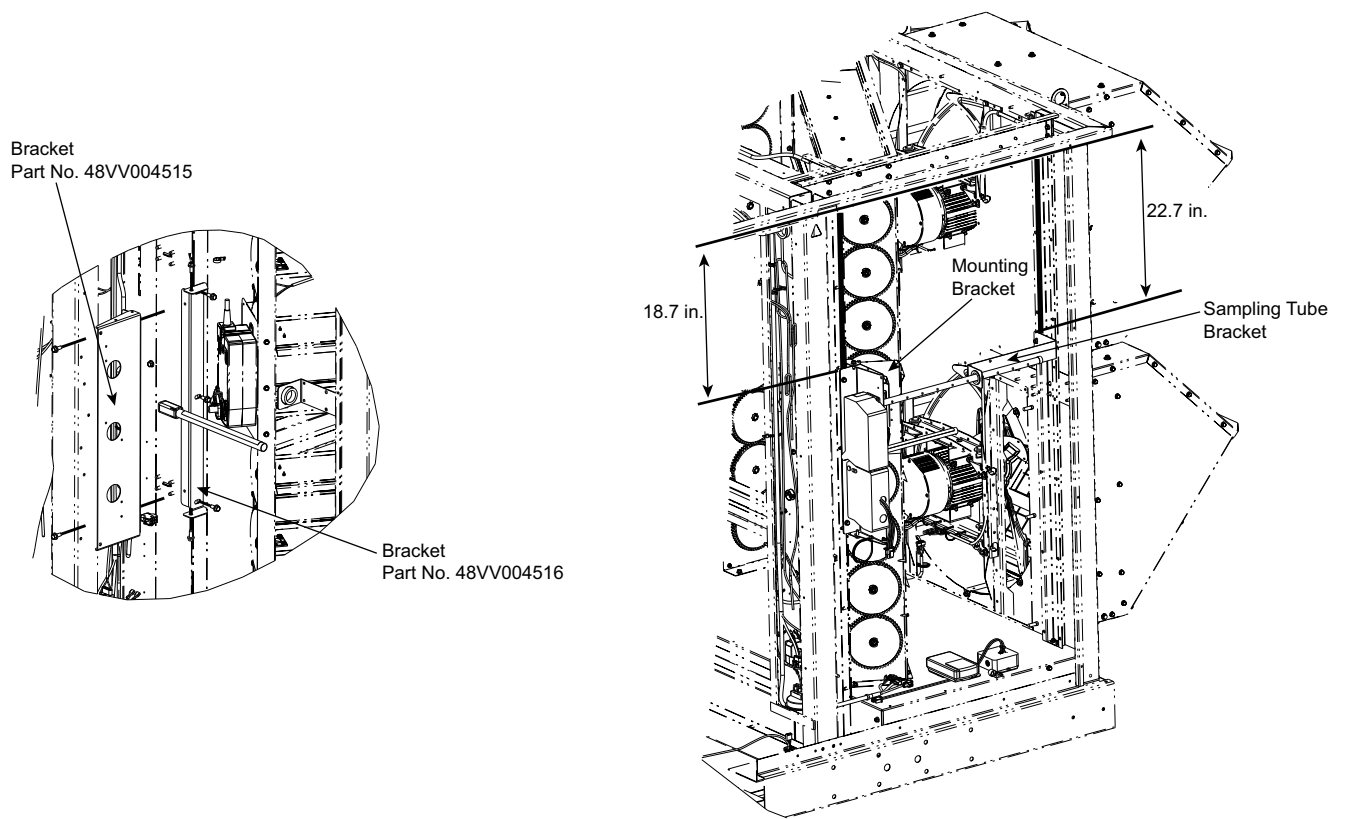

Fig. 14 — Installing Sensor and Sampling Tube Mounting Bracket (27-50 Ton Units Shown)

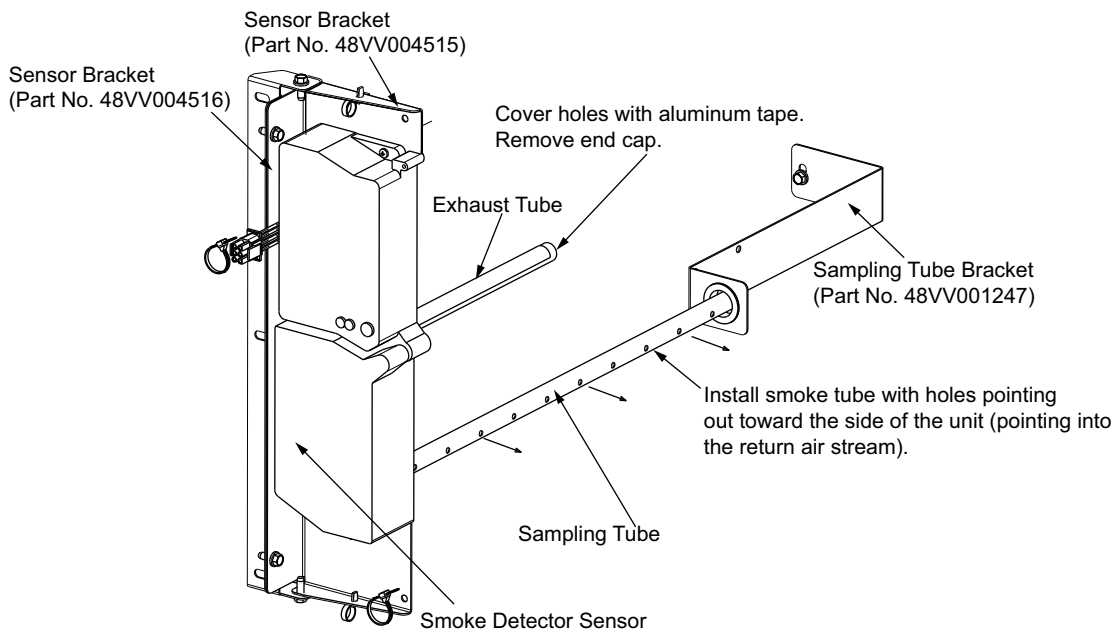

Fig. 15 — Smoke Detector Bracket Assembly (Compact Chassis with Horizontal Return)

OPERATION

⚠ CAUTION

The smoke detector must be tested and maintained regularly following NFPA 72 requirements. The smoke detector should be cleaned at least once a year. Damage to equipment may result.

The smoke detector accessories contain a photoelectric detector approved for an extended air speed range of **100 to 4000 feet per minute** (0.5 to 20.3 m/s) and an operational temperature range of 32°F to 131°F (0°C to 55°C).

NOTE: Do not operate the smoke detector outside of these ranges.

The smoke detector operates on 24/120/240 vac. The thermostat power terminals on the unit are used to power the smoke detector. Alarm and supervisory relay contacts are available for control panel interface (alarm initiation), HVAC control, and other auxiliary functions. Auxiliary relays are also provided for fan shut down or signaling of up to 9 other detectors in the loop for multiple fan shut down.

NOTE: The smoke detector is not designed for 2-wire applications.

The smoke detector can be reset by a momentary power interruption, by the reset button on the front cover, the control panel, or by the remote reset accessory.

IMPORTANT: The smoke detector incorporates a cover tamper feature that provides a trouble signal after 20 minutes if the cover is removed or improperly installed. Proper installation of the cover removes the trouble condition.

Configuring the SmartVu Controller

For configuration settings refer to the Controls Set Up section in the Unit Installation and Start-up Instructions for 48/50V unit sizes 28-98.

MAINTENANCE

Cleaning Procedure

Notify the proper authorities that the smoke detector system is undergoing maintenance, and that the system will temporarily be out of service. Disable the zone or system undergoing maintenance to prevent unwanted alarms and possible dispatch of the fire department.

AIR FILTERS

1. Turn off power to the system.
2. Remove and inspect sampling tube filters.
3. If filters are heavily coated with dirt, replace them with new filters. If they are not heavily coated, use a vacuum cleaner or compressed air nozzle to remove dust, then reinstall the filters.

PHOTO DETECTOR BOARD

1. Remove the screen by gently grasping on each side and pulling straight off.
2. Lift the photo chamber in the same fashion. Vacuum the screen and cover. Use clean, compressed air to loosen and blow out any remaining debris.
3. Vacuum photo chamber, then use clean compressed air to blow area clean.
4. Replace the chamber by pressing it onto the base. Then press the screen into place. It should fit tightly on the chamber.

Filter Replacement

The filters do not substantially affect smoke detector performance even when up to 90% of the filter is clogged. Quarterly visual inspection usually suffices to determine whether the filters should be replaced. Only a high percentage of contamination affects performance. If further testing is required, compare differential pressure readings with and without the filters installed. If the difference exceeds 10%, then replace the filters. The pressure differential should never fall below 0.0015 in. wg.

Board Replacement

SMOKE DETECTOR BOARD REPLACEMENT

1. Remove the two detector board mounting screws.
2. Pull gently on the board to remove it.
3. To replace the board, align the board mounting features, holes, and the interconnect terminals. Push the board into place.
4. Secure board with the two mounting screws.

POWER BOARD REPLACEMENT

1. Disconnect wiring from the terminal block.
2. Remove the two power board mounting screws.
3. Pull gently on the board to remove it.
4. To replace the board, align the board mounting features, holes, and the interconnect terminals. Push the board into place.
5. Secure board with the two mounting screws.
6. Reconnect wiring to terminal block.

TROUBLESHOOTING

Test and maintain unit smoke detectors as recommended in NFPA 72. Before conducting tests or maintenance, notify the proper authorities that the smoke detection system will be temporarily out of service. Disable the system under test to prevent unwanted alarms.

Smoke Entry Tests

AIRFLOW TEST

The smoke detector is designed to operate over an extended air speed range of 100 to 4000 fpm. To verify sufficient sampling of unit air, turn on the unit indoor fan using the Service Test function (see Controls, Start-Up, Operation, Service, and Troubleshooting Guide for details on Service Test) and use a manometer to measure the differential pressure between the two sampling tubes.

The differential pressure should measure at least 0.0015 in. wg and no more than 1.2 in. wg. Because most commercially available manometers cannot accurately measure very low pressure differentials, applications with less than 500 fpm of unit air speed may require the use of a current-sensing pressure transmitter or the use of aerosol smoke (see Smoke Response Test section).

SMOKE RESPONSE TEST

Drill a 1/4 in. hole 3 ft upstream from the unit smoke detector. Use the Service Test function (see Controls, Start-Up, Operation, Service, and Troubleshooting Guide for details on Service Test) to turn on the unit indoor fan. Measure the air velocity with an anemometer. Air speed must be at least 100 fpm. If the air speed is greater than 500 fpm, use a conventional manometer to measure differential pressure between the sampling tubes.

Spray aerosol smoke into the unit through the 1/4 in. hole for 5 seconds. Wait two minutes for the unit smoke detector to alarm. If the unit smoke detector alarms, then air is flowing through the detector. Remove the unit smoke detector cover and blow out the residual aerosol smoke from the chamber and reset the unit smoke detector. Use duct tape to seal the aerosol smoke entry hole.

To determine if smoke is capable of entering the sensing chamber, visually identify any obstructions. Plug the exhaust and inlet tube holes to prevent unit air from carrying smoke away from the detector head, then blow smoke directly at the head to cause an alarm.

⚠ CAUTION

Remove the plugs after this test, or the smoke detector will not function properly and damage may result.

Standby, Alarm, and Sensitivity Tests

The cover of the smoke detector must be removed to perform these tests.

STANDBY AND TROUBLE TEST

- **Standby:** Look for presence of flashing green LED. The LED should flash approximately every 10 seconds.
- **Trouble:** If the detector LED does not flash, then the detector lacks power, the detector board is missing (replace), the cover has been missing or not secured properly for more than 20 minutes (secure cover properly), or the unit is defective (return for repair).
- **Test:** The trouble condition can be caused intentionally to verify correct operation of the system. Remove the detector board to cause an alarm.
- **Cover Tamper:** If the cover is removed or not properly secured for a period longer than 20 minutes, a trouble signal is generated to indicate the cover is missing.

ALARM TEST

Magnet Test

1. Place the painted surface of the magnet onto the TEST locator on the bottom of the housing.
2. The red alarm LED on the detector should switch on. Verify system control panel alarm status and control panel execution of all intended auxiliary functions (i.e., fan shutdown, damper control, etc.).
3. The detector must be reset by the front cover reset button.

SENSITIVITY TEST

After verification of alarm capability, use a field-supplied voltmeter to check detector sensitivity. The housing cover must be removed to perform this test. If readings indicate that the detector head is outside of the acceptable range that is printed on the label of the detector, the detector chamber requires cleaning.

