



Horizontal Roof Curb Adapter Accessory 48/50GC 04-06, 48/50HC 07-14 Single Package Rooftop Units with EnergyX® Energy Recovery Ventilator (ERV)

Installation Instructions

Part No. CRADCURB007A00, CRADCURB008A00, CRADCURB009A00

SAFETY CONSIDERATIONS

Installation of this accessory can be hazardous due to system pressures, electrical components, and equipment location (such as a roof or elevated structure). Only trained, qualified installers and service technicians should install, start-up, and service this equipment.

When installing this accessory, observe precautions in the literature, labels attached to the equipment, and any other safety precautions that apply:

- Follow all safety codes
- Wear safety glasses and work gloves
- Use care in handling and installing this accessory

It is important to recognize safety information. This is the safety-alert symbol: . When you see this symbol on the unit and in instructions or manuals, be alert to the potential for personal injury.

Understand the signal words DANGER, WARNING, CAUTION, and NOTE. These words are used with the safety-alert symbol. DANGER identifies the most serious hazards which **will** result in severe personal injury or death. WARNING signifies hazards which **could** result in personal injury or death. CAUTION is used to identify unsafe practices, which **may** result in minor personal injury or product and property damage. NOTE is used to highlight suggestions which **will** result in enhanced installation, reliability, or operation.

INSTALLATION

WARNING

EQUIPMENT DAMAGE HAZARD

Failure to follow this warning could result in personal injury and damage to equipment.

To prevent injuries and rain damage, do not leave roof opening uncovered. If unit installation is not completed immediately after adapter curb is installed, provide an adequate temporary cover for the roof opening.

Follow all local, state, and other applicable codes when installing the accessory roof curb adapters. See Table 1 for package usage and Table 2 for package contents. See Fig. 1 for initial securing of the adapter.

Table 1 — Package Usage

| MODEL | PART NUMBER | SIZE |
|---------|----------------|-------|
| 48/50GC | CRADCURB007A00 | 04-06 |
| 48/50HC | CRADCURB008A00 | 07-12 |
| 48/50HC | CRADCURB009A00 | 14 |

Table 2 — Package Contents

| DESCRIPTION | QTY |
|------------------------------|-----|
| Fully Assembled Curb Adapter | 1 |
| Gasket | 1 |
| Bag of Screws | 1 |

FEATURES

- Fully assembled curb adapter.
- Includes internal duct transitions.
- Internally insulated with 1 in. to 1-1/2 in. insulation. Gasketing package provided.
- Adapter pans and supports provided (will need to be field-installed).

CURB ADAPTER INFORMATION

Before assembly verify that the curb adapter shown in Fig. 2-4 is the correct adapter. Check curb adaptor dimensions with the dimensions provided. (The bottom dimensions of the curb adapter are larger than existing curb outside dimensions.)

Before the new HVAC unit is set in place, inspect structural stability of existing curb and building's roof load capability. Reinforce if required.

All curb adapters will increase the system's external static pressure and must be included when calculating unit requirements. Curb adapters are designed to attach to an existing curb with side by side duct connections. The curb adapter is not designed for use with concentric duct configuration.

For calculated product, please contact factory for part number, pricing and lead time.

Contact the factory for more detailed dimensional information, if required. Designs are based on standard factory dimensions and may differ in the field.

Step 1 — Locate the Horizontal Curb Adapter

There are many things to consider when locating the Horizontal Curb Adapter/ERV unit, including:

1. Structural support required from roof system.
2. Duct drop location in relation to joists.
3. Serviceability of the ERV unit.
4. Clearances required on the ERV unit.
5. Locations of vents or other sources of contaminated air which could negatively affect the quality of the outside air entering the ERV unit.

Step 2 — Apply Gasket

Apply the supplied gasket to the entire upper perimeter of your roof curb and around the supply and return openings where the curb adapter and roof curb meet. Gasket strips must fit tightly together, leaving no gaps for leakage.

IMPORTANT: Gasketing is critical for water integrity. Improperly installed gasketing can result in air leaks and poor unit performance.

Step 3 — Align the Horizontal Adapter Curb

Align the proper airflow paths in the curb adapter to those in your roof curb. Lower the curb adapter slowly into place, making sure the gasket is not damaged.

NOTE: If any gasket is damaged, it must be replaced to ensure a proper seal.

Step 4 — Secure the Adapter Curb

Once the adapter curb has been safely lowered into place, the two pieces need to be secured together. Using the provided screws, insert a screw every 24 inches from the side, as shown in Fig. 1.

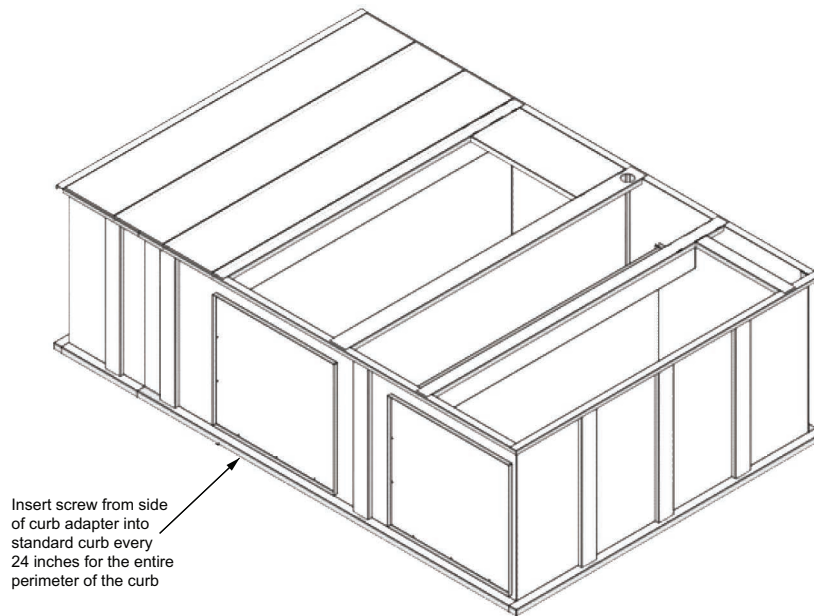
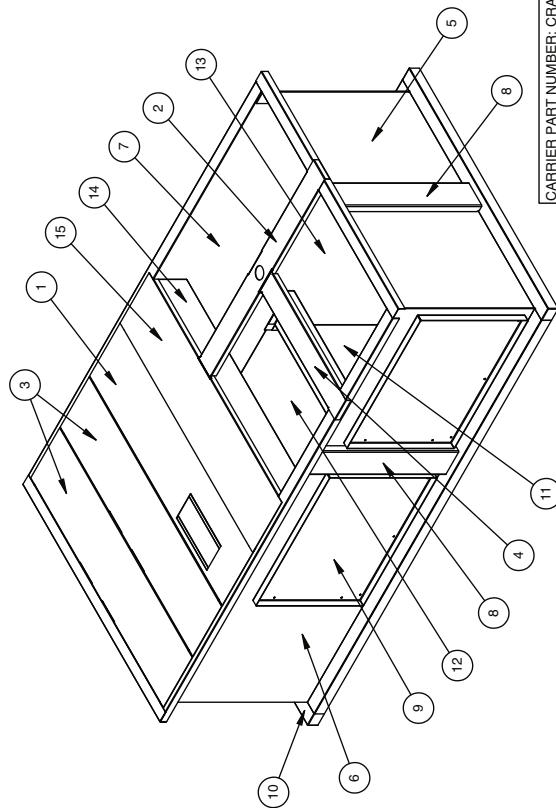
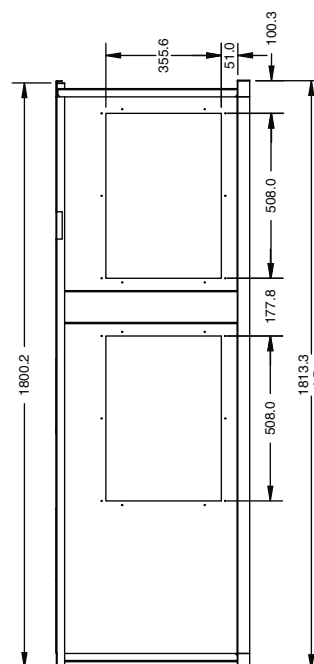
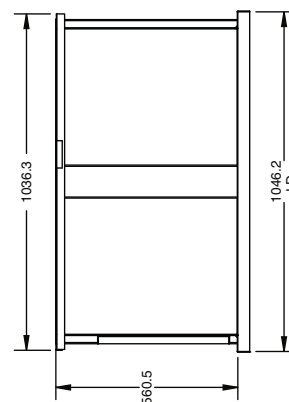
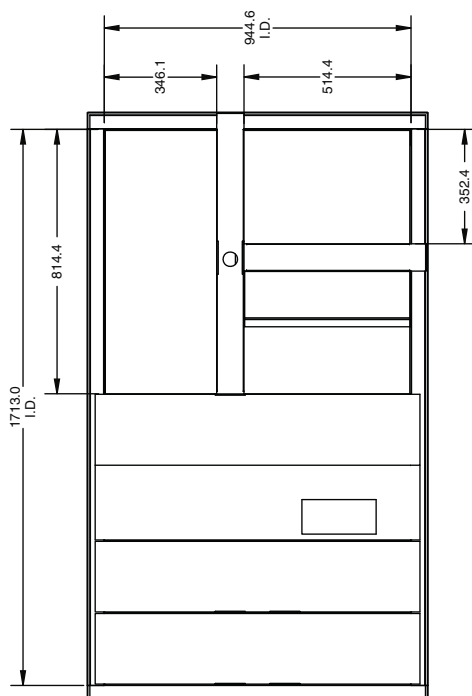

Fig. 1 — Securing the Adapter Curb



| CARRIER PART NUMBER: CRADCURB007A00 | | | |
|---|--------------|------------------|------|
| MICROMETL PART NUMBER: HJ36-W-HCRB | | | |
| INSTALL INSTRUCTION # IIK-CRADCURB07-01 | | | |
| ITEM NO. | MMC PART NO. | DESCRIPTION | QTY. |
| 1 | 0537043D | DECK PAN-B | 1 |
| 2 | 0537052E | R/A DUCT SUPPORT | 1 |
| 3 | 0537053B | DECK PAN-A | 2 |
| 4 | 0537054B | S/A DUCT SUPPORT | 1 |
| 5 | CRBHJ0020 | FRONT PANEL | 1 |
| 6 | CRBHJ0021 | SIDE A | 1 |
| 7 | CRBHJ0022 | SIDE B | 1 |
| 8 | CRBHJ0023 | VERTICAL SUPPORT | 6 |
| 9 | CRBHJ0025 | COVERS | 2 |
| 10 | CRBHJ0027 | BACK PANEL | 1 |
| 11 | CRBHJ0028 | SUPPLY SHROUD A | 1 |
| 12 | CRBHJ0029 | FLOOR | 1 |
| 13 | CRBHJ0030 | SUPPLY SHROUD B | 1 |
| 14 | CRBHJ0031 | RETURN SHROUD A | 1 |
| 15 | CRBHJ0033 | DECK PAN-C | 1 |

| | | |
|------|----------------|-----|
| SIZE | DRAWING NUMBER | REV |
| D | 48TM404345 | A |



- NOTES:
- SHIPS FULLY WELDED
 - INSULATED DECK PANS
 - INCLUDE 25 L/F OF 1-1/2 X 1/4" GASKETING (9430-0100)
 - WILL SIT ON STANDARD CURB

Fig. 2 — CRADCURB007A00 Horizontal Curb Adapter Assembly

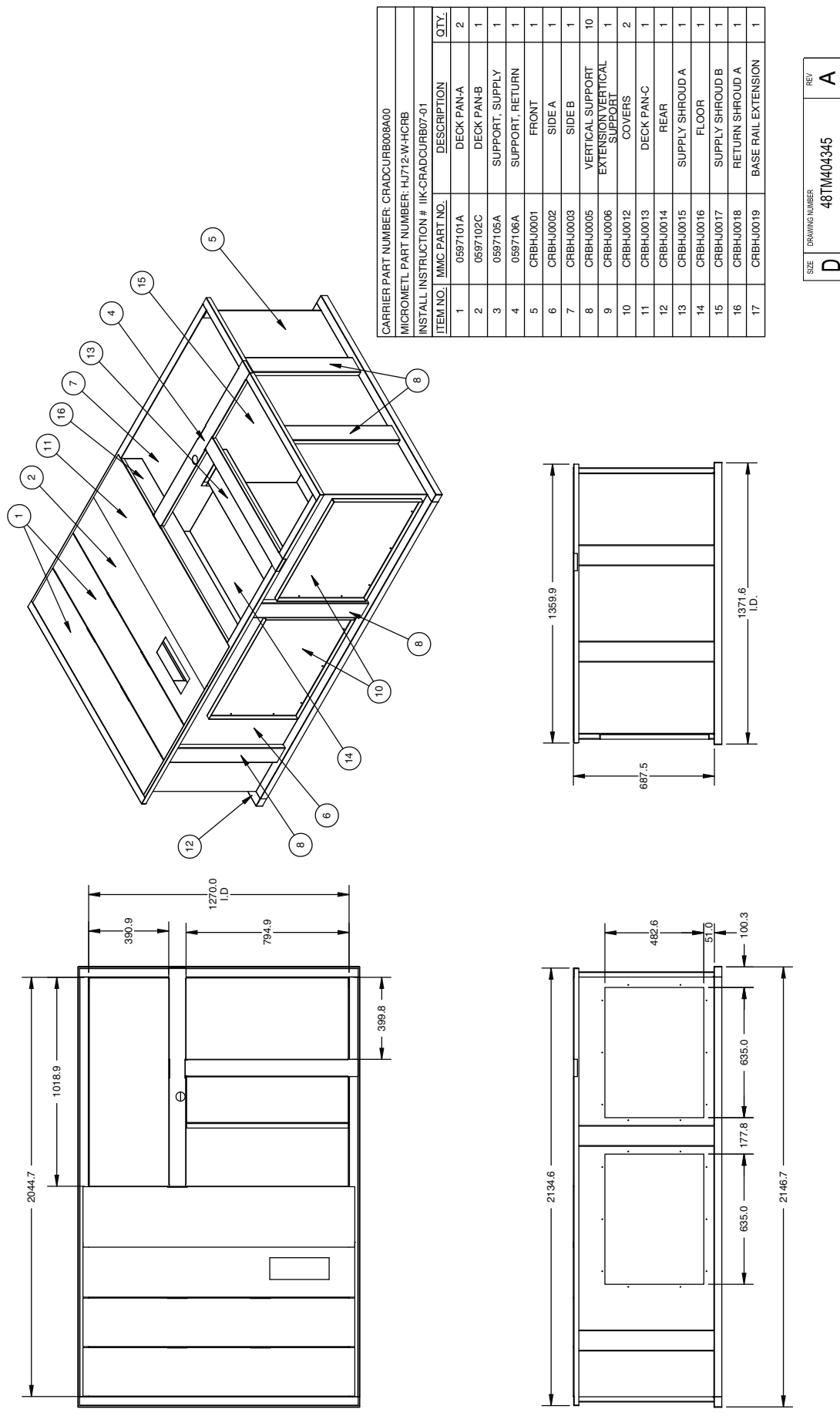

NOTES:
 1. SHIPS FULLY WELDED
 2. INSULATED DECK PANS
 3. INCLUDES 1/2" X 1/4" GASKETING (9430-0100)
 4. WILL SIT ON STANDARD CURB

Fig. 3 — CRADCURB008A00 Horizontal Curb Adapter Assembly

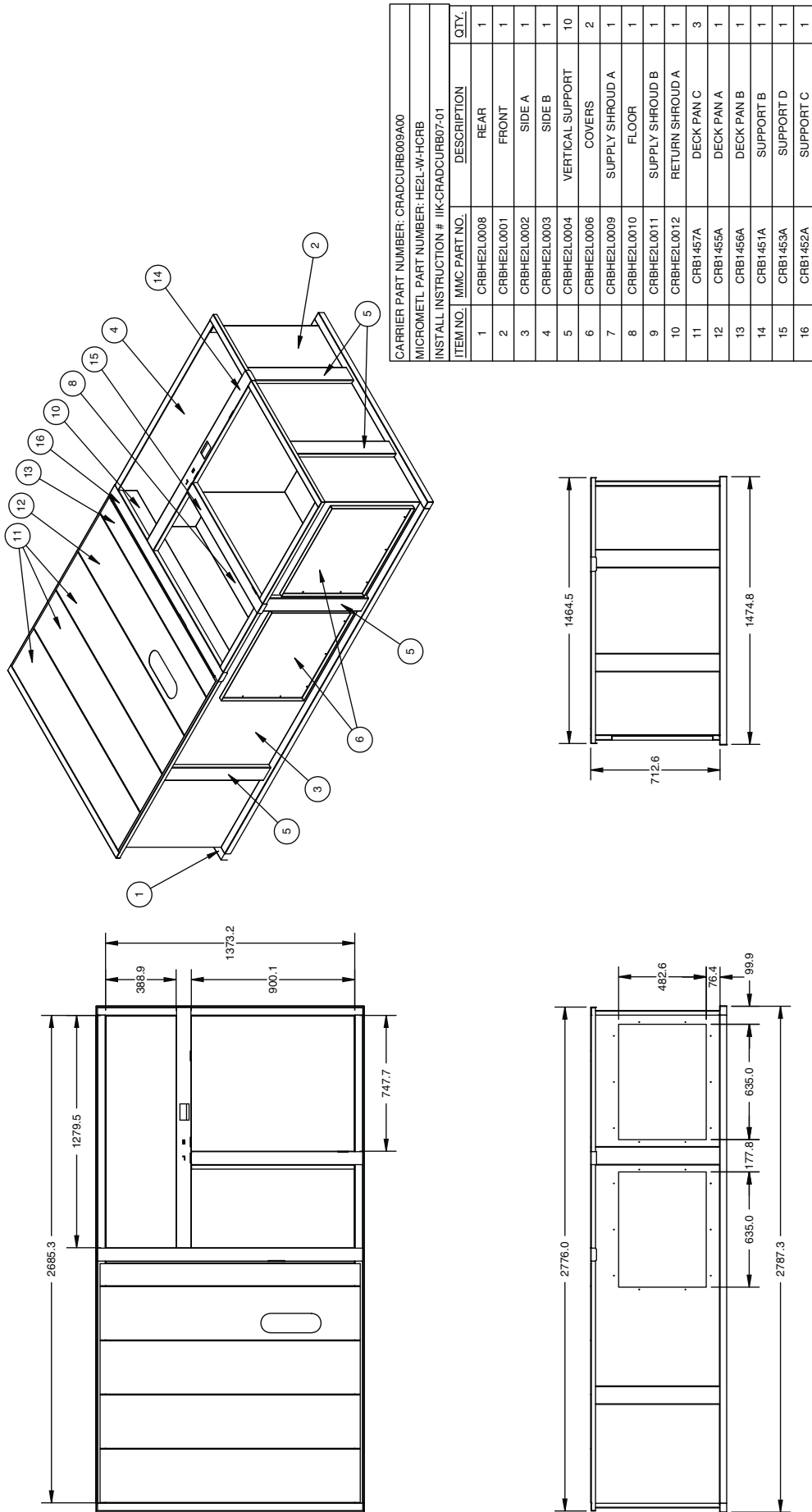

| | | | | | |
|------|---|----------------|------------|-----|---|
| SIZE | D | DRAWING NUMBER | 48TM404345 | REV | A |
|------|---|----------------|------------|-----|---|

Fig. 4 — CRADCURB009A00 Horizontal Curb Adapter Assembly

