

# Inducer Motor Mount Replacement Kit

Cancels: New

IHK 373L-35-16  
12-15-93

## Installation Instructions Part No. 318858-752

**NOTE:** Read the entire instruction manual before starting the installation.

### SAFETY CONSIDERATIONS

Installing and servicing heating equipment can be hazardous due to gas and electrical components. Only trained personnel should install or service heating equipment.

Untrained personnel can perform basic maintenance functions such as cleaning coils or cleaning and replacing filters. All other operations should be performed by trained service personnel. When working on heating equipment, observe precautions in the literature, on tags, and on labels attached to the unit.

Follow all safety codes. Wear safety glasses and work gloves. Have a fire extinguisher available.

### INTRODUCTION

This instruction covers the installation of the inducer motor mount replacement kit Part No. 318858-752 in all mid-efficiency, induced-draft furnaces in 40-in. cabinets.

### DESCRIPTION AND USAGE

The inducer motor mount replacement kit is used to repair or upgrade inducer motor mounting hardware.

The inducer motor mount replacement kit contains the following items:

Shaft Seal	1
Motor Support	1
Motor Plate	1
Screw	3
Grommet	3
Support Gasket	1
Installation Instructions	1

If all gaskets must be replaced, use gasket kit Part No. 320887-751.

### INSTALLATION

#### Step 1—Remove Inducer Motor Assembly

1. Turn off gas and electrical supplies to unit.
2. Remove blower and control access doors.
3. Unplug inducer motor.
4. Remove and keep 3 assembly mounting screws and remove inducer motor assembly (motor, wheel, and mount) from inducer housing. Be careful not to damage inducer wheel during removal.

#### ⚠ CAUTION

Carefully measure location of wheel to motor support for correct position when reassembling. Loosen inducer wheel setscrew using an allen wrench, and remove wheel from motor shaft. (See Fig. 1.)

**NOTE:** If wheel is difficult to remove, lightly sand any scale or rust buildup from end of motor shaft. Apply a small amount of penetrating oil to shaft and hub. Tap lightly on hub only. DO NOT tap or pry on any other areas of wheel.

5. Remove 3 grommet screws.

#### ⚠ CAUTION

Two pairs of mounting holes are provided on motor plate. Usage varies depending on application. If old motor plate also has 2 pairs of motor mounting holes, carefully note which 2 are used and use same 2 holes on new motor plate during reassembly.

6. Remove 2 screws securing motor to motor plate.

#### Step 2—Reassemble Inducer

1. Install 3 new grommets (provided in kit) on new motor plate. See Fig. 2 for correct orientation of grommets.

**NOTE:** If the grommets are installed incorrectly, vibration in the assembly could result.

2. Fasten new motor plate to motor using original screws. When installed correctly, rotation arrow stamped into motor plate should be on same side as motor. If a shaft seal is used, install new shaft seal provided in kit on motor plate and center on motor shaft.
3. Fasten motor plate to motor support through grommets using 3 new grommet screws provided in kit.
4. Reinstall inducer wheel. The wheel must be located using measurement taken during disassembly. Adjust flat on shaft to line up with setscrew and tighten setscrew firmly.
5. Inspect 3 hole mounting pattern on inducer housing. If it is not the same as the hole pattern on the new motor support, 3 new mounting holes must be drilled in inducer housing. If patterns are the same, skip item 6 and go to item 7. If new holes must be drilled, refer to item 6.
6. Fig. 3 of this instruction is a template to be used to correctly locate 3 new mounting holes on the inducer housing for the new motor support.
  - a. Cut template from page and align it on inducer housing. To aid in alignment, a small notch is shown on the outside edge of the template.
  - b. Rotate template until notch is positioned at top. The 3 slotted holes shown on the template should now align with the hole pattern on the inducer housing.
  - c. Start 3 mounting screws through the paper template and screw template onto inducer housing.
  - d. Select No. 32 or smaller drill bit and drill 3 new holes as shown on template.
  - e. After new holes are drilled, remove 3 screws holding the template on housing and discard template.
7. Discard old gasket and align new gasket holes with corresponding holes on inducer housing. If necessary, use a small

Manufacturer reserves the right to discontinue, or change at any time, specifications or designs without notice and without incurring obligations.

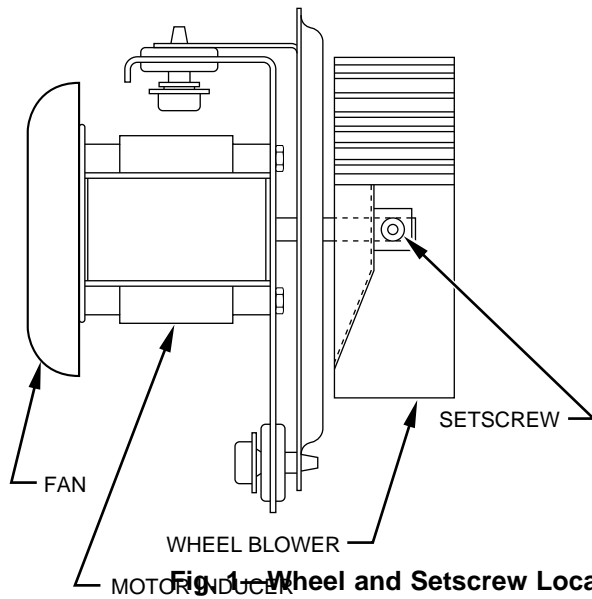

**Fig. 1—Wheel and Setscrew Location**

A91210

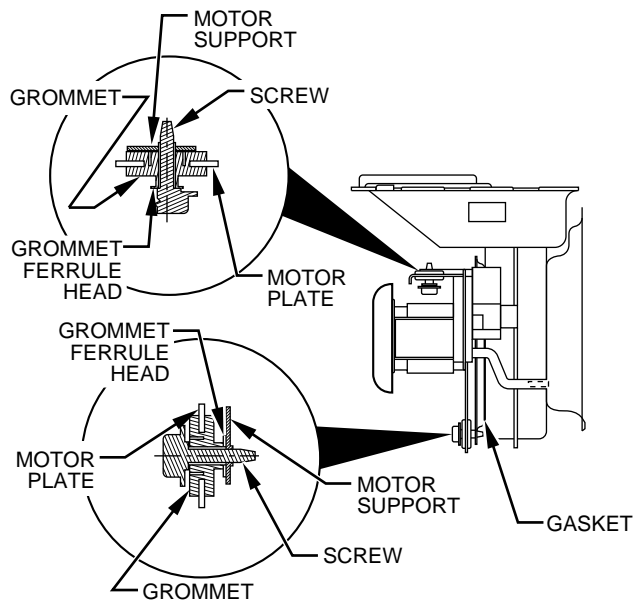

**Fig. 2—Proper Grommet Position**

A91211

amount of RTV to adhere gasket to housing to aid in reassembly.

8. Install inducer motor assembly in inducer housing and fasten with 3 original mounting screws. Make certain the inducer motor ground wire is reinstalled under 1 of the mounting screws.

**NOTE:** The 3 original mounting screws are shorter in length than the other screws. Use of longer screws will result in interference between the screws and the inducer wheel.

9. Spin black plastic cooling fan on inducer motor to be certain there is no interference inside of inducer housing. If interference occurs, wheel must be readjusted.
10. Plug inducer motor back into furnace wiring harness.
11. Turn on gas and electrical supplies to furnace.
12. Operate furnace through 1 complete heating cycle to check for proper operation.

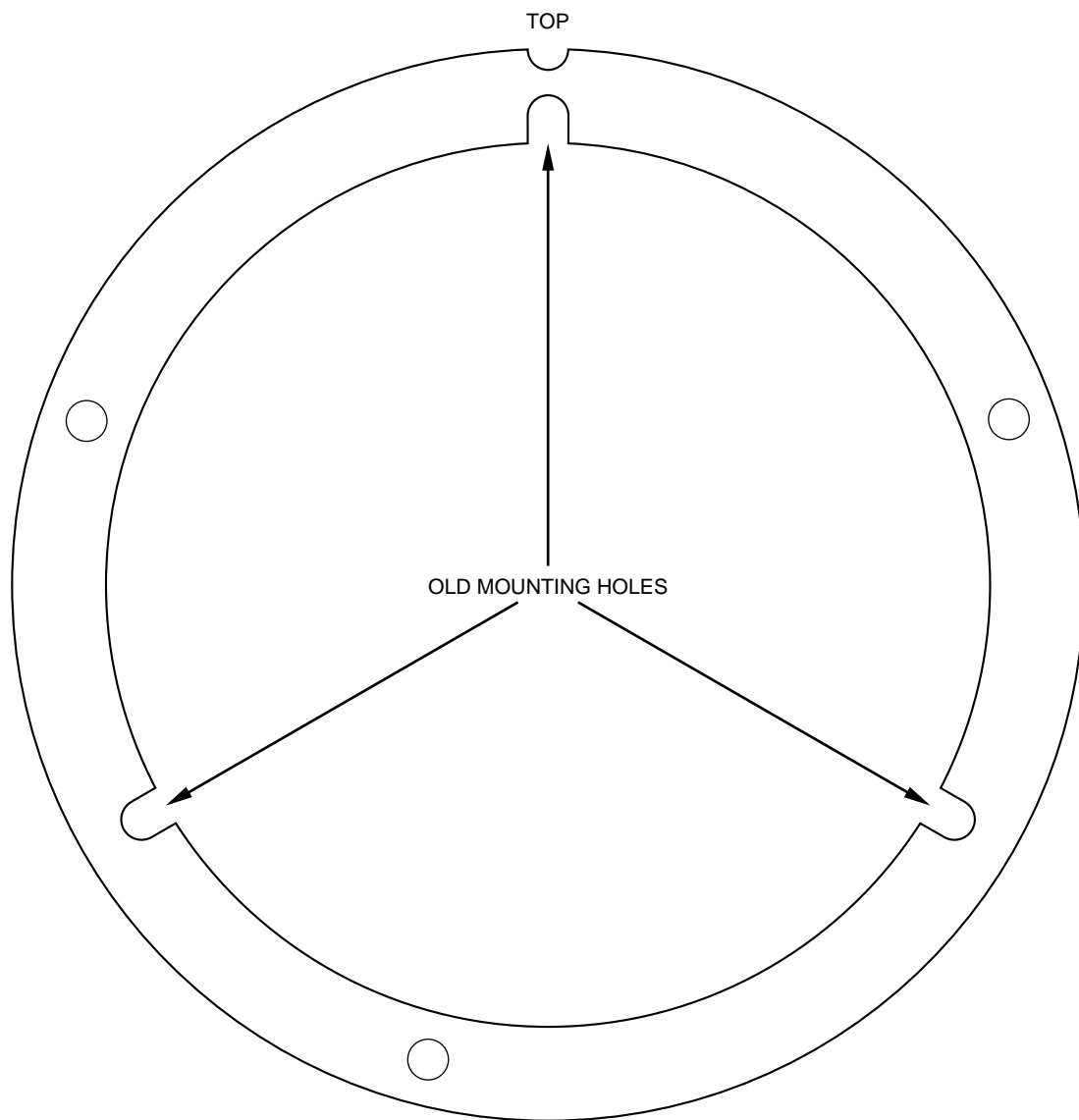

**Fig. 3—Template**

A93585

