

**KSAIF0101AAA, KSAIF0201AAA, KSAIF0301AAA,
KSAIF0401AAA, KSAIF0501AAA, KSAIF0601AAA**

Wi-Fi Interface Kit for Smart Phone Control for Ductless Systems

Owner's Manual

TABLE OF CONTENTS

	PAGE
SAFETY CONSIDERATIONS.....	2
OVERVIEW	4
WIRELESS NETWORK TYPE.....	5
DOWNLOAD AND INSTALL APP (APPLICATION)	5
NETWORK CONFIGURATION.....	6
USER REGISTRATION	7
MULTIPLE SMART PHONE DEVICE CONTROL	9
CONFIGURATION PROCESS	9
USING THE APP	18
MAIN CONTROL INTERFACE.....	20
MODES	23
FUNCTIONS	29
FAN COIL DELETION FROM APP.....	36
GROUP CONTROL (SCENES)	37
SHARED DEVICE.....	43
CAUTIONS	50
TROUBLESHOOTING.....	51

SAFETY CONSIDERATIONS

Installing, starting up, and servicing air-conditioning equipment can be hazardous due to system pressures, electrical components, and equipment location (roofs, elevated structures, etc.). Only trained, qualified installers and service mechanics should install, start-up, and service this equipment. Untrained personnel can perform basic maintenance functions such as cleaning coils.

When working on the equipment, observe precautions in the literature and on tags, stickers, and labels attached to the equipment. Follow all safety codes. Wear safety glasses and work gloves. Keep a quenching cloth and fire extinguisher nearby when brazing. Use care in handling, rigging, and setting bulky equipment.

Read these instructions thoroughly and follow all warnings or cautions included in the literature and attached to the unit. Consult the local building codes and National Electrical Code (NEC) for special requirements. Recognize safety information.

This is the safety-alert symbol . When you see this symbol on the unit and in instructions or manuals, be alert to the potential for personal injury. Understand these signal words:

DANGER, **WARNING**, and **CAUTION**.

These words are used with the safety-alert symbol. **DANGER** identifies the most serious hazards which will result in severe personal injury or death. **WARNING** signifies hazards which could result in personal injury or death. **CAUTION** is used to identify unsafe practices which may result in minor personal injury or product and property damage. **NOTE** is used to highlight suggestions which will result in enhanced installation, reliability, or operation.

NOTE is used to highlight suggestions which results in enhanced installation, reliability, or operation.



CAUTION

ELECTRICAL SHOCK HAZARD

Failure to follow this warning could result in personal injury or death. Before installing, modifying, or servicing system, main electrical disconnect switch must be in the **OFF** position. There may be more than 1 disconnect switch. Lock out and tag switch with a suitable warning label.



CAUTION

EQUIPMENT DAMAGE HAZARD

Failure to follow this caution may result in equipment damage or improper operation.



WARNING

EXPLOSION HAZARD



Failure to follow this warning could result in death, serious personal injury, and/or property damage. Never use air or gases containing oxygen for leak testing or operating refrigerant compressors. Pressurized mixtures of air or gases containing oxygen can lead to an explosion.

OVERVIEW

For the utilization of the hardware provided in the Wi-Fi kits (**KSAIF0101AAA**, **KSAIF0201AAA**, **KSAIF0301AAA**, **KSAIF0401AAA**, **KSAIF0501AAA**, and **KSAIF0601AAA**), the homeowner/end user needs to download the mobile application.

Applicable Systems: iOS, ANDROID

Important: We recommended **iOS 9.0, Android 4.4 or later.**

NOTES:

- APP supports the latest software versions of the Android and iOS systems.
- Due to special situations that may occur, the manufacturer explicitly claims:

NOTE: Not all Android and iOS systems are compatible with the application. The manufacturer does not bear any responsibility for any issue that may result due to incompatibility.

WIRELESS NETWORK TYPE

The Wi-Fi kits are only supported by **WPA-PSK/WPA2-PSK** encryption and **no encryption**. WPA-PSK/WPA2-PSK encryption is recommended.



CAUTION

Check the router website for more information. Due to different network configurations, the control process may occasionally return a time-out. If this situation occurs, attempt to use the app or function inside the app again.

NOTE: Try using the app or function within the app 2-3 times before reconfiguring the app. If unsuccessful, reconfiguring the app may be necessary. Additionally, it may be necessary to configure the network again. If the time-out error continues, reinstall the APP and check your network connection. See “TROUBLESHOOTING” on page 51 for more support. If this situation occurs, the display between the board and app may differ.

NOTE: The manufacturer is not liable for any issues and problems caused by the Internet, Wi-Fi Router and smart devices. Please contact the original provider for additional support.

DOWNLOAD AND INSTALL APP (APPLICATION)

Android Users: Go to Google Play™, search for the [Carrier CliMate](#), [Bryant ControlBox](#), [Ductless Panel](#), or [Midea Air](#) app depending on the type of equipment installed and download it.

iPhone Users: Go to the App Store™, search for the [Carrier CliMate](#), [Bryant ControlBox](#), [Ductless Panel](#), or [Midea Air](#) application and download.

NETWORK CONFIGURATION



CAUTION

Prior to starting the network configuration process, verify your Android or iOS device is connected to the Wi-Fi network you want to configure. Ensure the Android or iOS device Wi-Fi function is turned on and auto-connects to your Wi-Fi network.

Important: During the network configuration process ('AP' mode), the air conditioning remote controller is unable to control the system. It is necessary to finish network configuration, cycle power, or wait eight (8) minutes for the system to time out to regain control.

USER REGISTRATION

CREATE AN ACCOUNT

1. Tap **Create Account** on the first screen when the app is launched for the first time (Fig. 1).

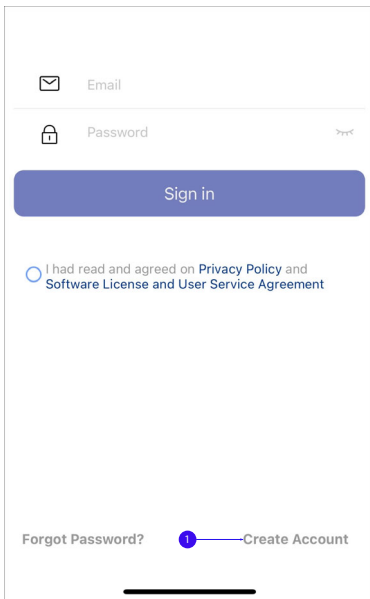

Email

Password

Sign in

I had read and agreed on [Privacy Policy](#) and [Software License and User Service Agreement](#)

[Forgot Password?](#) **1** [Create Account](#)

Fig. 1 — Create Account

NOTE: Fig. 1 illustrates the generic app interface. The interface may vary depending upon the selected app.

2. Enter your **Email** (Fig. 2). Create and enter a **Password**.
3. Tap **Registration**.
4. Read and agree to the **Terms of Service**.

The screenshot shows a mobile application interface for creating an account. At the top is a dark blue header with a white back arrow and the text "Create Account". Below the header are three input fields: "Enter your Email address", "Password", and "Confirm new password". Each field has a grey eye icon to its right. A blue circle with the number "2" is positioned to the right of the "Enter your Email address" field, with two blue arrows pointing to the text input area. Below these fields is a grey button labeled "Registration". A blue circle with the number "3" is positioned to the right of the "Registration" button, with a blue arrow pointing to the button. Below the button is a checkbox, which is currently unchecked. To the right of the checkbox is the text "I have read and agree to the terms of service". A blue circle with the number "4" is positioned to the right of this text, with a blue arrow pointing to the text. The text "of service" is on a separate line below "the terms".

Fig. 2 — Tap Registration

MULTIPLE SMART PHONE DEVICE CONTROL

The app can run on multiple devices in a household. See “SHARED DEVICE” on page 43.

NOTE: Setting up the system again in a different smart phone with a different user name will remove the unit from the first smart phone.

CONFIGURATION PROCESS

1. Ensure your mobile device has already been connected to the Wi-Fi network you choose. It is recommended to select **FORGET ALL NETWORKS** except the one used to connect the fan coil to prevent configuration errors.
2. Disconnect the power supply from the ductless system and wait thirty (30) seconds.
3. Reconnect the power supply to the ductless system.
4. Open the app on your smart phone and log in using the previously configured email and password.

5. Select **Add Device**

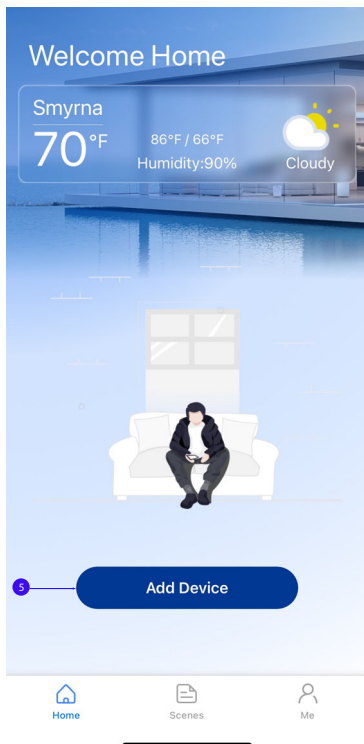

Fig. 3 — Add Device

6. On the screen's menu, select **Ductless** and follow the steps on the screen. Use this method to eliminate the need to scan the **QR code** to complete the configuration.

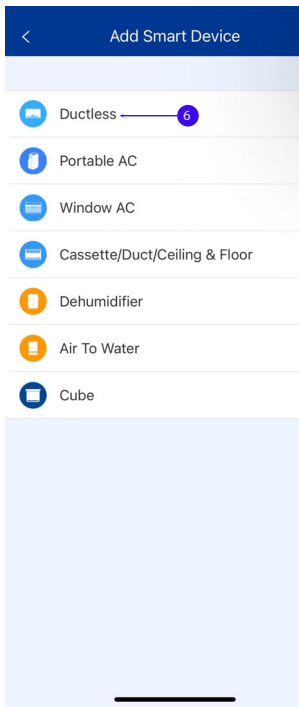

Fig. 4 — Add Smart Device

- Use the Wireless Remote Controller to press **LED** or **DO NOT DISTURB** 7 times within 3 minutes. When the display shows ‘**AP**’, the ductless system is ready for network configuration. Once the indoor unit displays ‘**AP**’ or the indoor unit beeps, tap **Next**.

NOTE: The ducted, cassette, and floor console displays do NOT display ‘AP’ during the network configuration.

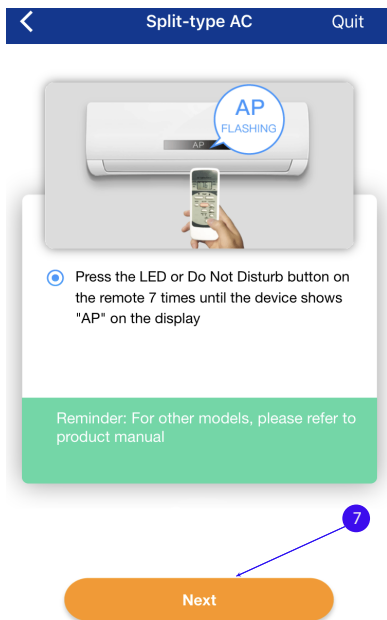

Fig. 5 — Split-type AC

8. On the mobile device go to **Settings > Wi-Fi**, and ensure the Wi-Fi function is turned on. Tap the name of the secure Wi-Fi network (**net_ac_XXXX**). Enter the password **12345678** then tap **Join**. Go back to the app and tap **Next**.



Fig. 6 — Select 'net_ac_XXXX'

9. Select the desired home Wi-Fi name and enter the Wi-Fi password. Press **Start Configuration**.

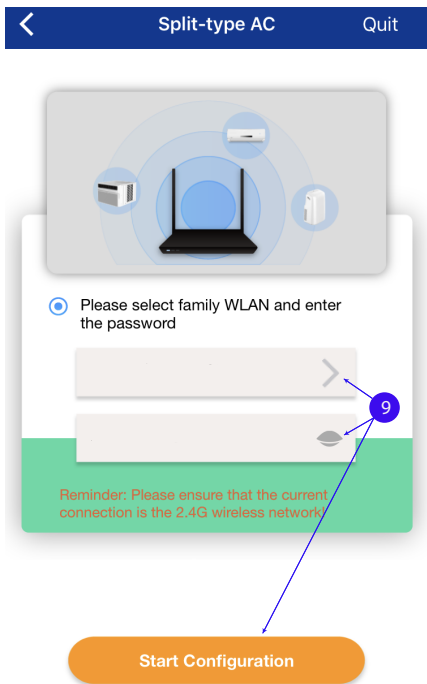

Fig. 7 — Select the Wi-Fi network

The system starts the configuration process based on the user's input. Once the connection is complete, a screen appears which allows the user to select the unit's name or to customize it.

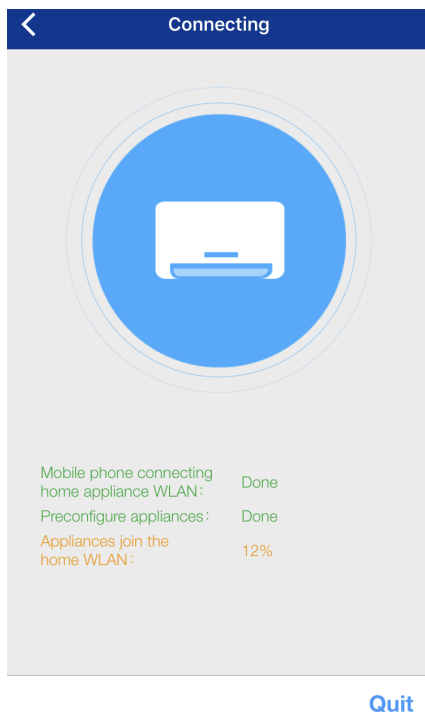

Fig. 8 — Configuration

10. Select the **Device Name**.

Device Name Save

Recommended Name:

Living Room ← 10

Dining Room

Kitchen

Master bedroom

Children bedroom

Study

Guest bedroom

Storage room

Custom Name:

Air Conditioner3EB1

Fig. 9 — Select a Device Name

NOTE: The app may take up to 3 minutes to configure the Wi-Fi kit for connectivity to your Wi-Fi network.

NOTES:

- When the network configuration is complete, the app confirms whether the connection was successful or not.
- Due to different LAN configurations, it is possible that the device's status will display **"OFFLINE"**. Should this occur, refresh the device list by pulling down on the list shown on the app home screen so the ductless system power can be cycled. The device status should change to **"ONLINE"** after a few minutes.

USING THE APP

BASIC FUNCTIONS

Important: Prior to using the app, verify your mobile device and ductless system are connected to the Internet.

1. Log into the app using the previously configured email and password (See “USER REGISTRATION” on page 7).

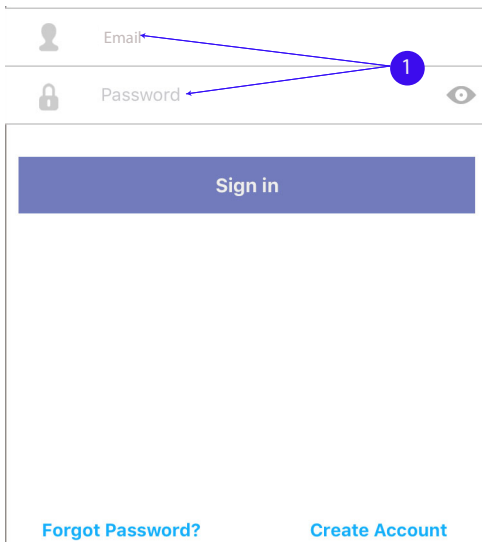

Fig. 10 — Log into the app

2. Select the desired device previously configured to enter the main control interface. To add a new device, tap + **Add Device** and follow the instructions.

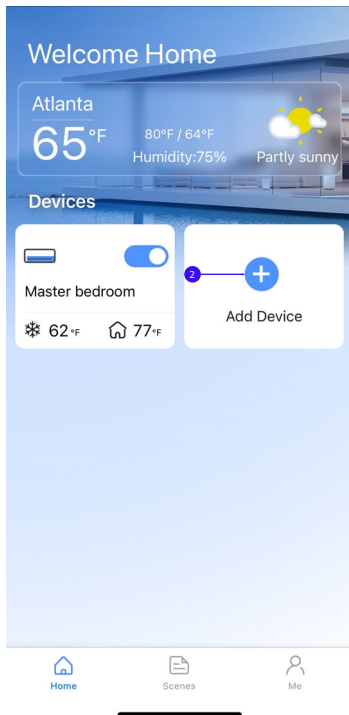

Fig. 11 — Add Device

MAIN CONTROL INTERFACE

3. Use the **Main Control Interface** to control the ductless system's **ON/OFF** status, operation mode, temperature, fan speed, and other functions with the buttons at the bottom of the screen.

NOTE: Feature availability depends on the indoor unit type.

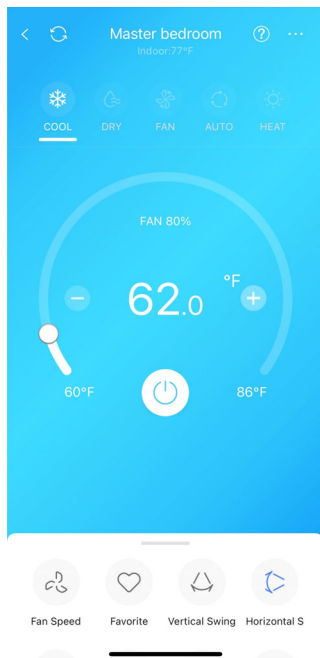

Fig. 12 — Main Control Interface

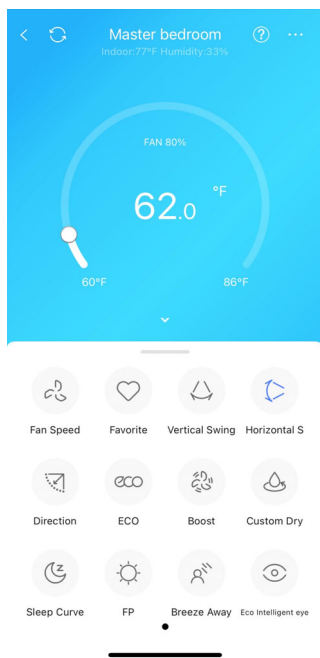

Fig. 13 — Main Control Interface

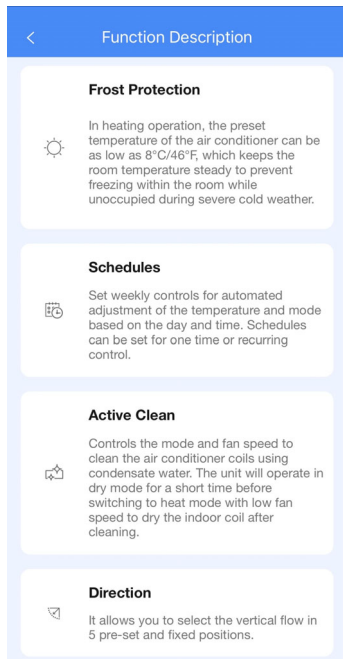

Fig. 14 — Main Control Interface

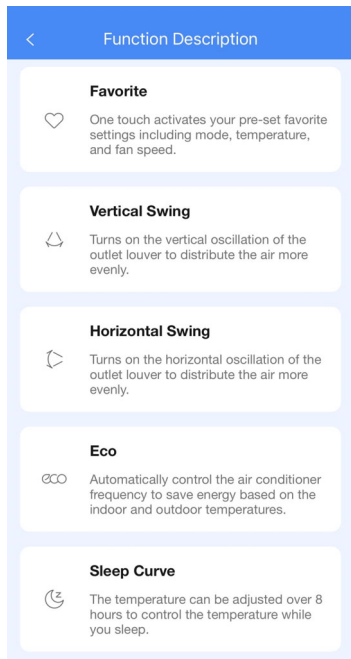

Fig. 15 — Main Control Interface

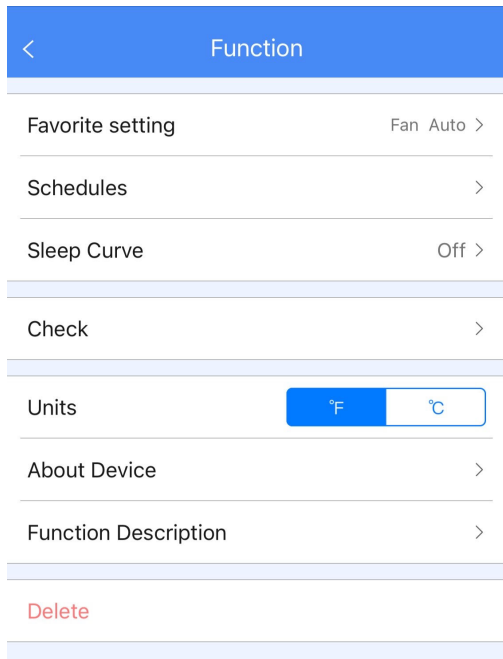

Fig. 16 — Function

MODES

There are five (5) modes available within the app: **AUTO**, **COOL**, **DRY**, **HEAT**, and **FAN**. When the user taps **MODE**, the Mode menu appears at the bottom of the screen. Once the mode changes, the screen's color changes depending on which mode is operational at the time.

Important: When using the app to control the space setpoint and mode, the wireless or wired controller (where applicable) may not update with the settings from the app. Also, if the wireless or wired controller is used to control the setpoint and mode, the app will not update with the setting from the controller. The indoor unit responds to the last command from either the app or the controller.

AUTO

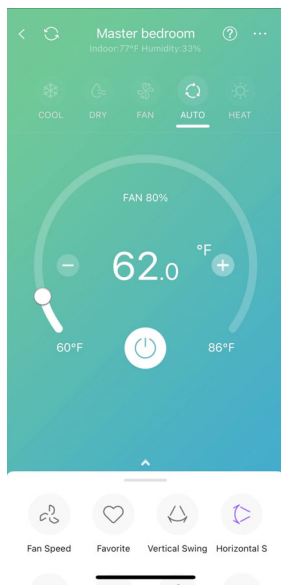

Fig. 17 — Auto Mode

AUTO mode allows the ductless system to shift between the **HEATING** and **COOL** modes to maintain the setpoint. The dead band between setpoint and controllability is 2°F(1°C) and cannot be adjusted within the app. When this mode is selected, the screen color changes.

COOL

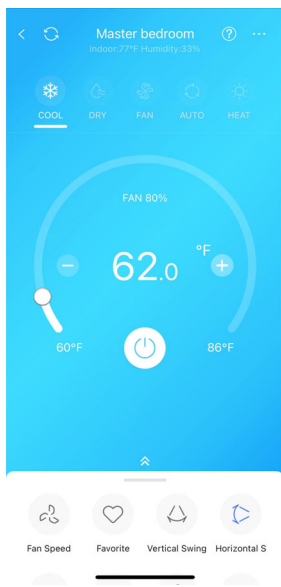

Fig. 18 — Cool Mode

COOL mode allows the ductless system to lock into the **COOL** mode **ONLY** and condition the space by cooling the air to the setpoint. If the space temperature is lower than the setpoint, the ductless system turns off. When this mode is selected, the screen color changes.

DRY

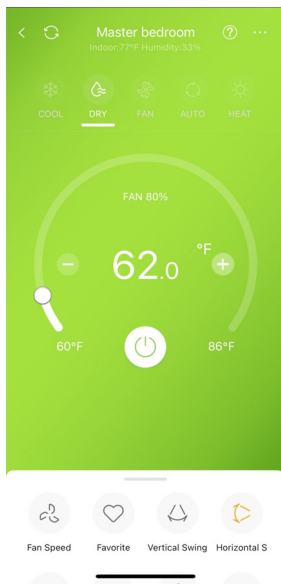

Fig. 19 — Dry Mode

DRY mode locks the ductless system into the **COOL** mode and reduces airflow to increase the water removal from the space. Conditioning of the space is done by cooling the air to the setpoint. If the space temperature is lower than the setpoint, the ductless system turns off. When this mode is selected, the screen color changes.

HEAT

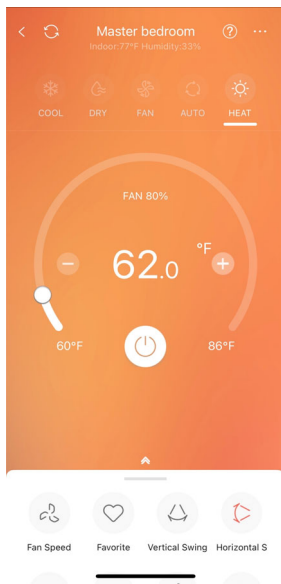

Fig. 20 — Heat Mode

HEAT mode allows the ductless system to lock into the **HEAT** mode only and condition the space by heating the air to the setpoint. If the space temperature is higher than the setpoint, the ductless system turns off. When this mode is selected, the screen color changes.

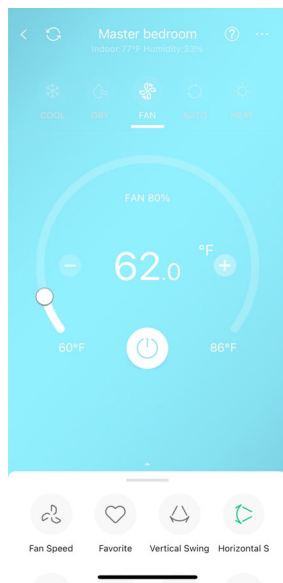

Fig. 21 — Fan Mode

FAN mode allows the ductless system to turn off except for the indoor fan. **FAN** mode is intended to circulate air through the space without conditioning it with the refrigeration system. When this mode is selected, the screen color changes.

FUNCTIONS

TEMPERATURE SET POINT

Once the operation mode is selected, setting the desired indoor temperature set point is usually desired. To do this, use the dial around the temperature setting number on the main screen.

FAN SPEED SETTINGS

There are 4 fan speed options available to the user: **AUTO**, **HIGH**, **MID**, and **LOW**.

NOTE: These speeds are available only when the system is set to the COOL or HEAT modes. Changing fan speeds is not an option in the AUTO or DRY modes.

The adjustments to the fan speed should be done to improve the comfort of the occupant(s).

TURBO

TURBO is only available after the **COOL** mode is selected. **TURBO** is designed to decrease the time it takes for the space to achieve setpoint by triggering the compressor and fan to immediately move to a higher speed.

LOUVER CONTROLS

The app provides 2 different louver controls; horizontal and vertical control. The use of these functions are dependent on the type of fan coil currently installed and if it has a vertical and/or horizontal louver control. When available, these buttons allow the user to adjust the direction of the air flow from the motorized veins.

ECO MODE

ECO mode is available only after the ductless system is set to the **COOL** mode. This mode reduces the energy consumption of the ductless system up to 60% by slowing the compressor and reducing the maximum capacity output. This mode remains active for 8 hrs and then the system returns to the normal operating mode.

NOTE: While in this mode, the system may not obtain the setpoint if there is a large thermal load on the space.

UNIT OF MEASURE

By default, the app is configured in Celsius for the temperature unit of measure. Tap the °F/°C icon to switch to Fahrenheit. If pressed again, the unit of measure returns to Celsius.

SCHEDULING

Seven day programmable features are available to set on and off times for the system to condition the space allowing customized time, days, modes and temperatures of operation.

The screenshot shows a scheduling interface with a dark blue header bar containing a back arrow, the text "Schedules", and a "Confirm" button. Below the header, there are two buttons: "24 H" and "12 H", with "12 H" being selected. The main area contains a table with two rows for AM and PM. The AM row shows a start time of 11:00 and an end time of 01:00, with the mode set to "On". The PM row shows a start time of 02:00 and an end time of 02:00, with the mode set to "Off". Below the table, there are two sections: "Repeat" with the option "Only Once" and a right arrow, and "Settings" with the option "Cool 62°F High" and a right arrow.

	Start Time	End Time	Mode
AM	11:00	01:00	On
PM	02:00	02:00	Off

Repeat: Only Once >

Settings: Cool 62°F High >

Fig. 22 — Scheduling

46°F (8°C) HEATING SETBACK/VACATION MODE

The feature allows the system to enter a setback/vacation mode when the space is or will be unoccupied. The system follows a space temperature setpoint of 46°F (8°C) to protect the space from freezing temperatures.

SLEEP

SLEEP allows the user to customize the space temperatures throughout a sleep cycle of 8 hours by setting a targeted temperature for each hour of the cycle. Adjust the temperature by dragging each round node to the desired temperature.

Important: This mode must POWER ON when it is desired to start the sleep cycle.

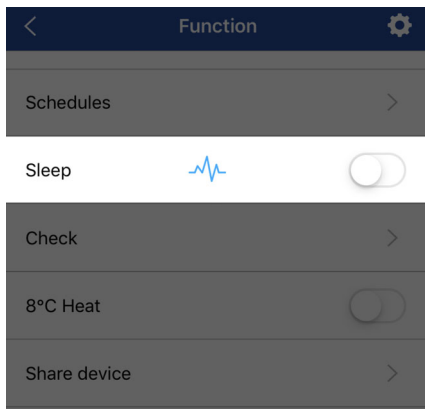

Fig. 23 — Function



Fig. 24 — Sleep Curve

NOTE: Start time scheduling for the sleep cycle is currently unavailable.

SYSTEM CHECK

A system health check can be performed in the check screen. The **SYSTEM CHECK** function informs the user or service technician of normal items, abnormal items, and detailed information about the operating characteristics of the ductless system while operating.

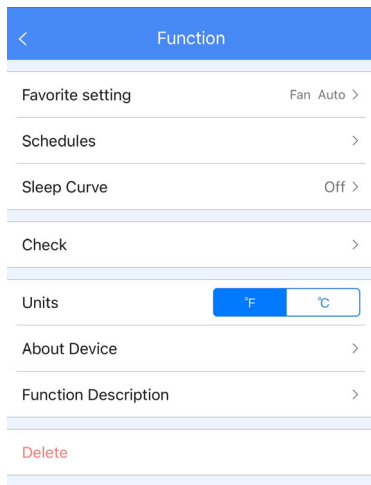

Fig. 25 — System Check

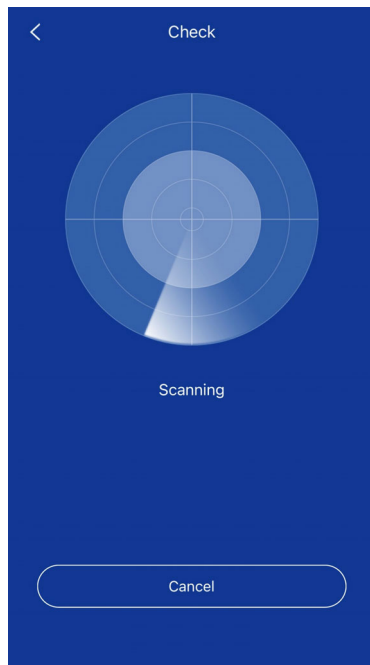

Fig. 26 — System Check

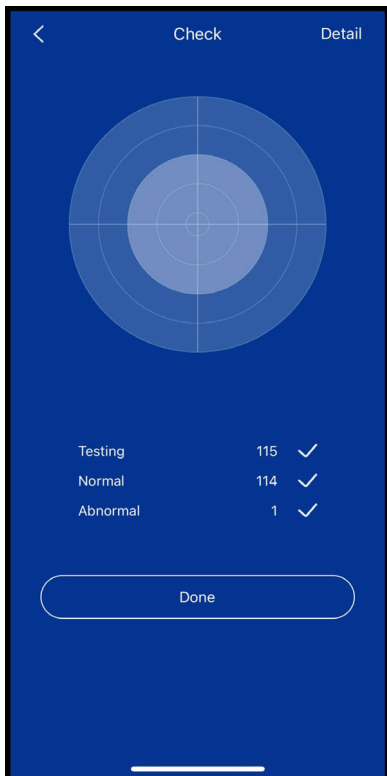

Fig. 27 — System Check

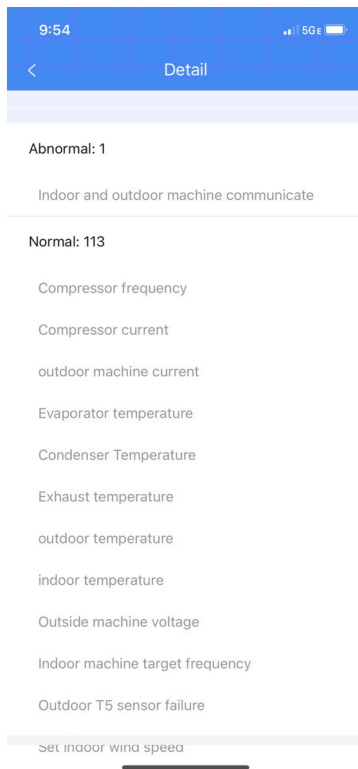

Fig. 28 — System Check

FAN COIL DELETION FROM APP

In the event a fan coil is decommissioned or a user moves from a location where a Wi-Fi kit is installed, the ductless system can be removed from the app by tapping and holding the device you want to delete, and selecting **Yes** (see Fig.29). Alternatively, by entering the **Function** menu, accessible from the icon in the top right of the **Main Control Interface** screen (see Fig. 30 — on page 36).

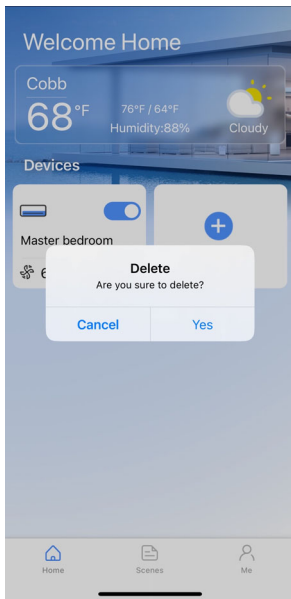

Fig. 29 — Fan Coil Deletion from App

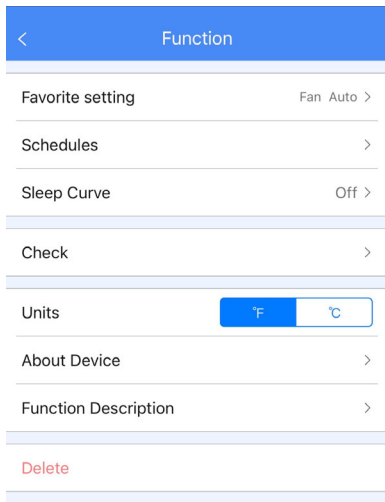

Fig. 30 — Fan Coil Deletion from App

GROUP CONTROL (SCENES)

The systems can be grouped together to operate at the same time with the same set point fan speeds and modes. Scenes allow you to group your devices and change them to your preset setting with one tap.

To **group** the systems:

1. Go to the **Home Page** and click **Scenes**.
2. Click **Create Scene**.

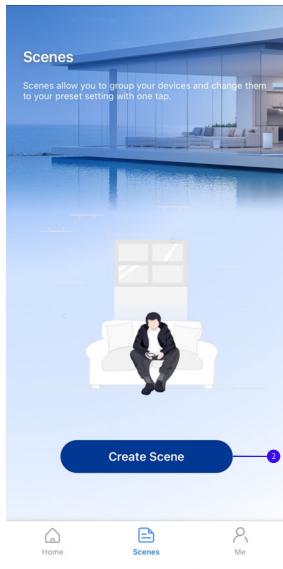

Fig. 31 — Scenes

3. Select the units to group and tap **Next**.

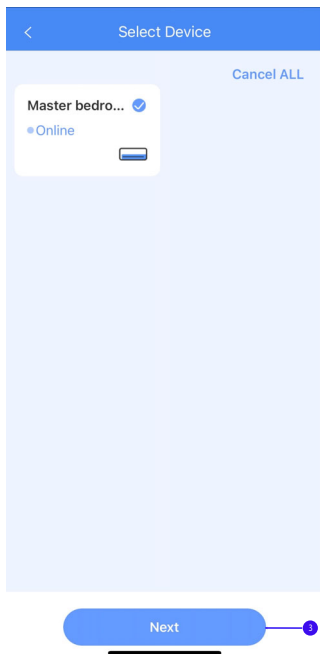

Fig. 32 — Confirm Group

4. Name the group and press **Create**.



Fig. 33 — Name the Group

The **Scenes** screen shows the number of zones grouped.

5. Use the **Scenes** screen to control the new group. Press **EXECUTE** to trigger the action.

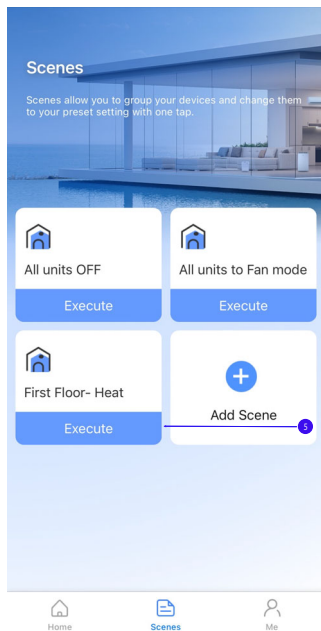

Fig. 34 — Group Information

6. Select **CONFIRM**.

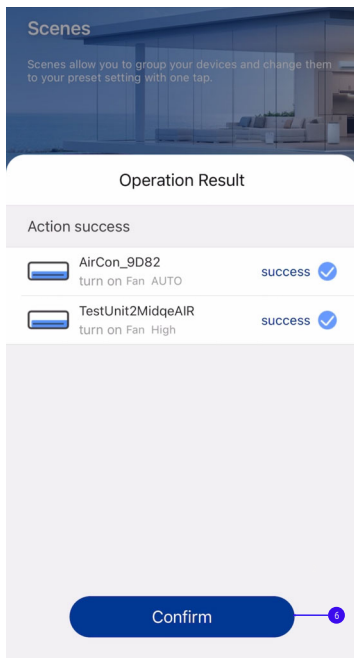

Fig. 35 — Confirm

Mode Conflicts for Multi-Zone systems: The indoor units of a Multi-Zone system cannot operate in the **COOLING** and **HEATING** mode simultaneously. Indoor units are configured with the **HEATING** mode as a priority from the factory.

Heating Priority: If any unit in the system is set to the **HEATING** mode, the system priority switches to **HEAT**. If any unit is setup in **COOLING**, while any unit in the system is operating as **HEATING**, the units set to **COOLING** will enter the **STANDBY** mode, which turns off the indoor unit until all the indoor units are in the same mode.

Cooling Priority: If any unit in the system is set to the **COOLING** mode the system priority switches to **COOLING**. If any unit is setup in **HEATING**, while any unit in the system is operating as **COOLING**, the units set to **HEATING** will enter the **STANDBY** mode, which turns off the indoor unit until all indoor units are in the same mode.

SHARED DEVICE

The ductless unit can be controlled by multi-users at the same time with the **Share Device** function.

Share your device with other users:

1. Navigate to “Me” -> “Share Device”.

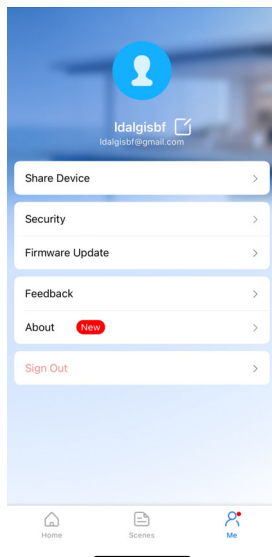

Fig. 36 —Share Device

2. Select **“Home Owner: Share QR Code”**

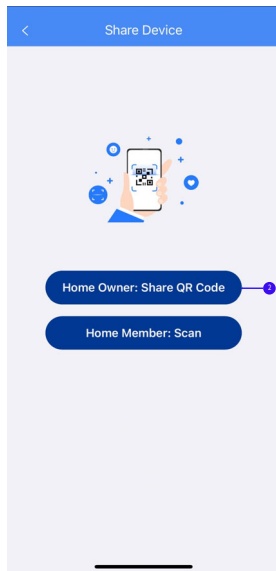

Fig. 37 — Share QR Code

3. Select the device you want to share.

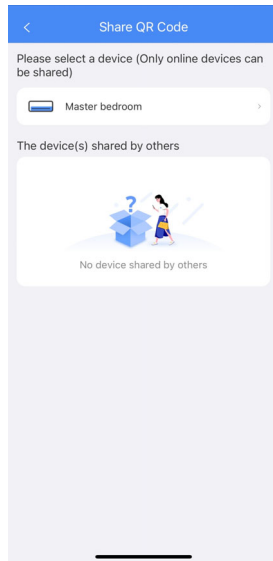

Fig. 38 — Select the Device

4. Share the QR Code.

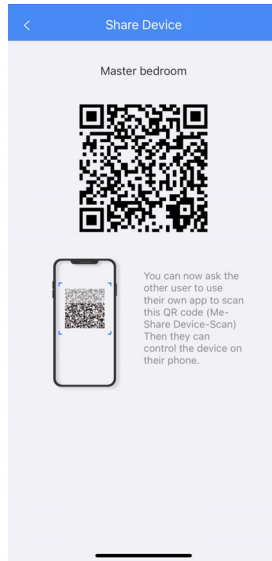

Fig. 39 — Share QR Code

NOTE: A notification to accept the request to share the device appears.

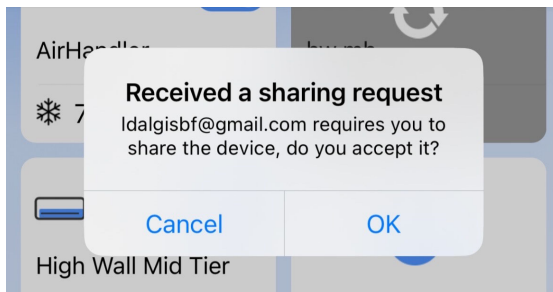

Fig. 40 — Notification (Accept or Deny)

Add a Shared Device for a Home Member

1. Navigate to “Me” -> “Share Device”.

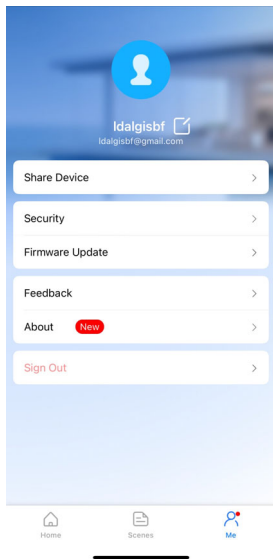

Fig. 41 — Shared Device

2. Select **“Home Member: Scan”**.

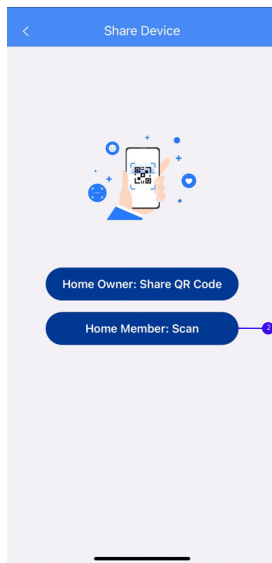

Fig. 42 — Home Member : Scan

3. Scan QR Code to add shared device.

NOTE: You are not permitted to share a unit that you do not own.

CAUTIONS

The Wi-Fi kit complies with **47cfr sub-part 15** and **RSS 210** of the Industry and Science of Canada. Operation is subject to the following conditions:

1. This device may not cause a harmful interface, and
2. this device must not accept any interference received, including interference that may cause undesired operation.

Only operate the device in accordance with the instructions provided. The Wi-Fi kit complies with FCC and IC electromagnetic radiation limits set forth for a residential environment. To avoid the possibility of exceeding the FCC and/or IC radio electromagnetic radiation limits, human proximity to the antenna shall not be less than 8 inches (20cm) during normal operation.

Changes or modifications not expressly approved by the manufacturer could void the user's authority to operate the equipment.

TROUBLESHOOTING

Table 1 — Troubleshooting

ISSUE	RESOLUTION
Connection failure between the Wi-Fi AC and home router	Wrong password inputted: If there is no response for a long time, disconnect from the AP mode then reconnect to the AP mode and repeat the network setup process.
	Password contains special characters: The Wi-Fi app only supports letters and numbers. The app does not support “*, @, /”.
	Unsupported Encryption: Check the router encryption to verify only WAP-PSK or WAP2-PSK or no encryption is used.
	Wi-Fi network requires a login to access: Some Wi-Fi networks in public places or businesses require a user name and password to access the Internet. The Wi-Fi kit does not support this type of access.
	The router is set to filter MAC addresses: In this case, the router forbids all connected devices except those listed in the router filter list. To resolve this, the Wi-Fi kit MAC address should be added to the accepted MAC list in the router settings or change the router configuration to abstain from filtering MAC addresses.
Connection failure between router and cloud server	Use a computer or smart phone Internet browser to navigate to https://app.v1.appsmb.com:8443/V2/Login.ashx . If you see the following message, your connection is good: <code><?xml version="1.0" encoding="UTF-8"?><response result="3000" encry="0" code="0"/></code>
System removed from the app when other user adds the system	The app can run on multiple devices in a household. Sign in to the SAME account using the user name and password used to setup the system. NOTE: Setting up the system again on a different smart phone device with a different user name removes the unit from the first smart phone device.

