

CHC & HCC SERIES HEAT PUMPS, 3 PHASE

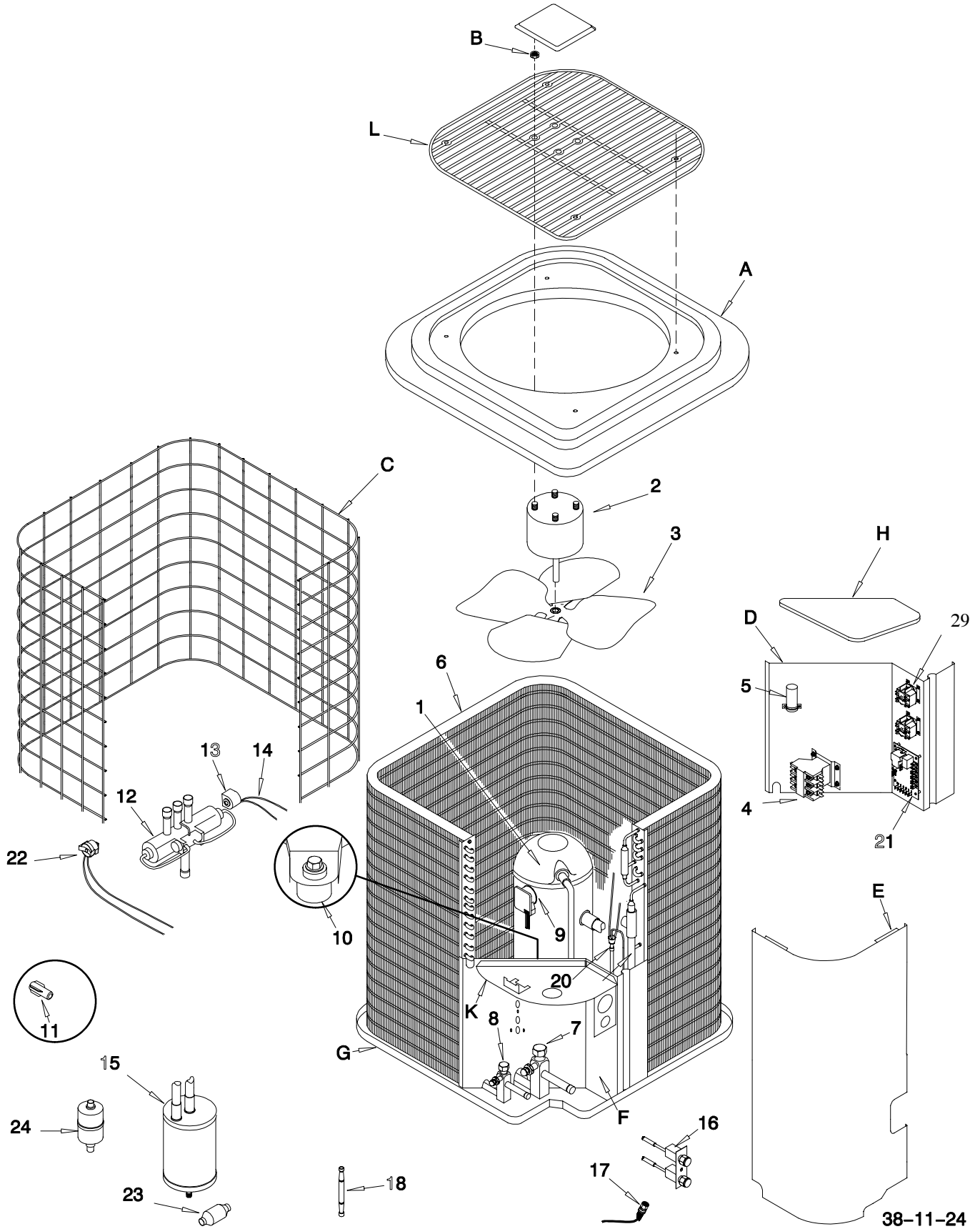

CHC & HCC SERIES HEAT PUMPS, 3 PHASE

Style No:	CHC036H/HCC036H	Outdoor Ambient Temperature - Degrees F. Dry Bulb																					
		75				85				95				105				115					
		Entering Indoor Temperature - Degrees F. Wet Bulb																					
Voltage	208/230	IDB	59	63	67	71	59	63	67	71	59	63	67	71	59	63	67	71	59	63	67	71	
Phase	3			MBh	33.3	34.2	37.1	39.8	32.5	33.4	36.2	38.8	31.7	32.6	35.3	37.9	30.1	31.0	33.5	36.0	27.9	28.7	31.1
Ampacity	14.7		S/T	.81	.73	.55	.35	.83	.75	.56	.36	.86	.77	.58	.37	.89	.80	.60	.39	.90	.81	.61	.39
Min. Fuse	15		AMPS	8.8	9.0	9.3	9.7	9.6	9.8	10.1	10.5	10.2	10.5	10.8	11.2	10.9	11.1	11.5	11.9	11.5	11.8	12.2	12.6
Delay Fuse	20		HI PR	183	197	208	217	208	224	236	247	237	255	269	281	267	287	303	316	295	317	335	349
Max. Fuse	20		LO PR	61	65	71	75	63	67	74	78	66	71	77	82	70	74	81	86	72	77	84	89
Compressor	Scroll		MBh	33.9	34.6	37.0	39.5	33.0	33.8	36.1	38.6	32.2	32.9	35.2	37.6	30.6	31.3	33.4	35.7	28.4	29.0	31.0	33.1
RLA	10.26		S/T	.89	.84	.68	.51	.91	.86	.70	.52	.94	.88	.72	.54	.98	.92	.75	.56	.99	.93	.75	.56
LRA	77		AMPS	8.9	9.1	9.4	9.8	9.7	9.9	10.2	10.6	10.3	10.6	10.9	11.3	11.0	11.2	11.6	12.0	11.6	11.9	12.3	12.7
Cap MFD/V	n/a		HI PR	185	199	210	219	210	226	239	249	239	258	272	284	269	290	306	319	298	320	338	353
CC Heater	n/a		LO PR	62	65	71	76	64	68	74	79	67	71	78	83	70	75	82	87	73	77	85	90
Start Kit	n/a		MBh	34.4	35.1	36.8	39.2	33.6	34.3	35.9	38.3	32.8	33.4	35.0	37.4	31.2	31.8	33.3	35.5	28.9	29.4	30.8	32.9
Fan Motor			S/T	.93	.90	.81	.66	.96	.92	.83	.68	.99	.95	.86	.70	1.00	.99	.89	.73	1.00	1.00	.90	.73
Horsepower	0.33		AMPS	9.0	9.2	9.5	9.8	9.8	10.0	10.3	10.7	10.4	10.7	11.0	11.4	11.1	11.3	11.7	12.1	11.7	12.0	12.4	12.8
FLA	1.9		HI PR	187	201	212	221	212	228	241	252	242	260	275	287	272	293	309	322	300	323	341	356
LRA	3.7		LO PR	62	66	72	77	65	69	75	80	68	72	79	84	71	76	83	88	74	78	85	91
RPM	1075		Calculated averaged performance data, for service applications for all matches.																				
Cap MFD/V	5/370		Part No: 1099614																				
PTCR	n/a		*Add or Subtract (Oz per Ft) for Lines: .25oz -1/4 Liq, .45oz- 5/16 Liq, .60oz - 3/8 Liq, 1.2 oz - 1/2 Liq																				
Hi Press	420-300																						
Low Press	20 - 5																						
Low Amb	n/a																						
Defrost	Timed																						
Sensor																							
Operating Chg	See Rating Plate																						
(25 Ft Line)*																							
Service Driers																							
Liquid/Chg	5CuIn/5oz																						
Suction	17SqIn																						
Unit Weight	201																						

Style No:	CHC036L/HCC036L	Outdoor Ambient Temperature - Degrees F. Dry Bulb																					
		75				85				95				105				115					
		Entering Indoor Temperature - Degrees F. Wet Bulb																					
Voltage	460	IDB	59	63	67	71	59	63	67	71	59	63	67	71	59	63	67	71	59	63	67	71	
Phase	3			MBh	33.3	34.2	37.1	39.8	32.5	33.4	36.2	38.8	31.7	32.6	35.3	37.9	30.1	31.0	33.5	36.0	27.9	28.7	31.1
Ampacity	7.2		S/T	.81	.73	.55	.35	.83	.75	.56	.36	.86	.77	.58	.37	.89	.80	.60	.39	.90	.81	.61	.39
Min. Fuse	15		AMPS	4.3	4.4	4.5	4.7	4.7	4.8	4.9	5.1	5.0	5.1	5.3	5.5	5.3	5.4	5.6	5.8	5.6	5.8	6.0	6.2
Delay Fuse	15		HI PR	183	197	208	217	208	224	236	247	237	255	269	281	267	287	303	316	295	317	335	349
Max. Fuse	15		LO PR	61	65	71	75	63	67	74	78	66	71	77	82	70	74	81	86	72	77	84	89
Compressor	Scroll		MBh	33.9	34.6	37.0	39.5	33.0	33.8	36.1	38.6	32.2	32.9	35.2	37.6	30.6	31.3	33.4	35.7	28.4	29.0	31.0	33.1
RLA	5.13		S/T	.89	.84	.68	.51	.91	.86	.70	.52	.94	.88	.72	.54	.98	.92	.75	.56	.99	.93	.75	.56
LRA	39		AMPS	4.3	4.4	4.6	4.8	4.7	4.8	5.0	5.2	5.0	5.2	5.3	5.5	5.4	5.5	5.7	5.9	5.7	5.8	6.0	6.2
Cap MFD/V	n/a		HI PR	185	199	210	219	210	226	239	249	239	258	272	284	269	290	306	319	298	320	338	353
CC Heater	n/a		LO PR	62	65	71	76	64	68	74	79	67	71	78	83	70	75	82	87	73	77	85	90
Start Kit	n/a		MBh	34.4	35.1	36.8	39.2	33.6	34.3	35.9	38.3	32.8	33.4	35.0	37.4	31.2	31.8	33.3	35.5	28.9	29.4	30.8	32.9
Fan Motor			S/T	.93	.90	.81	.66	.96	.92	.83	.68	.99	.95	.86	.70	1.00	.99	.89	.73	1.00	1.00	.90	.73
Horsepower	0.33		AMPS	4.4	4.5	4.6	4.8	4.8	4.9	5.0	5.2	5.1	5.2	5.4	5.6	5.4	5.5	5.7	5.9	5.7	5.9	6.1	6.3
FLA	0.74		HI PR	187	201	212	221	212	228	241	252	242	260	275	287	272	293	309	322	300	323	341	356
LRA	2.15		LO PR	62	66	72	77	65	69	75	80	68	72	79	84	71	76	83	88	74	78	85	91
RPM	1100		Calculated averaged performance data, for service applications for all matches.																				
Cap MFD/V	5/370		Part No: 1099615																				
PTCR	n/a		*Add or Subtract (Oz per Ft) for Lines: .25oz -1/4 Liq, .45oz- 5/16 Liq, .60oz - 3/8 Liq, 1.2 oz - 1/2 Liq																				
Hi Press	420-300																						
Low Press	20 - 5																						
Low Amb	n/a																						
Defrost	Timed																						
Sensor																							
Operating Chg	See Rating Plate																						
(No Lines)*																							
Service Driers																							
Liquid/Chg	8CuIn/7oz																						
Suction	30SqIn																						
Unit Weight	201																						

CHC & HCC SERIES HEAT PUMPS, 3 PHASE

Style No:	CHC036S/HCC036S	Outdoor Ambient Temperature - Degrees F. Dry Bulb																			
		75				85				95				105				115			
		Entering Indoor Temperature - Degrees F. Wet Bulb																			
		IDB																			
		59	63	67	71	59	63	67	71	59	63	67	71	59	63	67	71	59	63	67	71
Voltage	575																				
Phase	3																				
Ampacity	5.9																				
Min. Fuse	15																				
Delay Fuse	15																				
Max. Fuse	15																				
Compressor	Scroll																				
RLA	4.23																				
LRA	31																				
Cap MFD/V	n/a																				
CC Heater	n/a																				
Start Kit	n/a																				
Fan Motor																					
Horsepower	0.33																				
FLA	0.57																				
LRA	1.88																				
RPM	1100																				
Cap MFD/V	5/370																				
PTCR	n/a																				
Hi Press	420-300																				
Low Press	20 - 5																				
Low Amb	n/a																				
Defrost	Timed																				
Sensor																					
Operating Chg (No Lines)*	See Rating Plate																				
Service Driers																					
Liquid/Chg	8Culn/7oz																				
Suction	30SqIn																				
Unit Weight	201																				

Style No:	CHC042H/HCC042H	Outdoor Ambient Temperature - Degrees F. Dry Bulb																			
		75				85				95				105				115			
		Entering Indoor Temperature - Degrees F. Wet Bulb																			
		IDB																			
		59	63	67	71	59	63	67	71	59	63	67	71	59	63	67	71	59	63	67	71
Voltage	208/230																				
Phase	3																				
Ampacity	17.5																				
Min. Fuse	25																				
Delay Fuse	25																				
Max. Fuse	15																				
Compressor	Scroll																				
RLA	12.44																				
LRA	88																				
Cap MFD/V	n/a																				
CC Heater	n/a																				
Start Kit	n/a																				
Fan Motor																					
Horsepower	0.33																				
FLA	1.9																				
LRA	3.7																				
RPM	1075																				
Cap MFD/V	5/370																				
PTCR	n/a																				
Hi Press	420-300																				
Low Press	5																				
Low Amb	n/a																				
Defrost	Timed																				
Sensor																					
Operating Chg (No Lines)*	See Rating Plate																				
Service Driers																					
Liquid/Chg	16Culn/11oz																				
Suction	30SqIn																				
Unit Weight	216																				

Calculated averaged performance data, for service applications for all matches.

Part No:

*Add or Subtract (Oz per Ft) for Lines: .25oz -1/4 Liq, .45oz- 5/16 Liq, .60oz- 3/8 Liq, 1.2 oz - 1/2 Liq

1099616

CHC & HCC SERIES HEAT PUMPS, 3 PHASE

Style No:	CHC048S/HCC048S	Outdoor Ambient Temperature - Degrees F. Dry Bulb																			
		75				85				95				105				115			
		Entering Indoor Temperature - Degrees F. Wet Bulb																			
	IDB	59	63	67	71	59	63	67	71	59	63	67	71	59	63	67	71	59	63	67	71
Voltage	575																				
Phase	3																				
Ampacity	7.1																				
Min. Fuse	15																				
Delay Fuse	15																				
Max. Fuse	15																				
Compressor	Scroll																				
RLA	5.13																				
LRA	37																				
Cap MFD/V	n/a																				
CC Heater	n/a																				
Start Kit	n/a																				
Fan Motor																					
Horsepower	0.25																				
FLA	0.7																				
LRA	1.65																				
RPM	840																				
Cap MFD/V	5/370																				
PTCR	n/a	Heating																			
Hi Press	420	IDB	65	60	55	50	47	45	40	35	30	25	20	17	15	10	5	0	-5	-10	
Low Press	5	MBh	60.3	57.1	53.8	50.3	48.0	46.5	43.2	39.8	37.4	34.5	31.8	30.0	28.9	25.9	23.0	20.0	17.1	14.0	
Low Amb	n/a	T/R	35	33	31	29	28	27	25	23	22	20	18	17	17	15	13	12	10	8	
Defrost	Timed	KW	4.4	4.4	4.3	4.2	4.1	4.1	4.0	3.9	4.0	3.9	3.8	3.8	3.8	3.7	3.6	3.5	3.4	3.3	
Sensor		AMPS	5.9	5.5	5.2	4.9	4.7	4.6	4.4	4.2	4.0	3.9	3.7	3.6	3.6	3.4	3.2	3.0	2.8	2.6	
Operating Chg (No Lines)*	See Rating Plate	COP	4.0	3.8	3.7	3.5	3.4	3.3	3.1	3.0	2.7	2.6	2.4	2.3	2.3	2.1	1.9	1.7	1.5	1.2	
Service Driers		EER	13.6	13.1	12.6	12.0	11.6	11.3	10.7	10.1	9.3	8.8	8.3	7.9	7.7	7.1	6.4	5.7	5.0	4.2	
Liquid/Chg	30Culn/17oz	HI PR	234	224	215	206	201	197	190	182	174	166	160	156	153	147	142	136	131	126	
Suction	30SqIn	LO PR	69	64	60	55	52	50	46	41	37	33	29	27	26	22	19	16	14	11	
Unit Weight	242	Calculated averaged performance data, for service applications for all matches.																Part No: 1099624			
		*Add or Subtract (Oz per Ft) for Lines: .25oz -1/4 Liq, .45oz- 5/16 Liq, .60oz - 3/8 Liq, 1.2 oz - 1/2 Liq																			

Style No:	CHC060H/HCC060H	Outdoor Ambient Temperature - Degrees F. Dry Bulb																			
		75				85				95				105				115			
		Entering Indoor Temperature - Degrees F. Wet Bulb																			
	IDB	59	63	67	71	59	63	67	71	59	63	67	71	59	63	67	71	59	63	67	71
Voltage	208/230																				
Phase	3																				
Ampacity	24.6																				
Min. Fuse	30																				
Delay Fuse	30																				
Max. Fuse	40																				
Compressor	Scroll																				
RLA	18.6																				
LRA	128																				
Cap MFD/V	n/a																				
CC Heater	n/a																				
Start Kit	n/a																				
Fan Motor																					
Horsepower	0.25																				
FLA	1.4																				
LRA	3.24																				
RPM	840																				
Cap MFD/V	5/370																				
PTCR	n/a	Heating																			
Hi Press	420	IDB	65	60	55	50	47	45	40	35	30	25	20	17	15	10	5	0	-5	-10	
Low Press	5	MBh	75.4	71.4	67.3	62.8	60.0	58.1	54.0	49.8	46.1	42.6	39.2	37.0	35.6	32.0	28.3	24.7	21.1	17.3	
Low Amb	n/a	T/R	39	37	35	32	31	30	28	26	24	22	20	19	18	16	15	13	11	9	
Defrost	Timed	KW	5.7	5.6	5.5	5.4	5.3	5.3	5.2	5.1	5.0	4.9	4.8	4.8	4.7	4.6	4.5	4.4	4.3	4.2	
Sensor		AMPS	22.9	21.1	19.8	18.6	17.9	17.5	16.5	15.6	15.0	14.3	13.6	13.2	13.1	12.4	11.5	10.8	10.0	8.9	
Operating Chg (No Lines)*	See Rating Plate	COP	3.9	3.7	3.6	3.4	3.3	3.2	3.1	2.9	2.7	2.5	2.4	2.3	2.2	2.0	1.8	1.7	1.4	1.2	
Service Driers		EER	13.2	12.7	12.2	11.6	11.3	11.0	10.4	9.8	9.1	8.6	8.1	7.8	7.6	7.0	6.3	5.6	4.9	4.2	
Liquid/Chg	30Culn/17oz	HI PR	264	253	243	232	227	223	214	205	197	188	180	176	173	166	160	153	148	143	
Suction	30SqIn	LO PR	68	63	59	54	51	49	45	40	36	32	28	26	26	22	19	16	14	11	
Unit Weight	280	Calculated averaged performance data, for service applications for all matches.																Part No: 1099625			
		*Add or Subtract (Oz per Ft) for Lines: .25oz -1/4 Liq, .45oz- 5/16 Liq, .60oz - 3/8 Liq, 1.2 oz - 1/2 Liq																			

CHC & HCC SERIES HEAT PUMPS, 3 PHASE

Style No:	CHC060L/HCC060L		Outdoor Ambient Temperature - Degrees F. Dry Bulb																			
			75				85				95				105				115			
			Entering Indoor Temperature - Degrees F. Wet Bulb																			
		IDB	59	63	67	71	59	63	67	71	59	63	67	71	59	63	67	71	59	63	67	71
Voltage	460																					
Phase	3																					
Ampacity	10.8																					
Min. Fuse	15																					
Delay Fuse	15																					
Max. Fuse	15																					
Compressor	Scroll																					
RLA	7.95																					
LRA	62																					
Cap MFD/V	n/a																					
CC Heater	n/a																					
Start Kit	n/a																					
Fan Motor																						
Horsepower	0.25																					
FLA	0.87																					
LRA	1.8																					
RPM	840																					
Cap MFD/V	5/370																					
PTCR	n/a	Heating	Outdoor Ambient Temperature - Degrees F. Dry Bulb																			
Hi Press	420	IDB	65	60	55	50	47	45	40	35	30	25	20	17	15	10	5	0	-5	-10		
Low Press	5																					
Low Amb	n/a																					
Defrost	Timed																					
Sensor																						
Operating Chg (No Lines)*	See Rating Plate																					
Service Driers																						
Liquid/Chg	30Culn/17oz																					
Suction	30SqIn																					
Unit Weight	280																					

Calculated averaged performance data, for service applications for all matches. Part No: 1099626

*Add or Subtract (Oz per Ft) for Lines: .25oz -1/4 Liq, .45oz- 5/16 Liq, .60oz - 3/8 Liq, 1.2 oz - 1/2 Liq

Style No:	CHC060S/HCC060S		Outdoor Ambient Temperature - Degrees F. Dry Bulb																			
			75				85				95				105				115			
			Entering Indoor Temperature - Degrees F. Wet Bulb																			
		IDB	59	63	67	71	59	63	67	71	59	63	67	71	59	63	67	71	59	63	67	71
Voltage	575																					
Phase	3																					
Ampacity	9																					
Wire Ga/Ft	15																					
Delay Fuse	15																					
Max. Fuse	15																					
Compressor	Scroll																					
RLA	6.6																					
LRA	49																					
Cap MFD/V	n/a																					
CC Heater	n/a																					
Start Kit	n/a																					
Fan Motor																						
Horsepower	0.25																					
FLA	0.7																					
LRA	1.65																					
RPM	840																					
Cap MFD/V	5/370																					
PTCR	n/a	Heating	Outdoor Ambient Temperature - Degrees F. Dry Bulb																			
Hi Press	420	IDB	65	60	55	50	47	45	40	35	30	25	20	17	15	10	5	0	-5	-10		
Low Press	5																					
Low Amb	n/a																					
Defrost	Timed																					
Sensor																						
Operating Chg (No Lines)*	See Rating Plate																					
Service Driers																						
Liquid/Chg	30Culn/17oz																					
Suction	30SqIn																					
Unit Weight	280																					

Calculated averaged performance data, for service applications for all matches. Part No: 1099627

*Add or Subtract (Oz per Ft) for Lines: .25oz -1/4 Liq, .45oz- 5/16 Liq, .60oz - 3/8 Liq, 1.2 oz - 1/2 Liq

CHC & HCC SERIES HEAT PUMPS, 3 PHASE

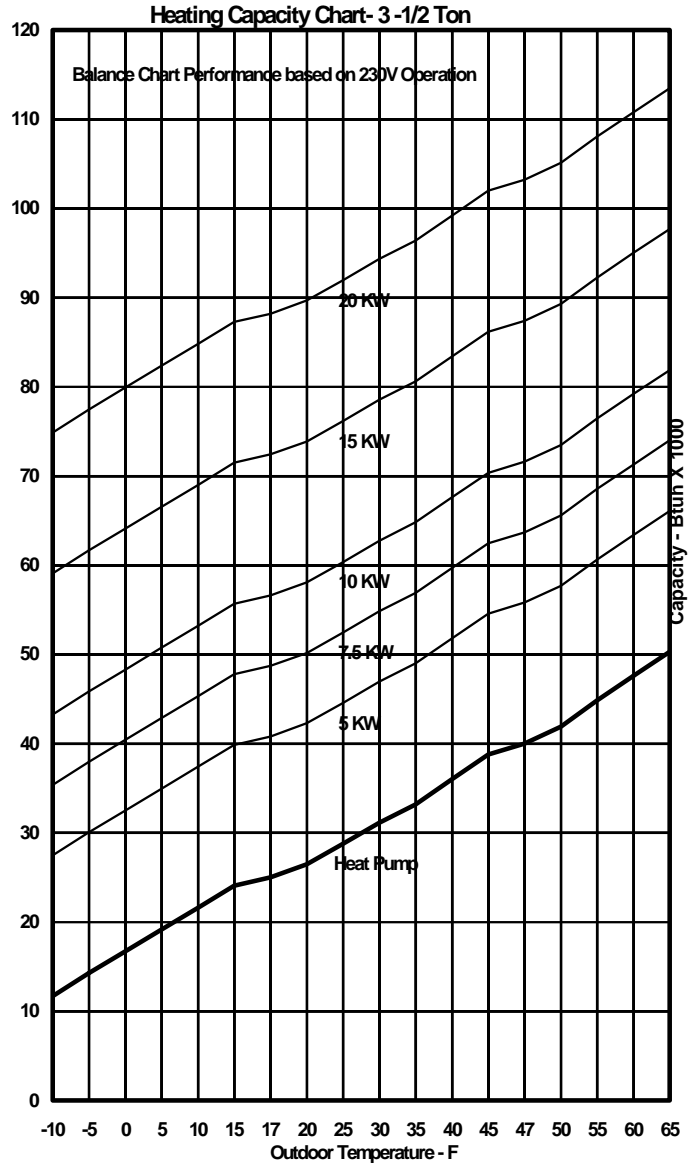
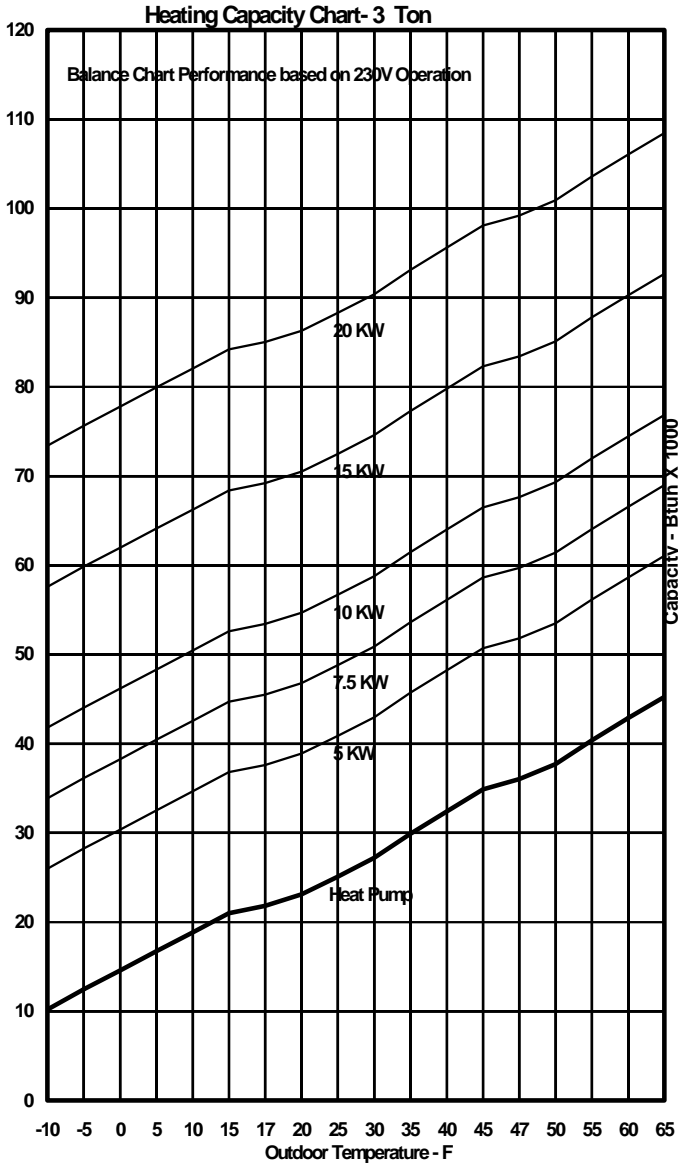

CHC & HCC SERIES HEAT PUMPS, 3 PHASE

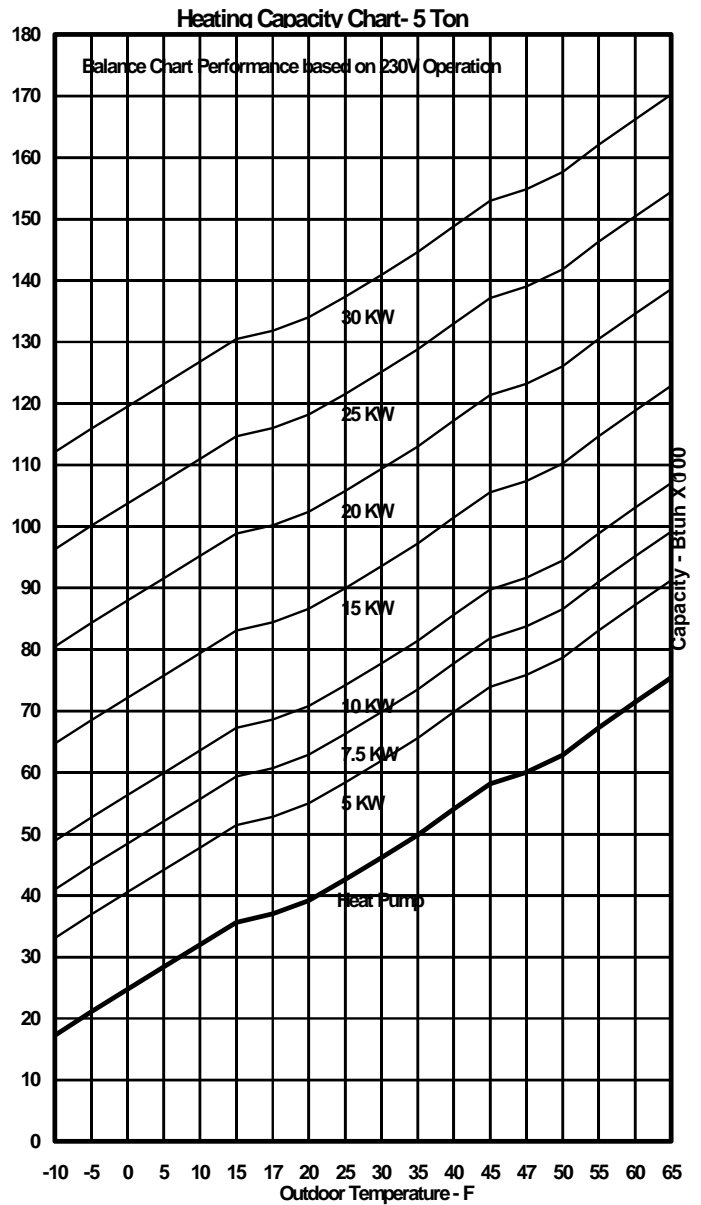
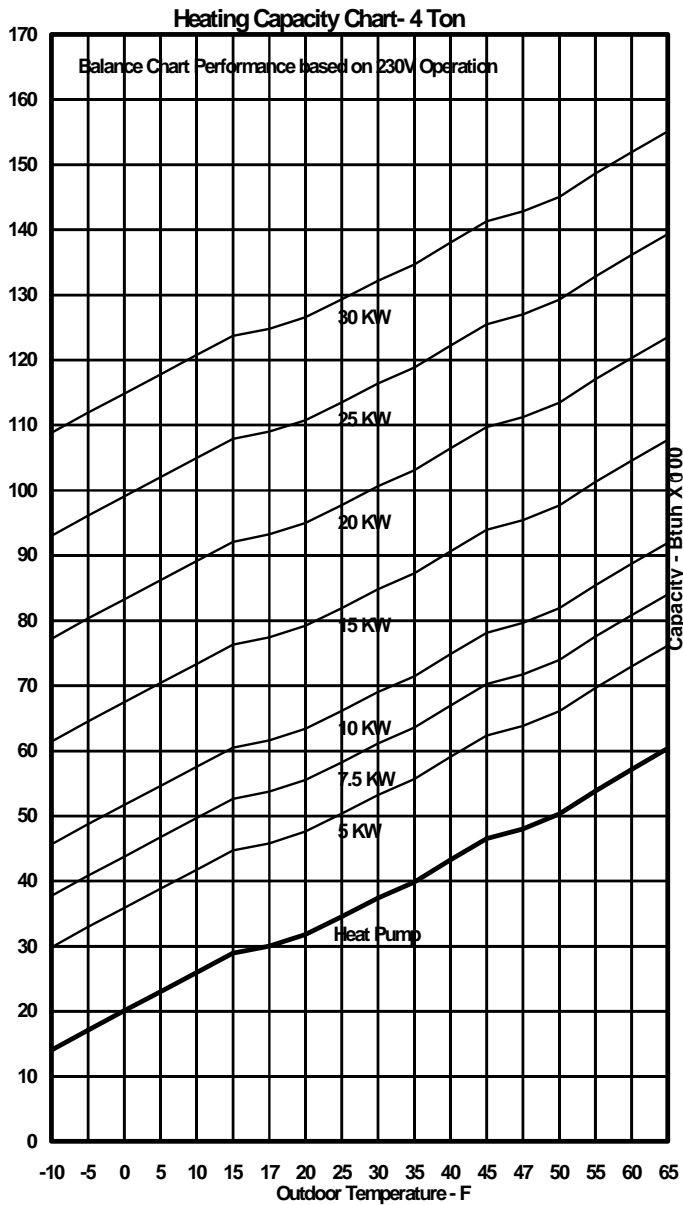

CHC & HCC SERIES HEAT PUMPS, 3 PHASE

208/230 Volt Models

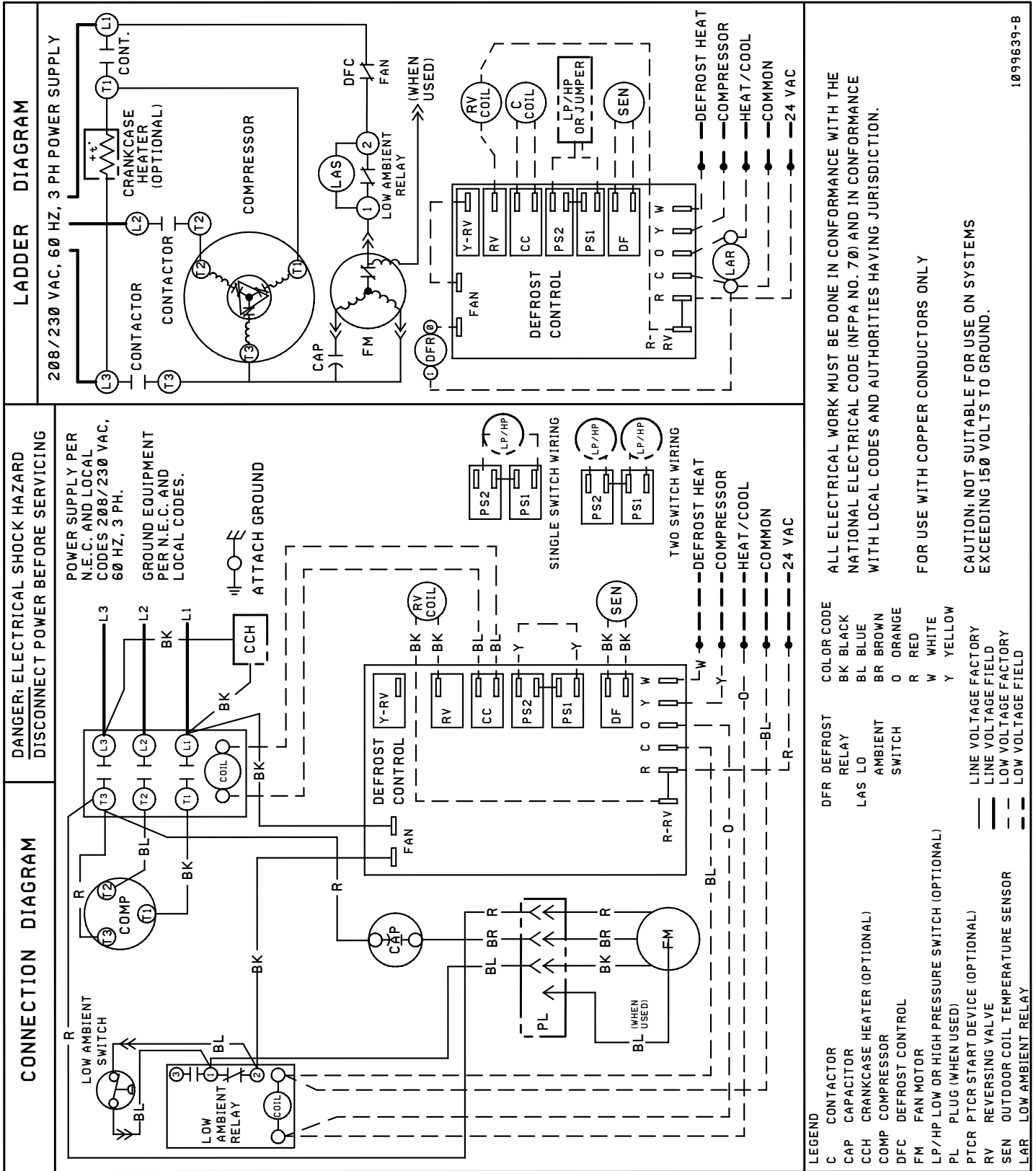

CHC & HCC SERIES HEAT PUMPS, 3 PHASE

460 & 575 Volt Models

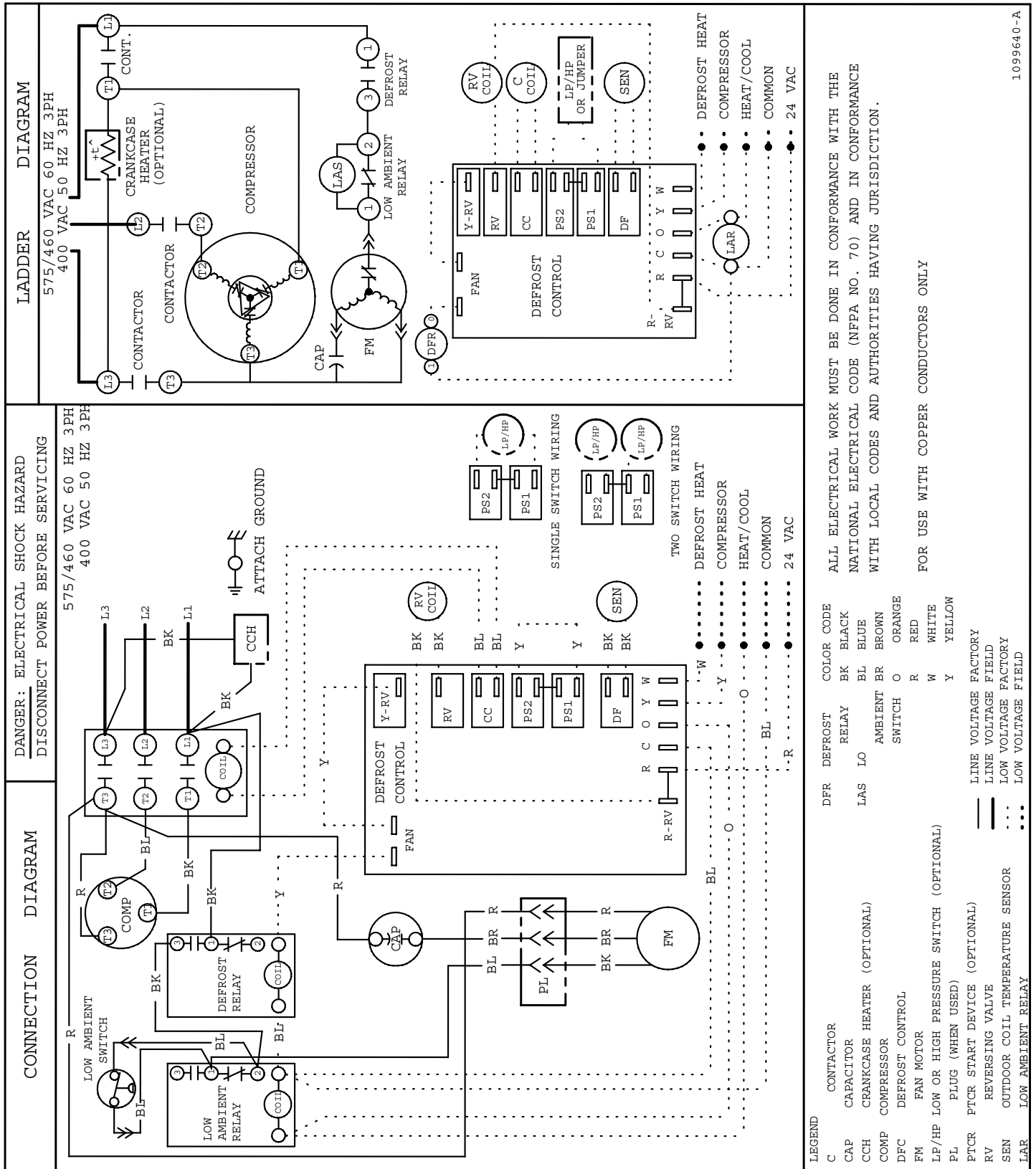

ALL ELECTRICAL WORK MUST BE DONE IN CONFORMANCE WITH THE NATIONAL ELECTRICAL CODE (NFPA NO. 70) AND IN CONFORMANCE WITH LOCAL CODES AND AUTHORITIES HAVING JURISDICTION.

FOR USE WITH COPPER CONDUCTORS ONLY

1099640-A