

INSTALLATION INSTRUCTIONS:

MICRO BUMPER TO UNIT:

1. INSTALL ITEM 6 (BUMPER BRACKET) ONTO FRAME USING ITEM 1 (NUT, LOCK), ITEM 2 (WASHER, FLAT) AND ITEM 3 (BOLT) TO FRAME MOUNTING ANGLES.
2. OPEN MICRO DOOR AND LOCATE MOUNTING TABS ON BUMPER BRACKET. VERIFY THAT BUMPER IS LEVEL WITH BOTTOM OF UNIT. USING TAB HOLES AS GUIDES MARK FRAME MEMBER FOR RIVNUT INSTALLATION.
3. REMOVE BUMPER BRACKET FROM UNIT AND DRILL 2 17/32 DIA HOLES AND INSTALL ITEM 5 (RIVNUTS) INTO FRAME.

NOTICE:

ON UNITS EQUIPPED WITH STEALTH BOTTOM PANELS REMOVE EXISTING 1/4-20 RIVNUTS AND ENLARGE HOLES TO 17/32 DIA AND INSTALL ITEM 5 (5/16 RIVNUTS) INTO FRAME.

4. REINSTALL BUMPER BRACKET AND TORQUE HARDWARE AS FOLLOWS.
5/16 BOLTS 15 FT/LBS
1/2 BOLTS 65 FT/LBS

UNITS EQUIPPED WITH DATALINK OR LOW FUEL OPTION:

5. REMOVE DATALINK OR LOW FUEL LIGHT BRACKET FROM FRAME PRIOR TO INSTALLING BUMPER.
6. AFTER BUMPER INSTALLATION RELOCATE DATALINK OR LOW FUEL LIGHT BRACKETS TO NEW POSITION(S) AS SHOWN IN OPTIONS VIEW.

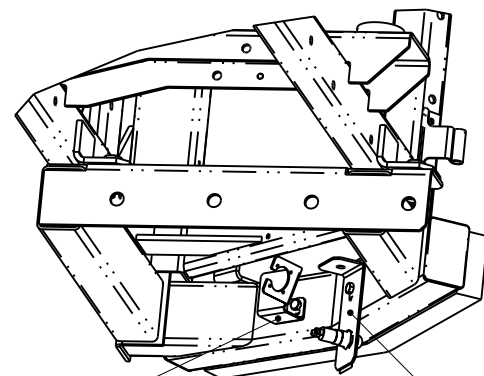
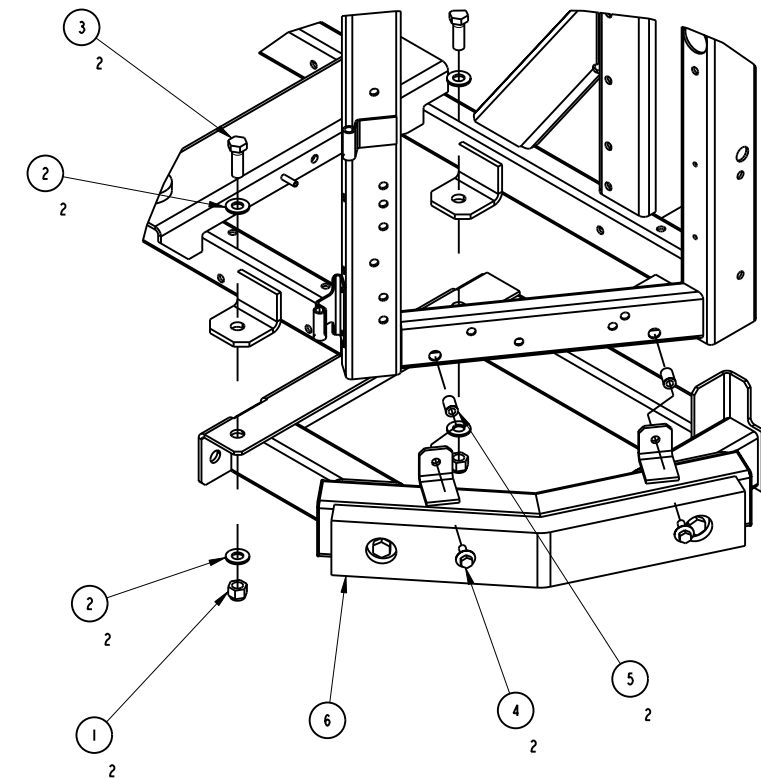
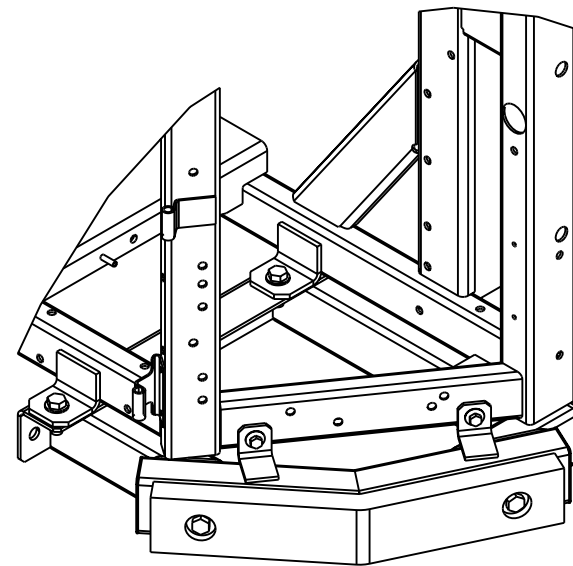

DATALINK BRACKET

LOW FUEL LIGHT BRACKET

OPTIONS VIEW

B	PICTORIALLY UPDATED IT.6.	AUG 23, 2004	ZMG			72N224GP04
A	REVISED INITIAL RELEASE.	4/30/01	ZMG			72N214GP01
I	PRELIMINARY RELEASE.	3/6/01	ZMG			72N214GP01
SYM	REVISION RECORD	DATE	BY	CHK'D	APP'D	AUTH NO.

SUPERSEDES

TITLE

INSTALLATION INSTRUCTIONS
STAND ALONE MICRO BUMPER

DRAWING NO. 98-03215
SHEET 1 OF 1

REV

B