



THIS DOCUMENT AND THE INFORMATION CONTAINED THEREIN IS PROPRIETARY TO CARRIER CORPORATION AND SHALL NOT BE USED OR DISCLOSED TO OTHERS, IN WHOLE OR IN PART, WITHOUT THE WRITTEN AUTHORIZATION OF CARRIER CORPORATION.

SUBMISSION OF THESE DRAWINGS OR DOCUMENTS  
DOES NOT CONSTITUTE PART PERFORMANCE OR  
ACCEPTANCE OF CONTRACT

CTD KIT PART NUMBER	DESCRIPTION	SEE SHEET NUMBER	U.S. ECCN
76-02138-00	SUPRA 950 / 960 (SINGLE TEMP.)	1, 2, 3 AND 4	EAR99
76-02138-01	SUPRA 950-M/T (MULTI-TEMP.)	1, 2, 3, 5 AND 6	

1. RECLAIM / EVACUATE R-404A REFRIGERANT
2. REMOVE AND REPLACE WITH NEW FILTER DRIER (ITEM 5) (SEE SHEET 2 FOR LOCATION)
3. PLACE THE FOLLOWING REQUIRED R-452A DECALS ON UNIT. ANY DECAL REFERENCE TO R-404A REFRIGERANT MUST BE REMOVED OR COVERED WITH REQUIRED R-452A DECAL PLACED OVER EXISTING R-404A DECAL(S). CLEAN EXISTING SURFACES WHERE LABELS ARE TO BE PLACED TO ENSURE GOOD ADHESION.
  - a. "FIGURE A" R452A CONVERSION DECAL (ITEM 15 REF.):
    - I. PLACE DECAL NEAR EXISTING NAME PLATE (REF ILLUSTRATIONS ON SHEET 2).
    - II. 950 MULTI-TEMP UNITS ONLY: PLACE 1 DECAL NEAR EXISTING NAMEPLATE ON EACH REMOTE EVAPORATORS,
    - III. WITH PERMANENT MARKER RECORD R-452A CONVERSION DATE ON DECAL. (IMPORTANT FOR REGISTRATION)
  - b. R-452A REFRIGERANT DECAL
    - I. "FIGURE B" DECAL (ITEM 10 REF.): PLACE ONE (1) DECAL ON TOP OF THE CONTROL BOX (REF ILLUSTRATIONS ON SHEET 2).
    - II. "FIGURE C" DECAL (ITEM 20 REF.): PLACE ONE (1) DECAL OVER EXISTING R-404A DECAL ON TOP OF THE CONTROL BOX.
    - III. "FIGURE D" DECAL (ITEM 30 REF.): 950 MULTI-TEMP UNITS ONLY: PLACE QUANTITY OF 1 DECAL ON PIPE END ON FRAME ON REMOTE EVAPORATORS.
  - c. "FIGURE E" REFRIGERANT EXPLOSION DECAL (ITEM 25 REF.):
    - I. PLACE ONE (1) DECAL OVER EXISTING DECAL ON CENTER CROSS MEMBER (REF ILLUSTRATIONS ON SHEET 2).
    - II. PLACE ONE (1) DECAL OVER EXISTING DECAL ON TOP OF THE CONTROL BOX (REF ILLUSTRATIONS ON SHEET 2).
    - III. 950 MULTI-TEMP UNITS ONLY: PLACE QUANTITY OF 1 DECAL ON INSIDE GRILL ON EACH REMOTE EVAPORATORS (REF. ILLUSTRATIONS ON SHEET 3 AND 4).

4. SUPRA 960 ONLY: REPLACE THE TXV. SEE SHEET 4
5. CHARGE SYSTEM WITH R-452A REFRIGERANT REFERENCING THE UNIT NAME PLATE FOR REFRIGERANT CHARGE AMOUNT.
6. CHECK AND RE-ADJUST THE THERMODYNAMIC EXPANSION VALVE(S) (TXV) ON THE HOST UNIT (SINGLE TEMP) OR REMOTE EVAPORATORS (MULTI-TEMP) IN ORDER TO BE COMPLIANT WITH THE SUPERHEAT VALUES ACCORDING TO THE "TXV ADJUSTMENTS INSTRUCTIONS" SECTION.
7. WHEN CARRYING OUT THIS R-452A REFRIGERANT CONVERSION KIT INSTRUCTION, PROCEDURE AND /OR ANY RELATED R-452A REFRIGERANT POLICY LAID OUT BY THE MANUFACTURER, ONE MUST STRICTLY ADHERE TO THE PRODUCT SERVICE MANUAL, AND THESE INSTRUCTIONS.

1. REFER TO PRODUCT TECHNICAL SERVICE MANUAL FOR FURTHER SPECIFIC DETAILED INSTRUCTION.
2. DO NOT CHARGE SYSTEM WITH A MIXTURE OF R-404A REFRIGERANT AND R-452A REFRIGERANT.
3. ANY DECAL REFERENCE TO R-404A REFRIGERANT ON PRODUCTS CONVERTED TO R-452A REFRIGERANT COVERED WITH REQUIRED R-452A DECAL PLACED OVER EXISTING R-404A DECAL(S).
4. SPECIAL CARE IS REQUIRED WHEN RECLAIMING R-452A REFRIGERANT. (REFER TO PRODUCT SERVICE MANUAL FOR FURTHER INSTRUCTIONS).
5. IN ORDER TO BE COMPLIANT WITH AHRI RULES, IT IS RECOMMENDED TO CHECK WITH YOUR LOCAL AGENCY IF ANY PROCEDURES EXIST TO DECLARE THE CONVERSION (CHANGE OF REFRIGERANT).

COMPARTMENT TEMPERATURE	SUPERHEAT SETTING
32°F (0°C)	12-14°F (7-8°C)
0°F (-18°C)	8-10°F (5-6°C)

NOTE: FOR MULTI-TEMP UNITS MAKE SURE ONLY ONE EVAPORATOR IS OPERATING AT A TIME AND IN THE COOL MODE.

- 1) LOOSEN INSULATING WRAP AROUND TXV SENSING BULB AND INSERT A THERMOCOUPLE TO THE SUCTION LINE AS CLOSE AS POSSIBLE TO THE TXV SENSING BULB, REINSTALL INSULATING WRAP.
- 2) ATTACH A SUCTION GAUGE TO THE ACCESS PORT ON THE EVAPORATOR OUTLET LINE.
- 3) RUN THE UNIT, IN THE COOL MODE, WITH A SET POINT OF 0°F (-18°C). UNIT SHOULD BE OPERATED IN THIS MODE FOR A MINIMUM OF 20 MINUTES.
- 4) WHEN COMPARTMENT TEMPERATURE REACHES 32°F (0°C). RECORD SUCTION PRESSURE AND TEMPERATURE OF EVAPORATOR OUTLET LINE A MINIMUM OF 5 TIMES APPROXIMATELY 5 MINUTES APART. TRY TO MAINTAIN THE BOX TEMPERATURE AS CLOSE TO 32°F (0°C) AS POSSIBLE WHEN ENTERING AND EXITING THE COMPARTMENT.
- 5) USING A P/T (PRESSURE/TEMPERATURE) CHART, CONVERT THE SUCTION PRESSURE TO A SATURATION TEMPERATURE FOR EACH OF THE READINGS TAKEN ABOVE.
- 6) SUBTRACT THE SATURATION TEMPERATURE FROM THE OUTLET LINE TEMPERATURE FOR EACH OF THE READINGS.
- 7) ADD THE SOLUTION FROM EACH READING TOGETHER AND DIVIDE BY THE NUMBER OF READINGS TAKEN. THIS WILL GIVE YOU THE AVERAGE SUPERHEAT SETTING OF THE TXV.
- 8) IF THE SUPERHEAT SETTING IS HIGHER OR LOWER THAN REQUIRED, USING THE ADJUSTING SCREW ON THE SIDE OF THE TXV, TO DECREASE SUPER HEAT, TURN THE SCREW COUNTER-CLOCKWISE; TO INCREASE SUPERHEAT, TURN IT CLOCKWISE. ADJUSTING SCREW SHOULD NOT BE ADJUSTED MORE THAN ¼ TURN AT A TIME.
- 9) RUN UNIT THROUGH DEFROST AND UPON COMPLETION ALLOW THE UNIT TO RUN IN THE COOL MODE FOR 20 TO 30 MINUTES AND REPEAT STEPS 4 THROUGH 7 UNTIL DESIRED SETTING IS REACHED.
- 10) REMOVE THERMOCOUPLE FROM EVAPORATOR OUTLET LINE AND REINSULATE THE TXV SENSING BULB. REMOVE THE SUCTION GAUGE FROM THE SERVICE PORT AND REINSTALL THE ¼ FLARE CAP. REINSTALL THE CAP OVER THE ADJUSTING SCREW.

SHEET INDEX	REV	<b>A</b>	A	A	A	A	A
	SHEET	1	2	3	4	5	6

A	INITIAL RELEASE	16 FEB 2021	MGC			ECN1141348		IMPERIAL INCH FORMAT: UNLESS OTHERWISE SPECIFIED DIMENSIONS ARE IN INCHES WITH METRIC CONVERSIONS IN [MILLIMETERS]	TITLE  INSTRUCTION REFRIGERANT R404a TO R452a CONVERSION	DRAWING NO.  98-03406  SHEET 1 of 6	REV  A
SYM	REVISION RECORD	DATE	BY	ENGR.	M.E.	NPCA NO.					

SUPERSEDES:

PART CLASSIFICATION: US SEE CHAR

DRAWING CLASSIFICATION: US SEE CHART



FIGURE A (ITEM 15 REF.)

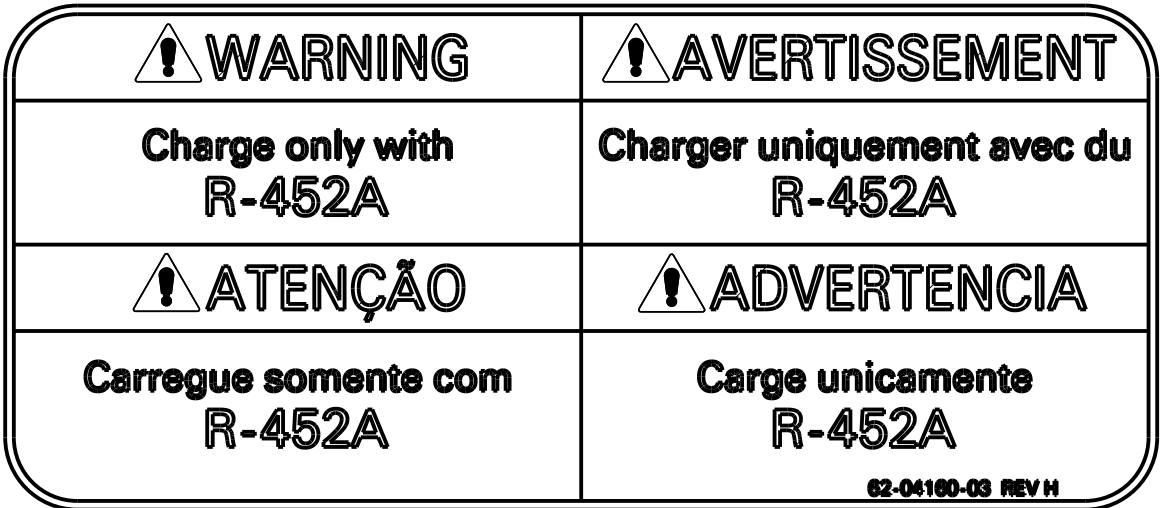

FIGURE C (HOST UNIT DECAL/  
ITEM 20 REF.)

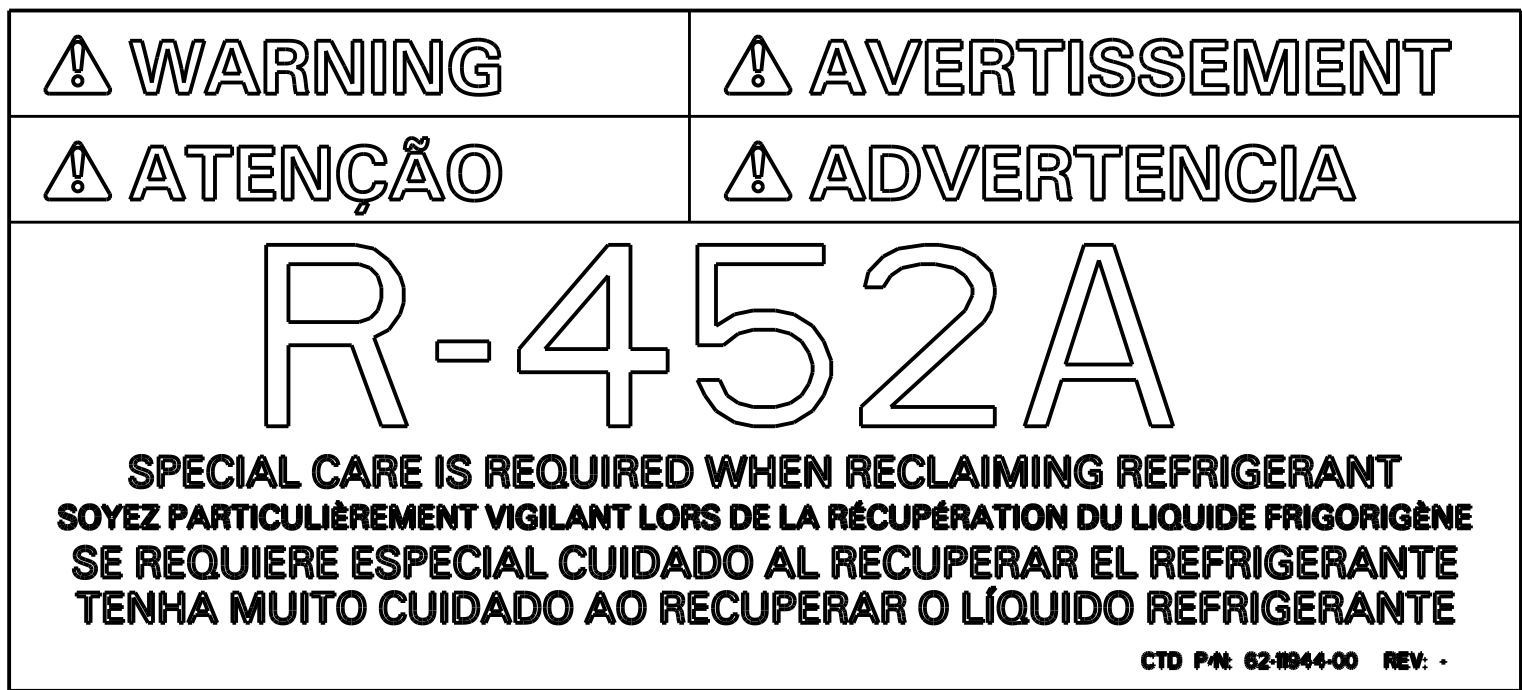

FIGURE B (ITEM 10 REF.)



FIGURE D (REMOTE EVAP. DECAL/  
ITEM 30 REF.)

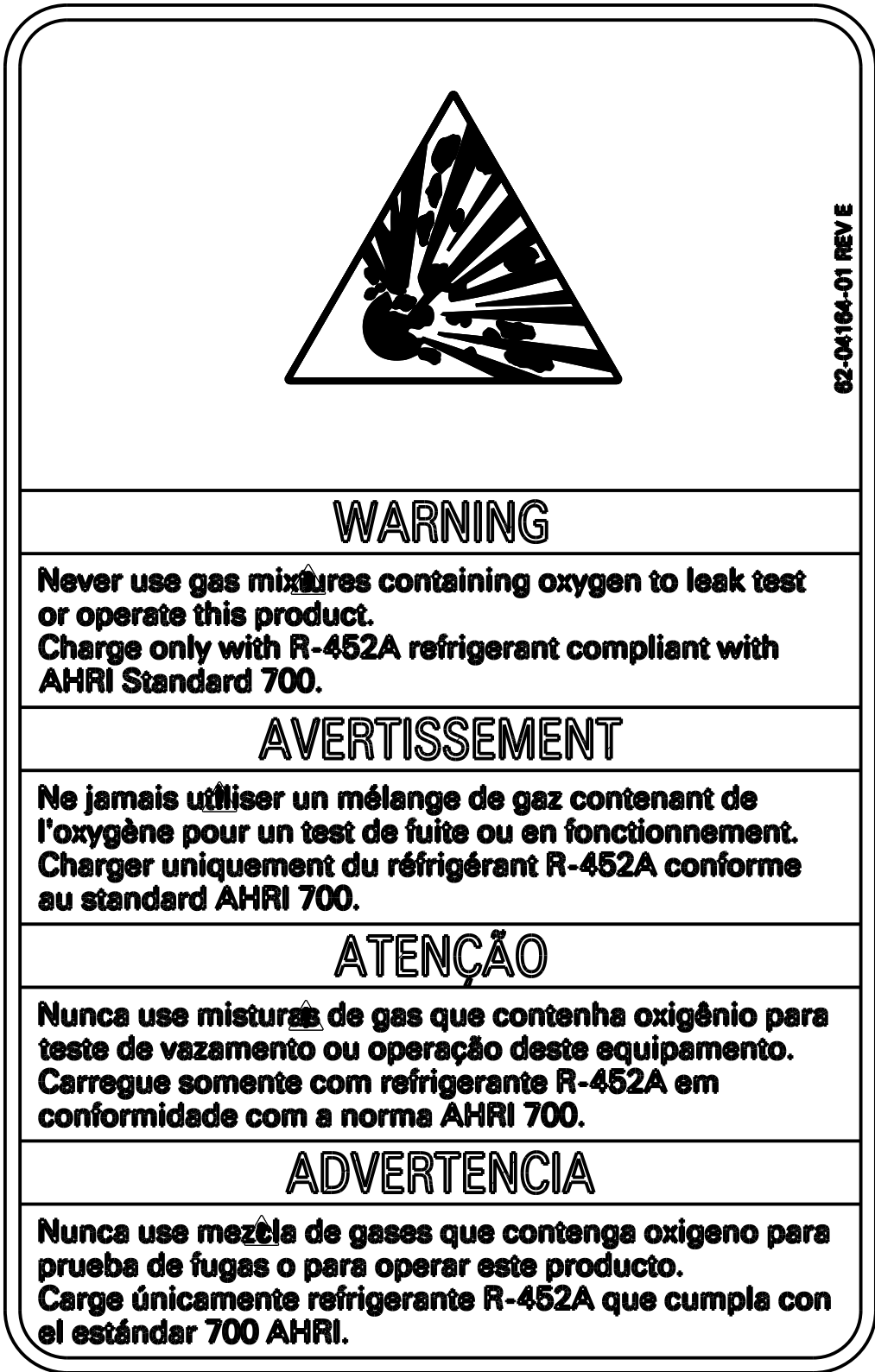
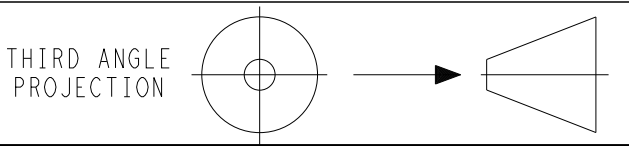

FIGURE E (ITEM 25 REF.)

DECAL IDENTIFICATION SHEET

A	INITIAL RELEASE	16 FEB 2021	MGC			ECN1141348
SYM	REVISION RECORD	DATE	BY	ENGR.	M.E.	NPCA NO.



IMPERIAL INCH FORMAT:  
UNLESS OTHERWISE SPECIFIED  
DIMENSIONS ARE IN INCHES WITH  
METRIC CONVERSIONS IN [MILLIMETERS]

TITLE	INSTRUCTION
-------	-------------

DRAWING NO.	98-03406	REV	A
	SHEET 2 of 6		

SUPERSEDES: \_\_\_\_\_

PART CLASSIFICATION: US SEE CHART

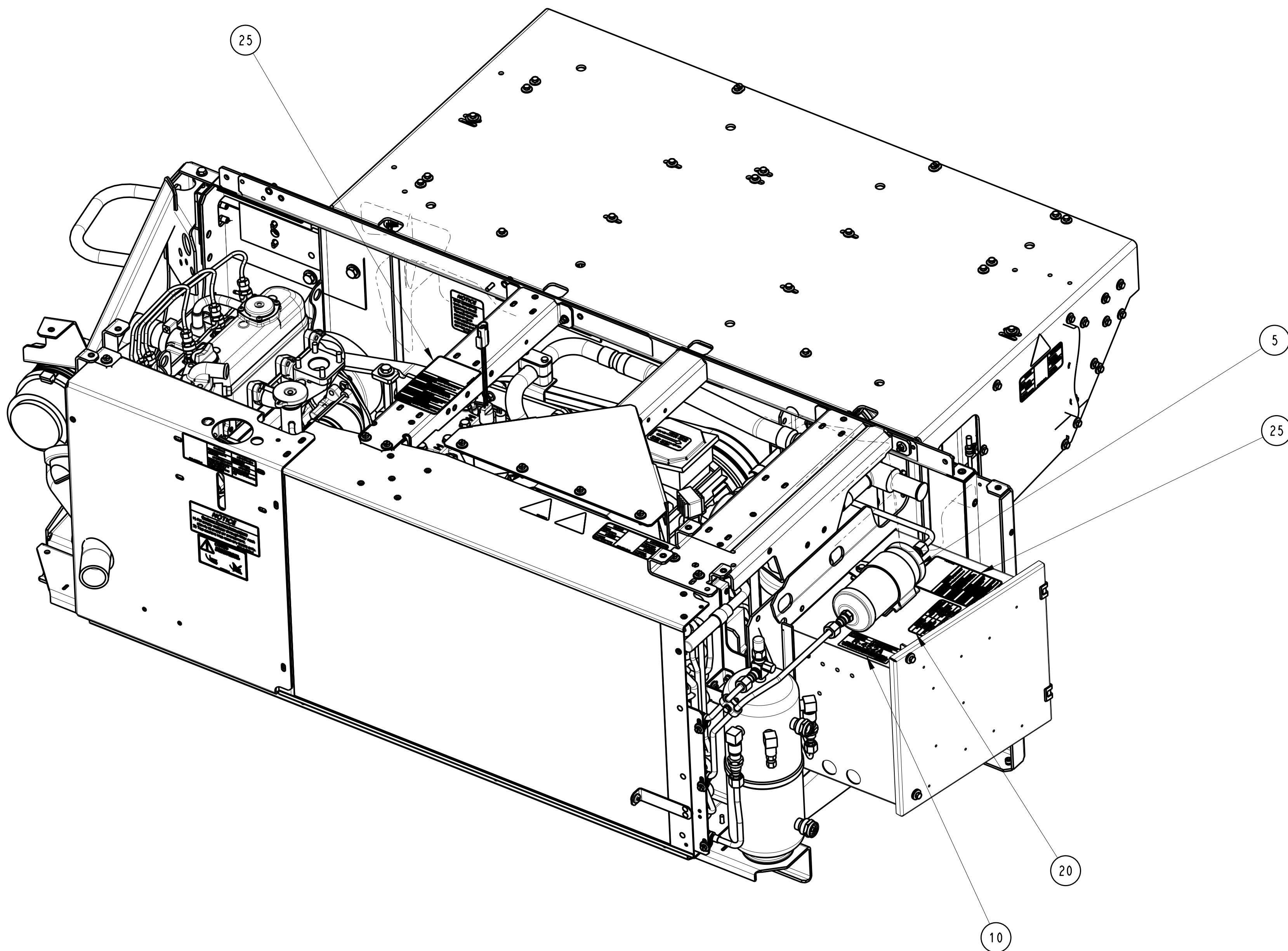
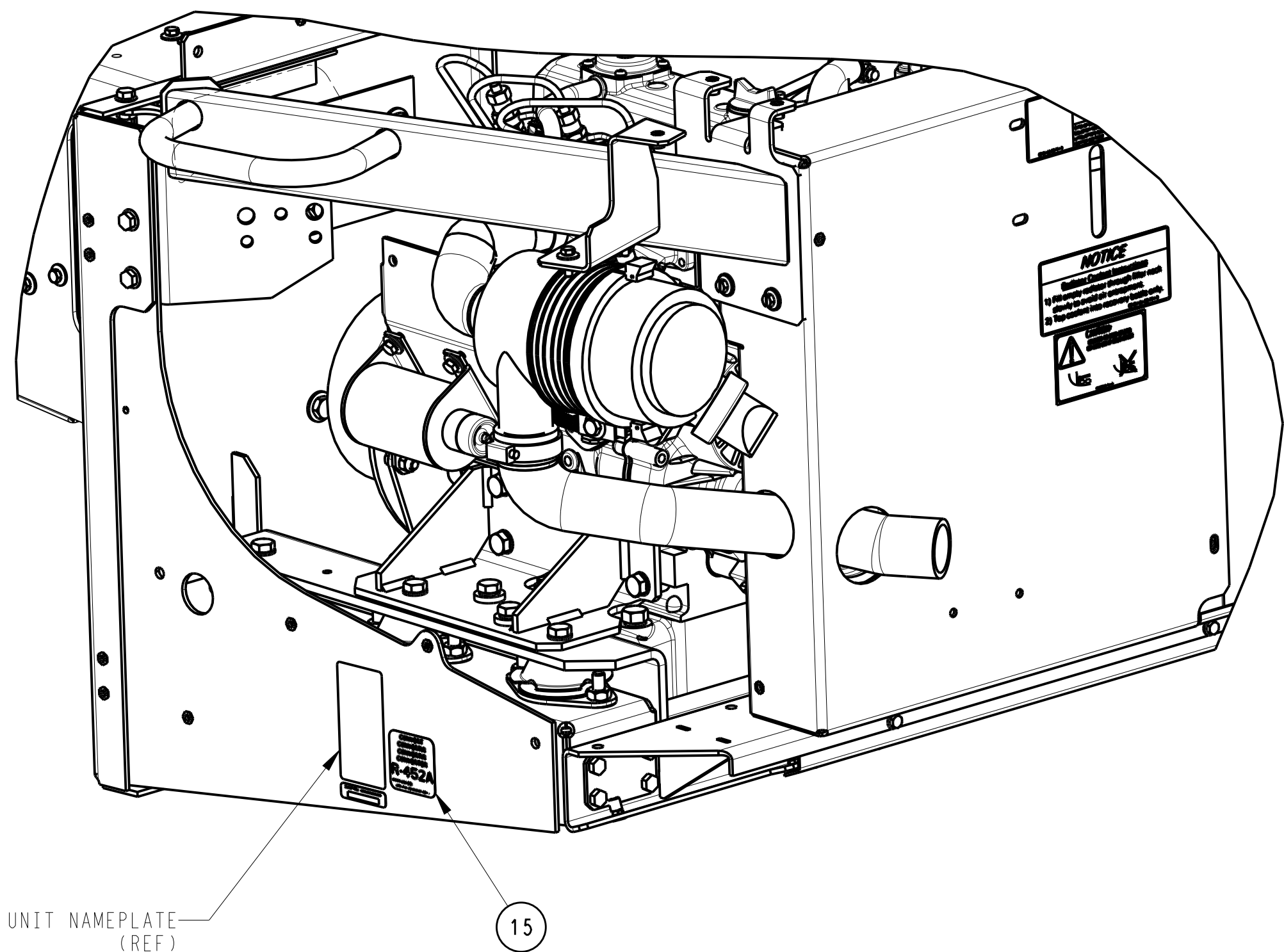

## UNIT DECAL LOCATIONS

(SUPRA 960-M/T & SUPRA 960 MODELS  
NOTE: SUPRA 960 SHOWN)

A	INITIAL RELEASE	16 FEB 2021	MGC			ECN1141348
SYM	REVISION RECORD	DATE	BY	ENGR.	M.E.	NPCA NO.

THIRD ANGLE  
PROJECTION



IMPERIAL INCH FORMAT:  
UNLESS OTHERWISE SPECIFIED  
DIMENSIONS ARE IN INCHES WITH  
METRIC CONVERSIONS IN [MILLIMETERS]

TITLE

INSTRUCTION - CONVERSION R-452A

DRAWING NO.

98-03406

SHEET 3 OF

REV

A

SUPERSEDES: \_\_\_\_\_

PART CLASSIFICATION: US SEE CHART

DRAWING CLASSIFICATION: US SEE CHART

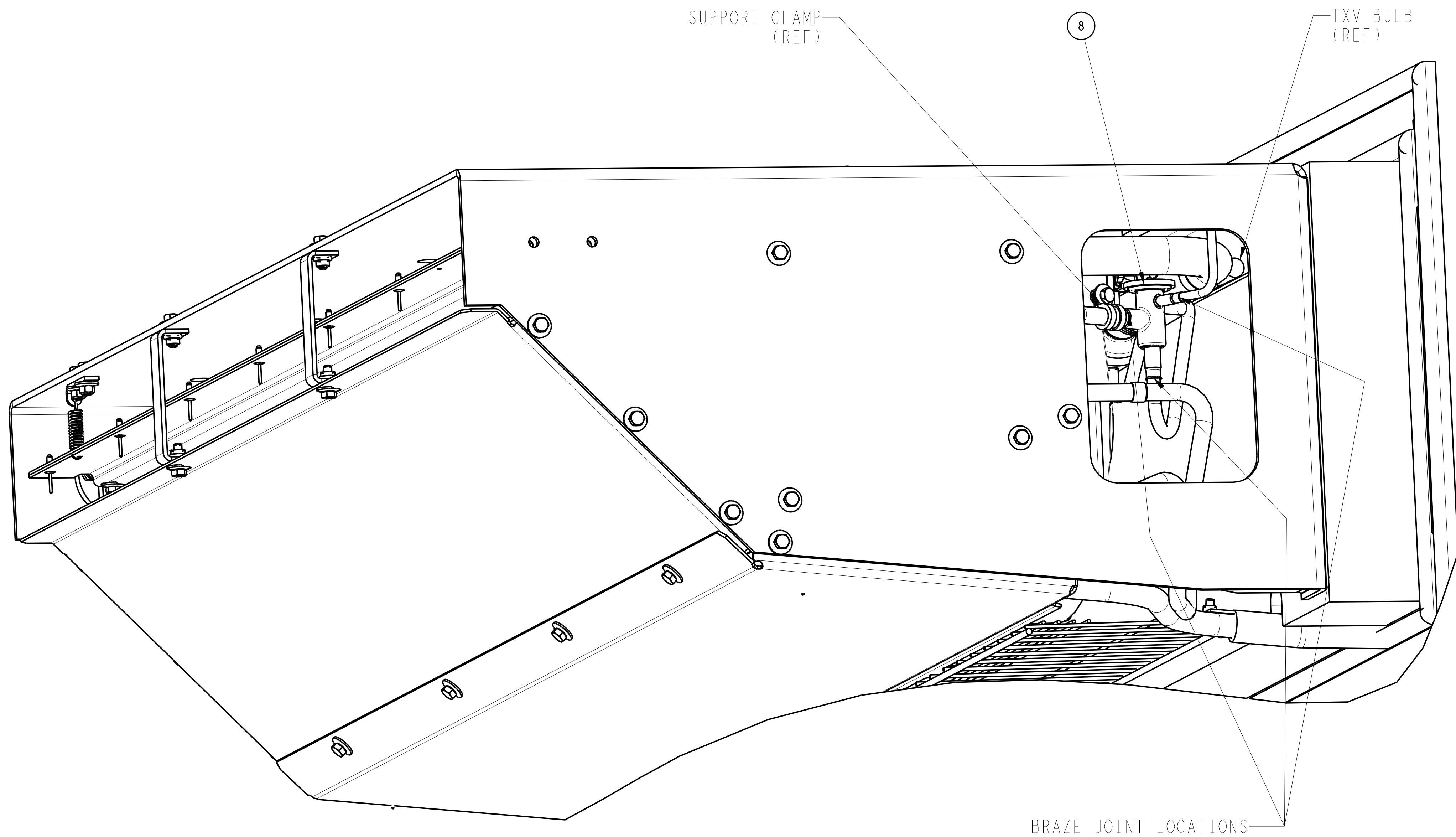

WARNING:

ENSURE THE REFRIGERANT HAS BEEN EVACUATED /  
RECLAIMED AND THE UNIT HAS NO REFRIGERANT CHARGE  
BEFORE PROCEEDING.

1. REMOVE CUSHION CLAMP SUPPORTING THE TXV.
2. REMOVE ALL PRESTITE FROM THE TXV AND THE TXV BULB.
3. NOTE THE POSITION OF THE TXV BULB AND THE BULB.  
UNBRAZE AND REMOVE THE TXV.
4. PREPARE THE THREE TUBES FOR RE-BRAZING BY CLEANING  
THE TUBE ENDS, INSTALL THE NEW TXV (ITEM 8) AND  
BRAZE THE TUBE JOINTS INTO THE NEW TXV.
5. INSTALL THE TXV BULB IN LOCATION THE OLD BULB WAS  
REMOVED FROM.
6. LEAK TEST THE SYTEM TO ASSURE THE BRAZE JOINTS ARE  
COMPLETE.
7. INSTALL NEW PRESTITE AROUND THE TXV BULB AND COILED  
CAPILLARY TUBE BEING CAREFUL NOT TO PINCH THE TUBE.
8. RE-INSTALL THE CUSHION CLAMP SUPPORTING THE TXV.
9. ON SHEET ONE, CONTINUE WITH PROCUDURE 5 LISTER UNDER  
"INSTRUCTIONS" HEADER.

960 TXV REPLACEMENT  
(SUPRA 960 MODELS ONLY)

A	INITIAL RELEASE	16 FEB 2021	MGC			ECN1141348
SYM	REVISION RECORD	DATE	BY	ENGR.	M.E.	NPCA NO.

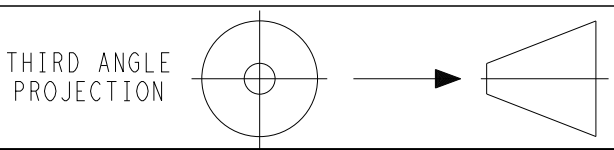

IMPERIAL INCH FORMAT:  
UNLESS OTHERWISE SPECIFIED  
DIMENSIONS ARE IN INCHES WITH  
METRIC CONVERSIONS IN [MILLIMETERS]

TITLE INSTRUCTION - CONVERSION R-452A

DRAWING NO. 98-03406  
SHEET 4 OF

REV  
A

SUPERSEDES: \_\_\_\_\_

PART CLASSIFICATION: US SEE CHART

DRAWING CLASSIFICATION: US SEE CHART



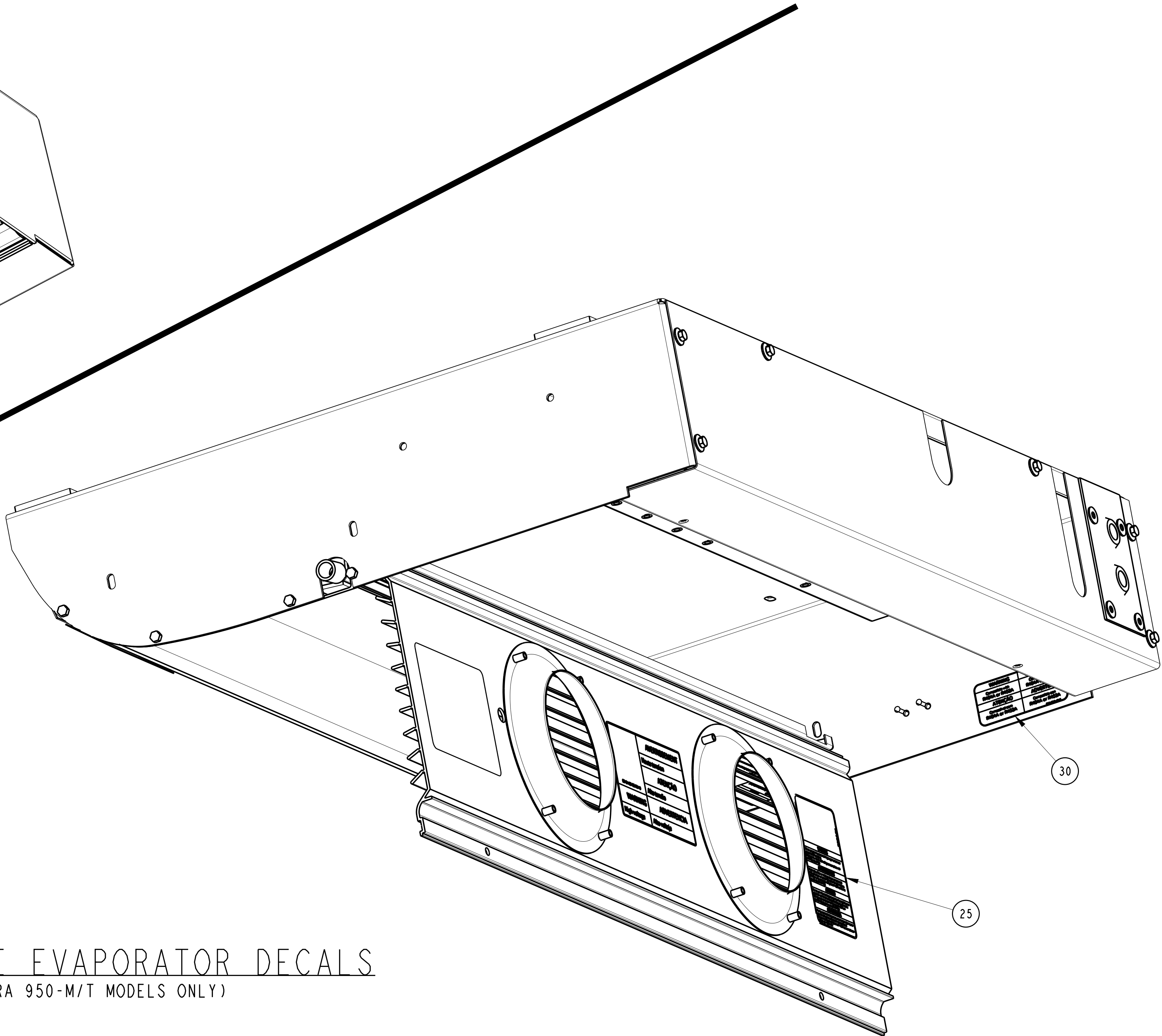
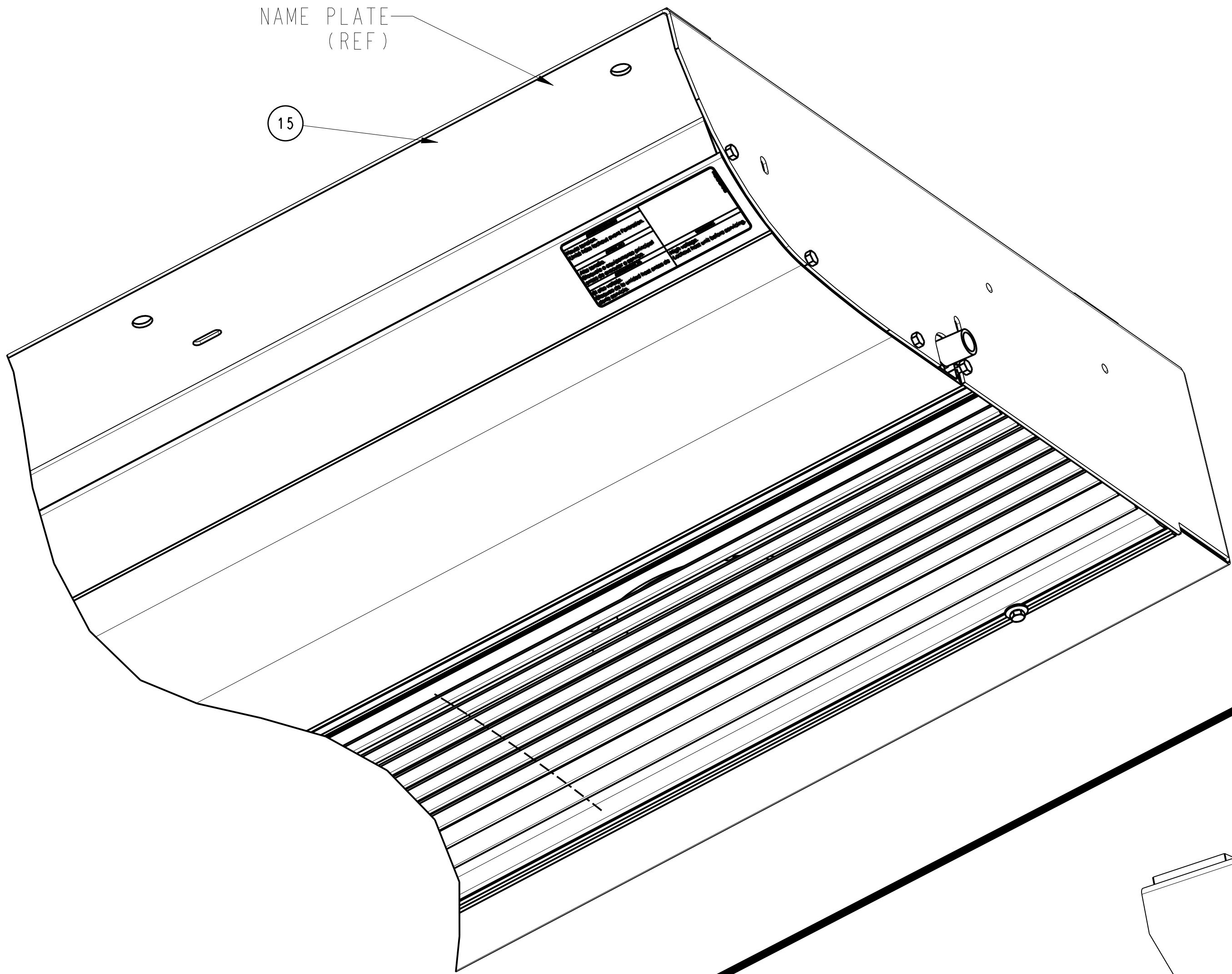

MTS REMOTE EVAPORATOR DECALS  
(SUPRA 950-M/T MODELS ONLY)

A	INITIAL RELEASE	16 FEB 2021	MGC			ECN1141348
SYM	REVISION RECORD	DATE	BY	ENGR.	M.E.	NPCA NO.

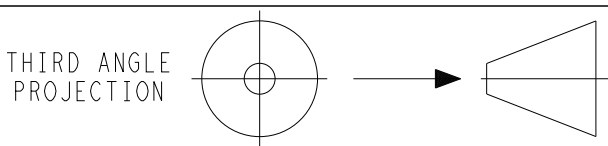

IMPERIAL INCH FORMAT:  
UNLESS OTHERWISE SPECIFIED  
DIMENSIONS ARE IN INCHES WITH  
METRIC CONVERSIONS IN [MILLIMETERS]

TITLE INSTRUCTION - CONVERSION R-452A

DRAWING NO.	REV
98-03406	A
SHEET 5 OF	

SUPERSEDES: \_\_\_\_\_

PART CLASSIFICATION: US SEE CHART

DRAWING CLASSIFICATION: US SEE CHART



Carrier Transicold Division  
Carrier Corporation  
P.O. Box 4805  
Syracuse, New York 13221

THIS DOCUMENT AND THE INFORMATION CONTAINED THEREIN IS  
PROPRIETARY TO CARRIER CORPORATION AND SHALL NOT BE USED  
OR DISCLOSED TO OTHERS, IN WHOLE OR IN PART, WITHOUT THE  
WRITTEN AUTHORIZATION OF CARRIER CORPORATION.

SUBMISSION OF THESE DRAWINGS OR DOCUMENTS  
DOES NOT CONSTITUTE PART PERFORMANCE OR  
ACCEPTANCE OF CONTRACT

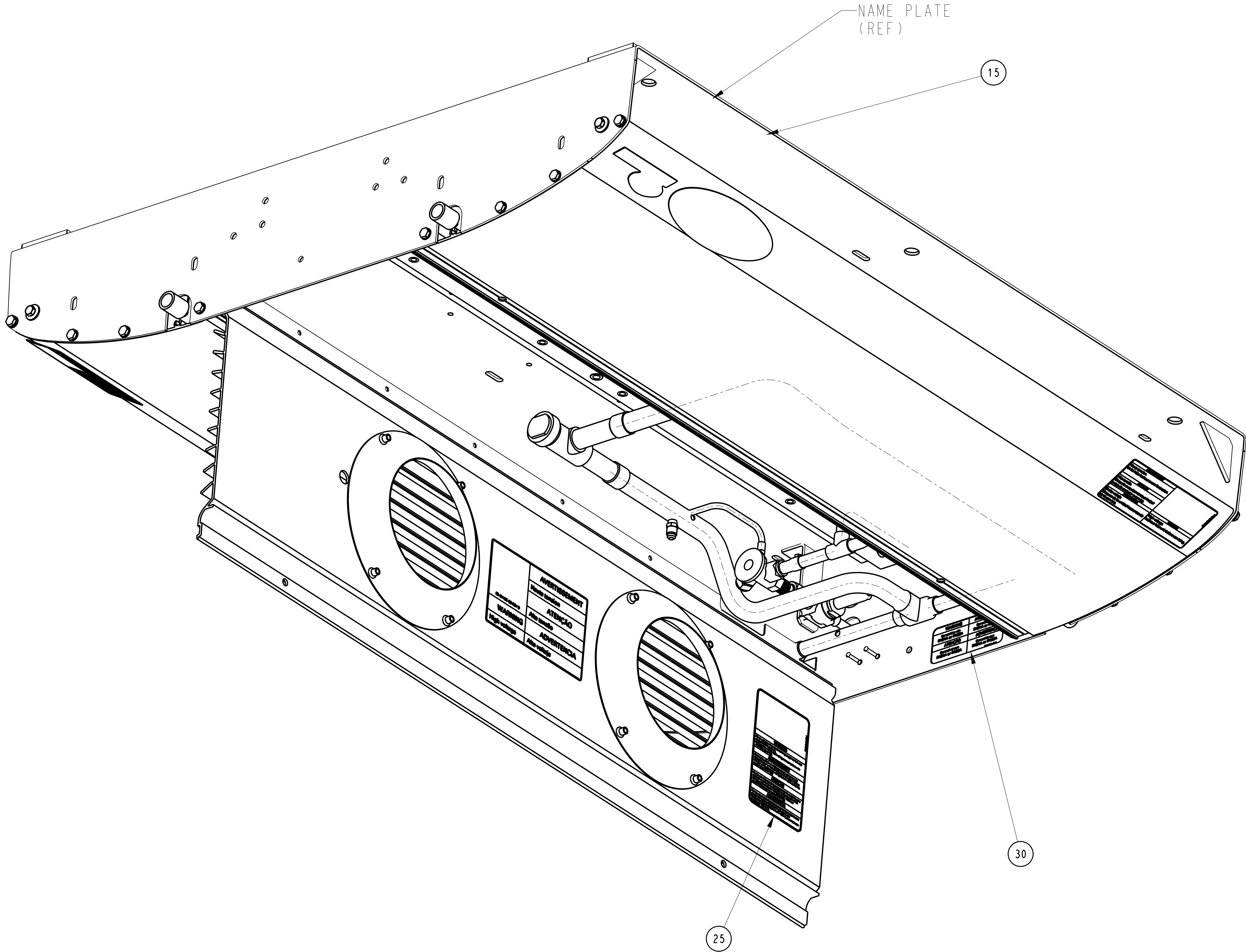

MTD REMOTE EVAPORATOR DECALS  
(SUPRA 950-M/T MODELS ONLY)

A	INITIAL RELEASE	16 FEB 2021	MGC			ECN1141348
SYM	REVISION RECORD	DATE	BY	ENGR.	M.E.	NPCA NO.

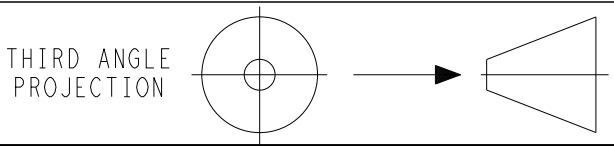

IMPERIAL INCH FORMAT:  
UNLESS OTHERWISE SPECIFIED  
DIMENSIONS ARE IN INCHES WITH  
METRIC CONVERSIONS IN [MILLIMETERS]

TITLE INSTRUCTION - CONVERSION R-452A

DRAWING NO.	98-03406	REV	A
	SHEET 6 OF		

SUPERSEDES:

PART CLASSIFICATION: US SEE CHART

DRAWING CLASSIFICATION: US SEE CHART