

STEP 1

REMOVE THE GRILLE. FIND & REMOVE 3 QTY. OF STAUFF CLAMP, WASHER & SCREW AT THE UPPER REAR SECTION OF THE UNIT. FIND & REMOVE 3 QTY. OF P-CLAMP & SCREW WITH CAPTIVE WASHER AT THE UPPER FRONT SECTION OF THE UNIT.

INSTRUCTIONS CONTENTS		SHEET
GENERAL INFORMATION & GRILLE REMOVAL		1
TOP PANEL SUPPORT ROD INSTALLATION		2
TOP PANEL INSTALLATION		3

SHEET INDEX	REV	A	A	A
	SHEET	1	2	3

A	MOVED INSTALLATION STEPS TO APPROPRIATE VIEWS; ADDED SHT.3, CONTENTS CHART, AND WARNING INFORMATION; SEE SHT's 2 & 3	31 AUG 2020	MGC			ECN1135359
-	INITIAL RELEASE.	12 JUL 2019	LT-SN	MGC		71N0211P19
SYM	REVISION RECORD	DATE	BY	ENGR.	M.E.	NPCA NO.

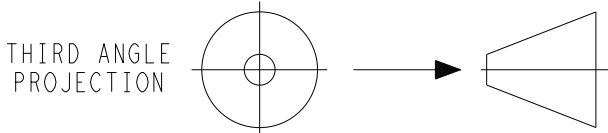

IMPERIAL INCH FORMAT:
UNLESS OTHERWISE SPECIFIED
DIMENSIONS ARE IN INCHES WITH
METRIC CONVERSIONS IN (MILLIMETERS)

TITLE
INSTALL INSTRUCTION. SNOW/RAIN COVER

DRAWING NO.
98-03383
SHEET 1 of 3

REV
A

SUPSEDES: _____

PART CLASSIFICATION: US EAR99

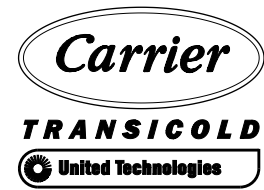

Carrier Transicold Division
Carrier Corporation
P.O. Box 4805
Syracuse, New York 13221

THIS DOCUMENT AND THE INFORMATION CONTAINED THEREIN IS
PROPRIETARY TO CARRIER CORPORATION AND SHALL NOT BE USED
OR DISCLOSED TO OTHERS, IN WHOLE OR IN PART, WITHOUT THE
WRITTEN AUTHORIZATION OF CARRIER CORPORATION.

SUBMISSION OF THESE DRAWINGS OR DOCUMENTS
DOES NOT CONSTITUTE PART PERFORMANCE OR
ACCEPTANCE OF CONTRACT

PART NO.

MODEL DESCRIPTION

KIT NUMBER
(REFERENCE)

98-03383-00

NATT SNOW/RAIN COVER
SUPRA S6, S7, S8, S9 & S10

76-02105-00



WARNING

READ ALL INSTRUCTIONS PRIOR TO INSTALLATION

- 1.0 SAFETY:
- 1.1 TOOLS: MAKE CERTAIN ALL TOOLS AND EQUIPMENT ARE APPROPRIATE FOR THE JOB BEING COMPLETED, AND ARE IN PROPER WORKING CONDITION.
- 1.2 PERSONAL PROTECTIVE EQUIPMENT (PPE): ALWAYS UTILIZE APPROPRIATE PERSONAL PROTECTIVE EQUIPEMENT THAT IS IN PROPER WORKING CONDITION. PERSONAL PROTECTIVE EQUIPMENT EXAMPLES INCLUDE, BUT IS NOT LIMITED TO THE ITEMS SHOWN BELOW.



- 2.3 RISKS: BE AWARE OF YOUR ENVIRONMENT AND SURROUNDINGS. FOLLOW ALL LOCK OUT / TAG OUT PROCEDURE ON ALL EQUIPMENT INVOLVED IN THIS PROCEDURE INCLUDING THE UNIT ITSELF AND ALL EXTERNAL POWER AND/OR FUEL SOURCES.

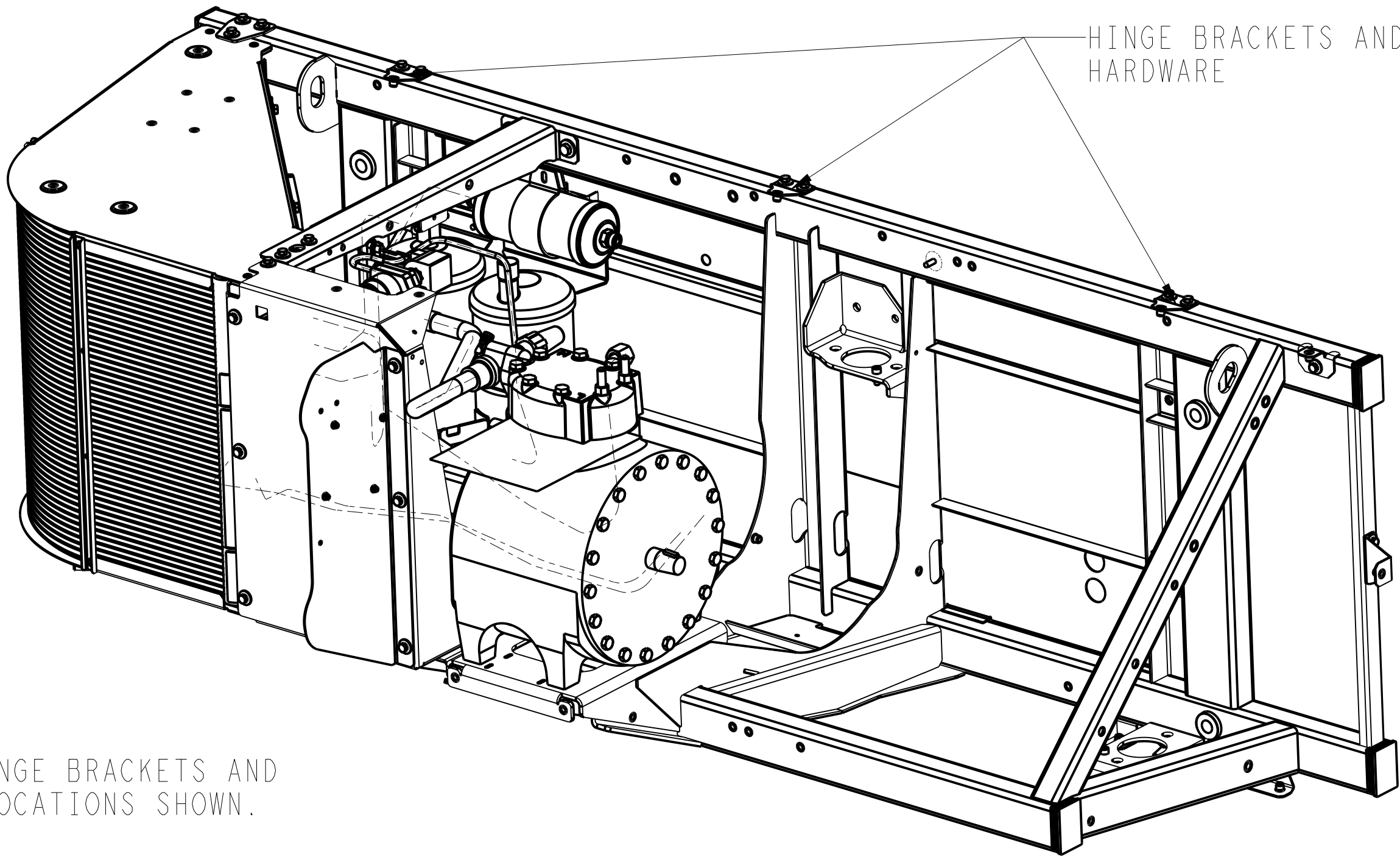

STEP 2

REMOVE THE HINGE BRACKETS AND
HARDWARE AT LOCATIONS SHOWN.

SEE SEPARATE PARTS LIST

DRAWING CLASSIFICATION: US EAR99

STEP 3

ASSEMBLE ITEM #10 (RETAINING CLIP), #20 (SUPPORT ROD) &
#30 (CLIP) TO THE CONDENSER SUPPORT BRACKET AS SHOWN.

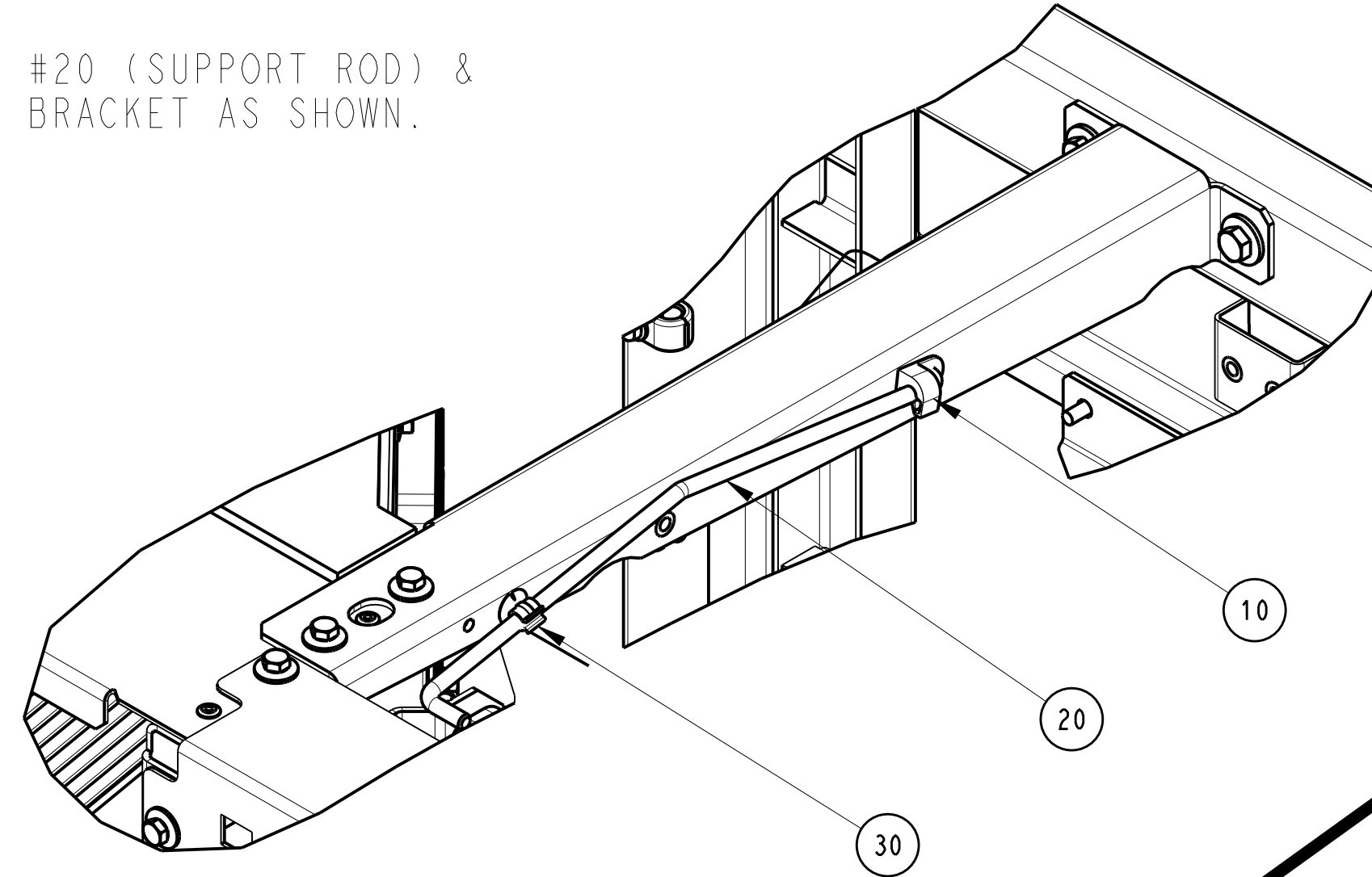

DETAIL A
SCALE 0.400

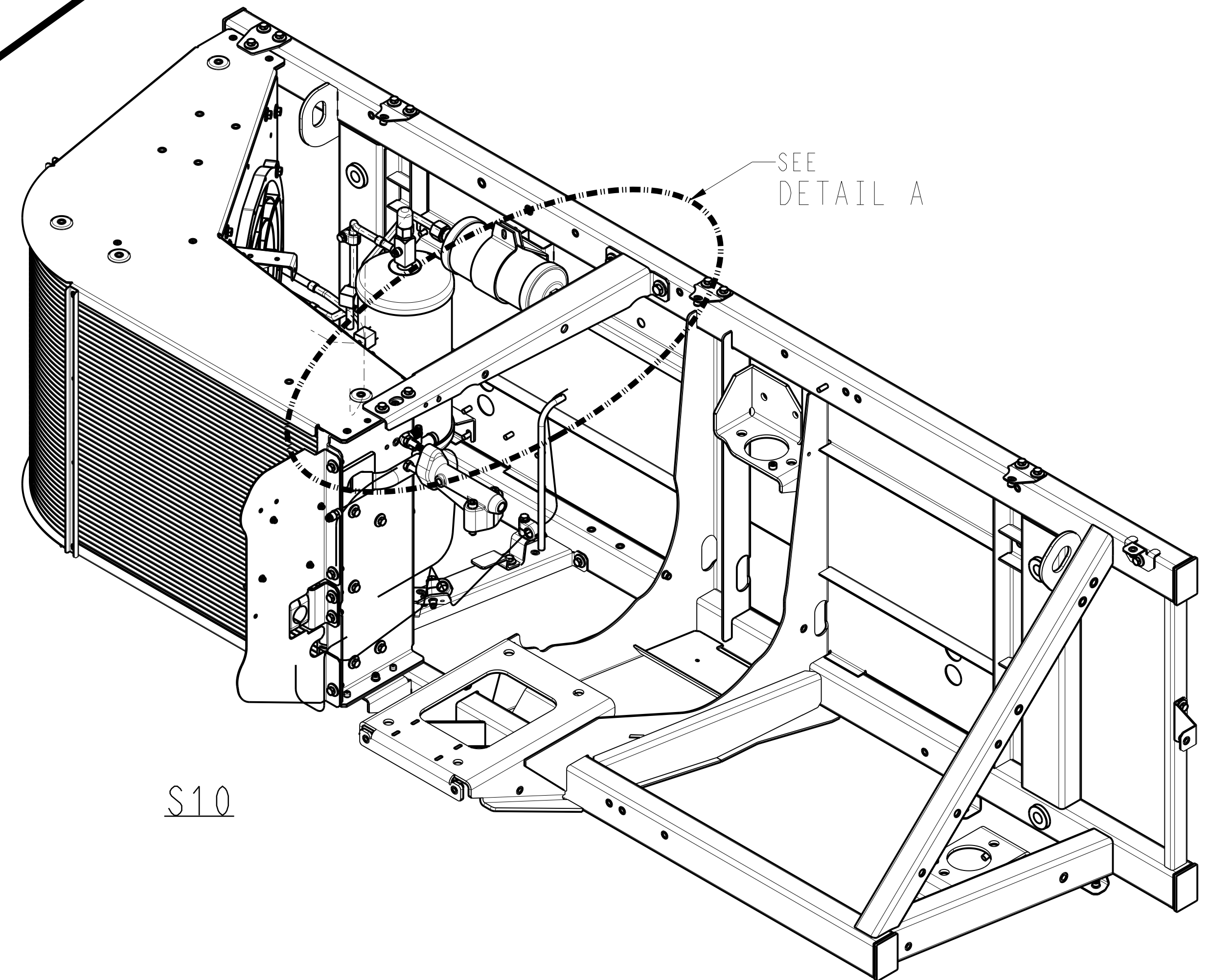
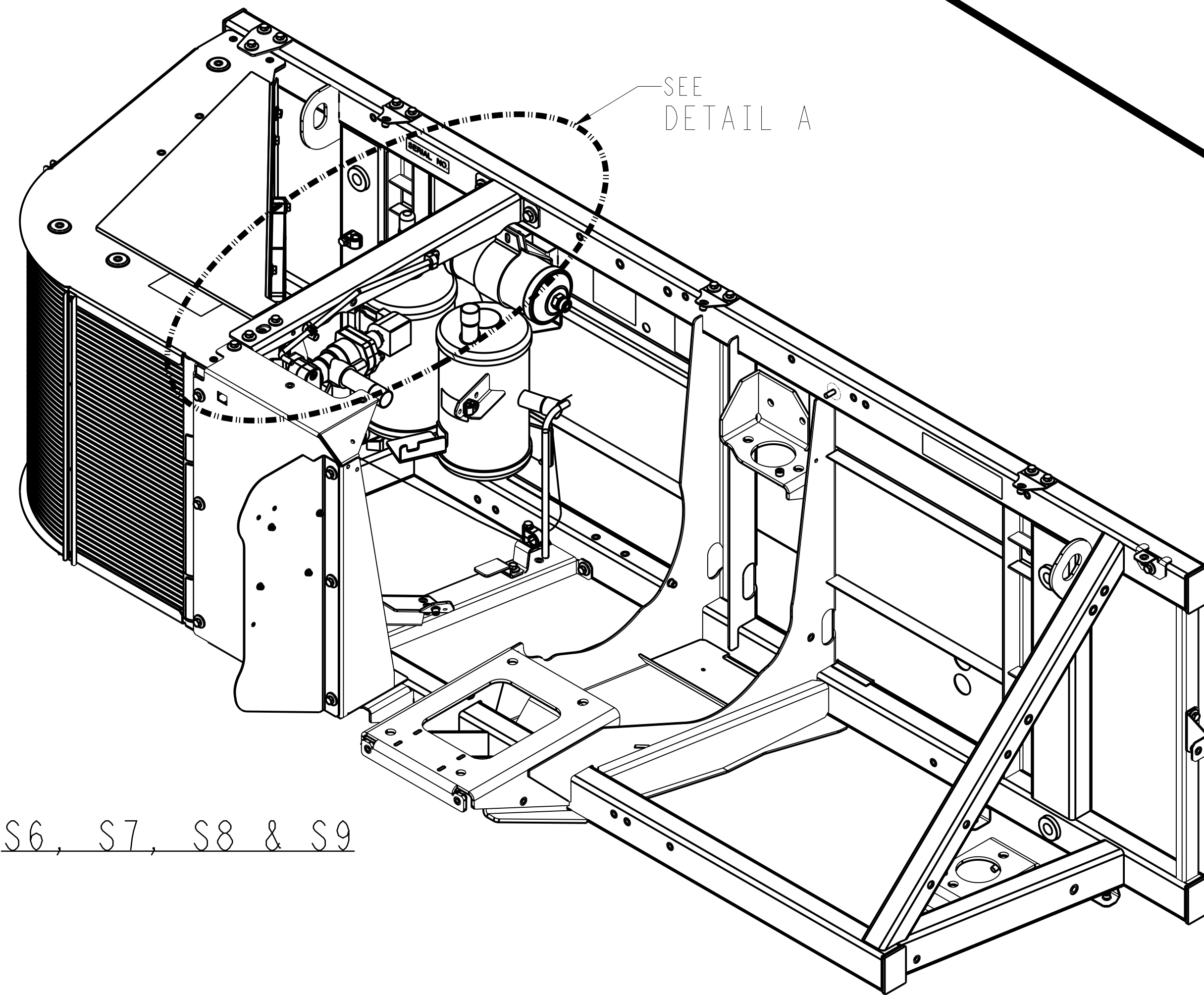

A	ADDED INSTALLATION PROCEDURE INFORMATION TO STEP 3 WAS SHOWN ON SHT.1; PICTURE ADDED S10; MOVED STEP 4 INFO. TO SHT.3(NEW SHT.)	13 AUG 2020	MGC			ECN1135359
-	INITIAL RELEASE.	12 JUL 2019	LT-SN	MGC		71N0211P19
SYM	REVISION RECORD	DATE	BY	ENGR.	M.E.	NPCA NO.

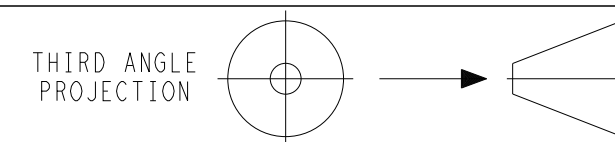

IMPERIAL INCH FORMAT:
UNLESS OTHERWISE SPECIFIED
DIMENSIONS ARE IN INCHES WITH
METRIC CONVERSIONS IN [MILLIMETERS]

TITLE
INSTALL INSTRUCTION. SNOW/RAIN COVER

DRAWING NO.	REV
98-03383	A
SHEET 2 OF	

SUPERSEDES: _____

PART CLASSIFICATION: US EAR99

FOR MODELS EQUIPED WITH eSOLUTIONS,
MOUNT THE ANTENNAAS SHOWN USING HARDWARE AND
GROMMET SUPPLIED WITH eSOLUTIONS
TORQUE HARDWARE TO 18 ±1.0 IN
[2.0 ± 0.1 Nm]

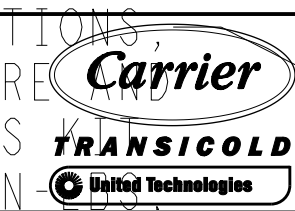

Carrier Transicold Division
Carrier Corporation
P.O. Box 4805
Syracuse, New York 13221

THIS DOCUMENT AND THE INFORMATION CONTAINED THEREIN IS
PROPRIETARY TO CARRIER CORPORATION AND SHALL NOT BE USED
OR DISCLOSED TO OTHERS, IN WHOLE OR IN PART, WITHOUT THE
WRITTEN AUTHORIZATION OF CARRIER CORPORATION.

SUBMISSION OF THESE DRAWINGS OR DOCUMENTS
DOES NOT CONSTITUTE PART PERFORMANCE OR
ACCEPTANCE OF CONTRACT

ASSEMBLE ITEM 40 (TOP PANEL)
TO THE UPPER REAR SECTION
OF THE UNIT BY USING
FLUSH HEAD SCREWS
SUPPLIED (QTY. 6)
TORQUE 6 ± 1 FT-LBS
[8.1 ±1.4 Nm]

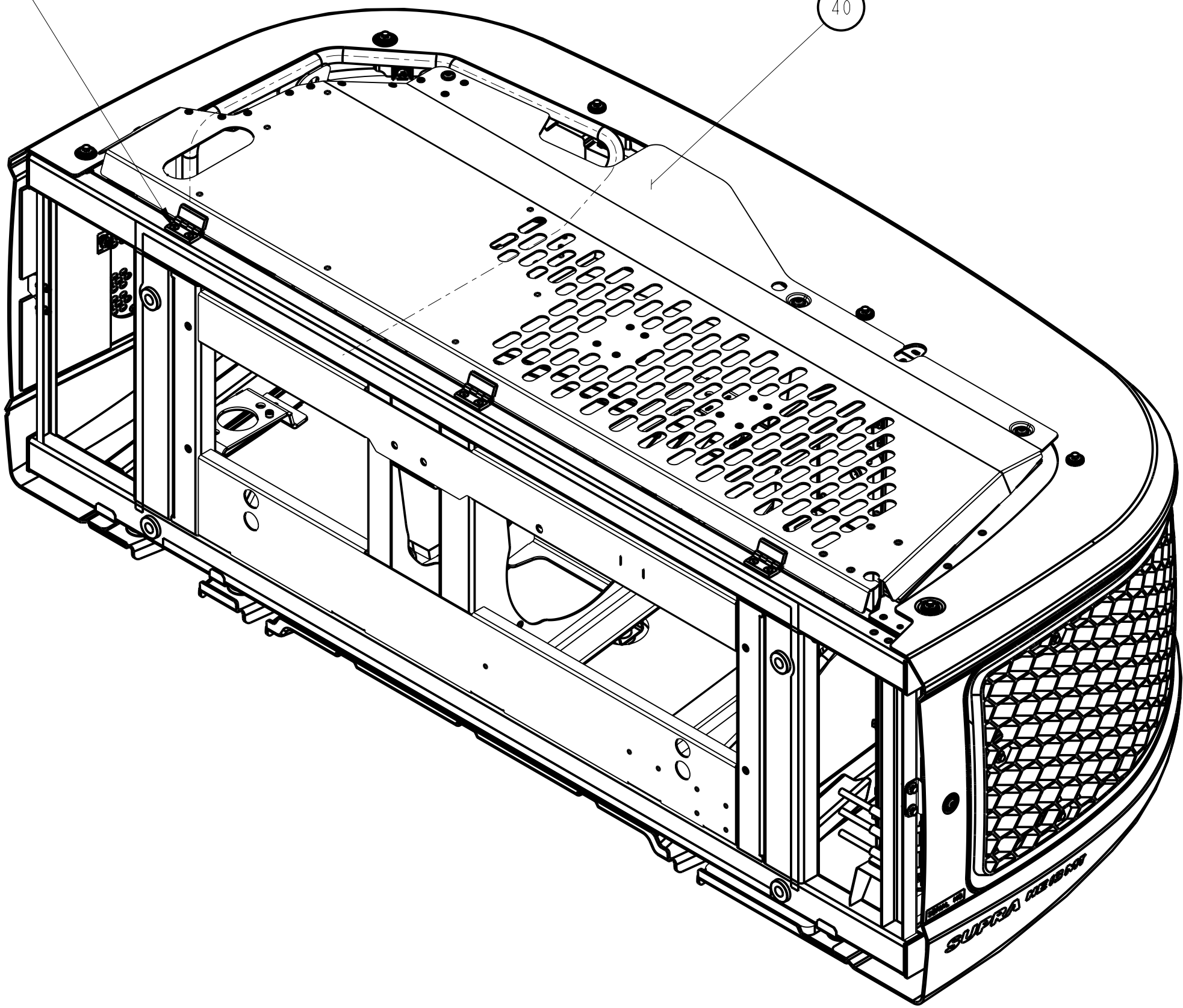
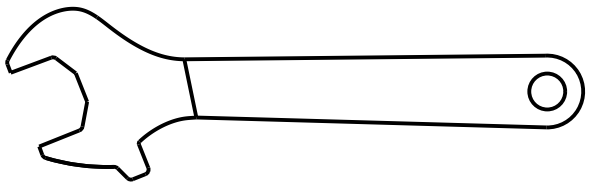

STEP 4

ASSEMBLE ITEM #40 (TOP PANEL ASSY) AS SHOWN USING THE HARDWARE SUPPLIED.

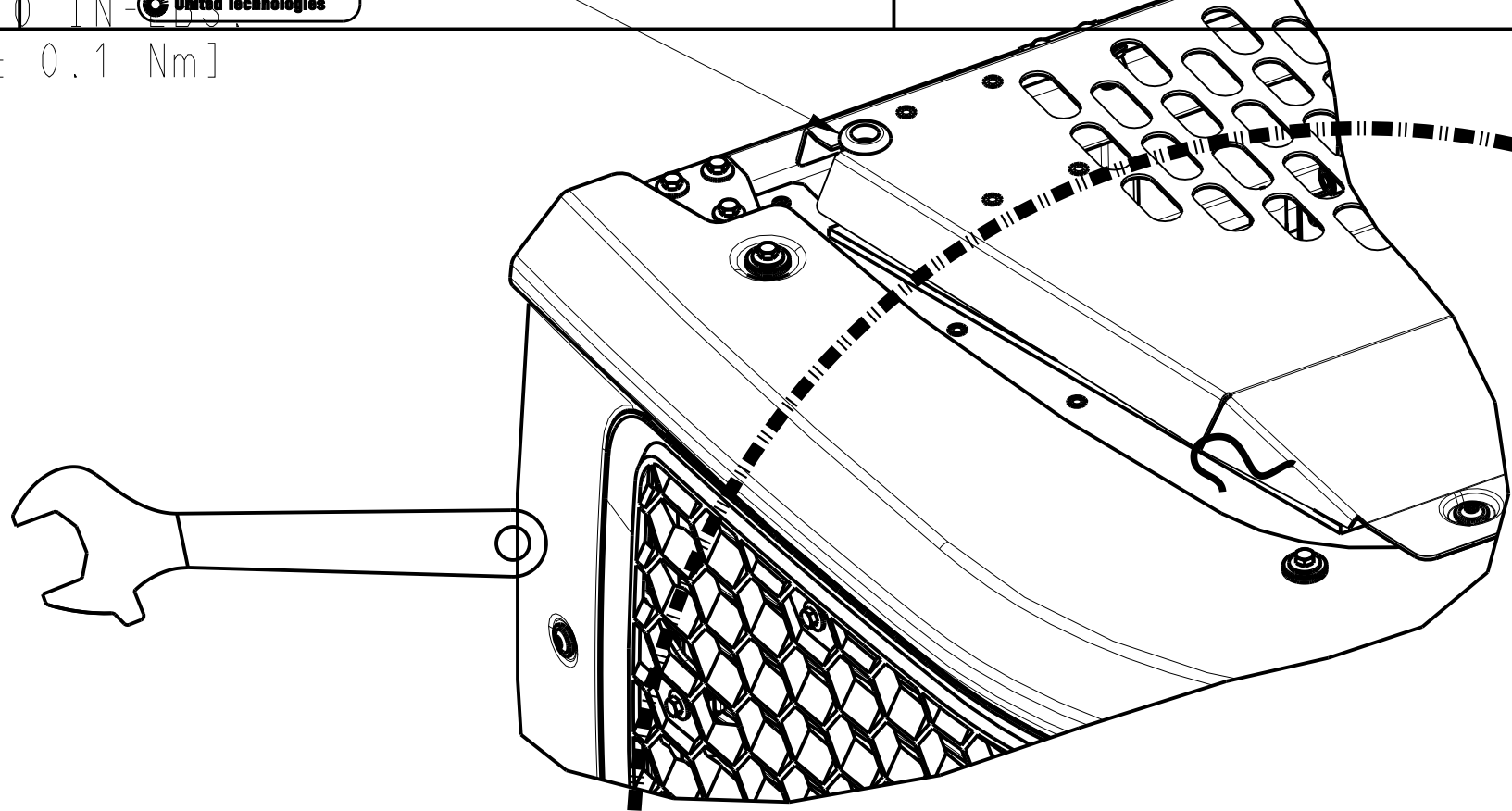

eSOLUTIONS ANTENNA MNTG
SCALE 0.250

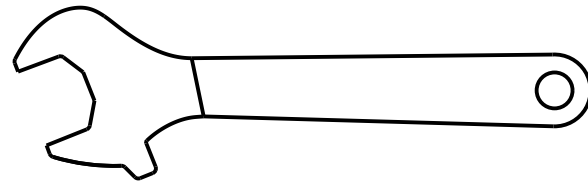
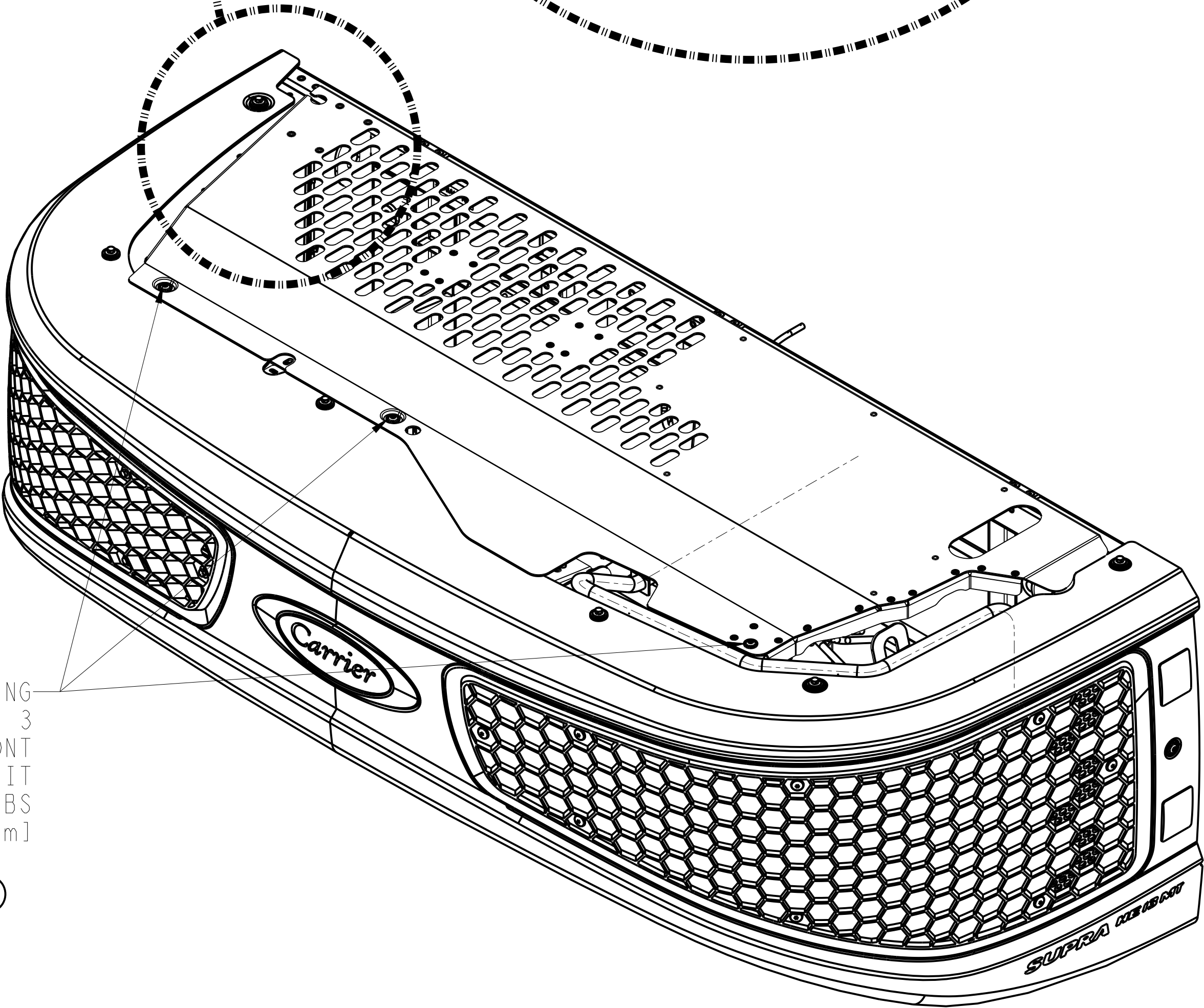

A	ADDED THIS SHT.; VIEWS WERE SHOWN ON SHT.2; ADDED INSTALLATION PROCEDURE INFORMATION TO STEP 4 WAS SHOWN ON SHT.1; ADDED VIEW "eSOL ANTENNA MNTG"; REPLACED IT.40	13 AUG 2020	MGC			ECN1135359
SYM	REVISION RECORD	DATE	BY	ENGR.	M.E.	NPCA NO.

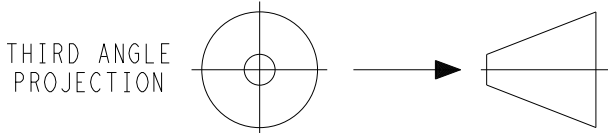

IMPERIAL INCH FORMAT:
UNLESS OTHERWISE SPECIFIED
DIMENSIONS ARE IN INCHES WITH
METRIC CONVERSIONS IN [MILLIMETERS]

TITLE
INSTALL INSTRUCTION. SNOW/RAIN COVER

DRAWING NO.	98-03383	REV	A
	SHEET 3 OF		

SUPERSEDES: _____

PART CLASSIFICATION: US EAR99

DRAWING CLASSIFICATION: US EAR99