



BILL OF MATERIALS			
ITEM	DESCRIPTION	QTY	
		ROAD	ROAD/STBY
5	BOLT, T-HEAD M14x165	4	4
10	WASHER, SPACER M14x30 0Dx4 THK	4	4
15	NUT, LOCK M14	4	4
20	SCREW, CAP HXHD M12x45 FLANGE	6	6
25	BASE TY-WRAP	20	20
30	CLAMP	30	30
35	RIVET, BLIND	4	4
40	O-RING 1/4	2	2
45	O-RING 3/8	5	5
50	O-RING 5/8	3	3
55	O-RING 3/4	1	1
60	FITTING 1/4ORS-MB	1	1
65	TERMINAL, RING Ø8	1	1
70	TERMINAL, RING Ø6	1	1
75	HEAT SHRINK	4	4
80	FUSE HOLDER	1	1
85	TERMINAL, RING	2	2
90	FUSE 50A	1	1
95	FUSE 60A	1	1
100	RIVET, BLIND	2	2
105	SPLICE	1	1
110	TERMINAL	1	1
115	THERMOSTAT INJECTION	1	1
120	SPLICE	2	2
125	SCREW, MACH PNHD M5x35	-	4
130	GROMMET	-	1
135	RECEPTACLE ASSY 400 3Ph	-	1
140	RECEPTACLE ASSY 230 3Ph	-	1
145	PLUG, FEMALE 400 3Ph	-	1
150	PLUG, FEMALE 230 3Ph	-	1
155	BRACKET	-	1
160	CAP ORFS 5/8	1	-
165	DECAL	-	1
170	DECAL	-	1
175	DECAL, 400/3/50	-	1
180	DIAGRAM	-	1
185	DIAGRAM	1	-
190	DIAGRAM	-	1
195	INSTRUCTIONS	1	1
200	INSTALLATION KIT	1	1
205	DECAL	1	1
210	MANUAL, SERVICE	1	1
215	SKIN	1	1
220	CHECK VALVE 3/8	1	1
225	CAB COMMAND	1	1
230	OPERATOR'S MANUAL	1	1
235	INSTALLATION INSTRUCTIONS	1	1
245	SCREW M6x20	7	7
250	HOSE FLEXIBLE	10	10
255	HOSE	8	8
260	HOSE	6	6
265	FITTING HOSE - MOD 8-10	1	1
270	FITTING HOSE - MOD 10-12	1	1
275	FITTING HOSE 90 - MOD 8-10	1	1
280	FITTING HOSE 90 - MOD 10-12	1	1
285	FITTING HOSE 90 - MOD 4-6	2	2
290	ELBOW, 90 - MOD 12	3	3
295	FITTING HOSE	2	2
300	ELBOW, 90	1	1
305	FITTING PRESSURE VALVE	1	1
310	VALVE	1	1
315	CLAMP – MOD 6	6	6
320	CLAMP – MOD 10	6	6
325	CLAMP – MOD 12	4	4
330	ELBOW, 45 – MOD 6	1	1
335	ELBOW, 45 – MOD 10	1	1
340	DRAIN WATER HOSE	1	1
345	DRAIN WATER TEE (connector)	1	1
350	TIE-WRAP	-	1

FUSES / 3 phase				
Item	230/3/50Hz	400/3/50Hz	230/3/60Hz	400/3/60Hz
	12 V			
Road supply fuse	50 A	50 A	50 A	50 A
Standby supply fuse	50 A	50 A	50 A	50 A
Main standby fuse FB	16 A	10 A	16 A	12 A
Transformer primary fuses	3.15 AT	3.15 AT	3.15 AT	3.15 AT
Main road fuse	60 A	60 A	60 A	60 A
	24 V			
Road supply fuse	40 A	40 A	40 A	40 A
Standby supply fuse	40 A	40 A	40 A	40 A
Main standby fuse FB	16 A	10 A	16 A	12 A
Transformer primary fuses	4 AT	3.15 AT	4 AT	3.15 AT
Main road fuse	50 A	50 A	50 A	50 A

FUSES / 1 phase		
Item	230/1/50Hz	208/230/1/60Hz
	12 V	
Road supply fuse	50 A	50 A
Standby supply fuse	50 A	50 A
Circuit breaker fuse CB	25 A	25 A
Transformer primary fuses	5 AT	5 AT
Main road fuse	60 A	60 A
	24 V	
Road supply fuse	40 A	40 A
Standby supply fuse	40 A	40 A
Circuit breaker fuse CB	25 A	25 A
Transformer primary fuses	4 AT	4 AT
Main road fuse	50 A	50 A

MODEL	CPR setting	
	bar	psig
XARIOS 600 (Integra 50X)	2.6	38 ± 1
XARIOS 500-04 (Integra 40X)	2.3	33 ± 1

MODEL	Refrigerant charge R404 A / R452A	
	LB	KG
XARIOS 600 (Integra 50X)	7.1	3.2
XARIOS 500-04 (Integra 40X)	6.6	3

MODEL	Voltage	AMP
XARIOS 600 (Integra 50X)	400/3/50Hz	10.7
	230/3/60Hz	16.6
	230/1/50Hz	17.2
	208/230/1/60Hz	20.0
XARIOS 500-04 (Integra 40X)	400/3/50Hz	8.0
	230/3/60Hz	16.6
	230/1/50Hz	17.2
	208/230/1/60Hz	20.0



ADDITIONNAL OIL + 200ml FOR XARIOS 600 & +250ml FOR XARIOS 600 MT
WE RECOMMEND FILLING THE EXTRA OIL IN THE UNIT USING ONE OF THE
FOLLOWING 3 OPTIONS
1. INTO THE TOP OF HP HOSE, JUST BEFORE THE OIL SEPARATOR.
2. INTO THE OIL SEPARATOR.
3. INTO THE TOP OF THE OIL RETURN HOSE.
WHILE COMMISSIONING, PLEASE LET THE ENGINE RUNNING AT IDLE SPEED
LUBRICATE THE COMPRESSEUR
DURING 10 MINUTES TO ALLOW THE OIL TO WELL LUBRICATE THE COMPRESSEUR



WARNING

READ ALL NOTES PRIOR TO INSTALLATION

NOTES :

TIME ESTIMATED FOR INSTALLATION OF UNIT ALONE : 8 hours

1. TRUCK BODY

- 1.1. THE TRAILER STRUCTURE MUST BE EVALUATED BY THE TRAILER MANUFACTURER TO DETERMINE ITS ABILITY TO WITHSTAND THE LOADS IMPOSED BY THE UNIT OVER ITS SERVICE LIFE. CARRIER TRANSICOLD DOES NOT CONVEY ANY ENDORSEMENT OR WARRANTY FOR THE TRAILER'S STRUCTURAL INTEGRITY.
- 1.2. UNIT MOUNTING SURFACES OF THE TRAILER THAT CONTACT THE UNIT MOUNTING PADS MUST BE UNI-PLANAR TO WITHIN 3mm [0.12] TO PREVENT DISTORTION OF THE UNIT AND/OR TRAILER ;
- 1.3. ALL DIMENSIONS SHOWN ARE MILLIMETERS, WITH IMPERIAL CONVERSIONS IN [INCHES].

2. INSTALLATION

- 2.1. THIS REFRIGERATION UNIT HAS BEEN DESIGNED WITH THE SAFETY OF THE TECHNICIAN IN MIND. DURING NORMAL OPERATION, ALL MOVING PARTS ARE FULLY ENCLOSED TO PREVENT INJURY. DURING ALL PRE-TRIP INSPECTIONS, DAILY INSPECTIONS AND PROBLEM TROUBLESHOOTING, YOU MAY BE EXPOSED TO MOVING PARTS. WE ADVISE YOU TO TAKE ALL REQUIRED PRECAUTIONS GENERAL AND TO WEAR ADEQUATE PERSONAL PROTECTIVE EQUIPMENT (SAFETY GLASSES, GLOVES, SAFETY SHOES) DURING INSTALLATION AND ALL REPAIRS AND MAINTENANCE SERVICES ON THE UNIT.
- 2.2. TAKE EVERY SAFETY MEASURE WHEN ACCESSING THE UNIT, USE STANDARDS LADDERS, WORKING PLATFORM WITH RAILING, SAFETY BELT, ; ; ;
- 2.3. UNITS ARE DELIVERED UNDER PRESSURE WITH NITROGEN. PLEASE BE SURE THAT THE CIRCUIT IS STILL UNDER PRESSURE (IT MEANS THAT THERE IS NO LEAK).

3. SERVICE

- 3.1. IT IS IMPORTANT FOR THE SAFETY AND UPKEEP OF THE REFRIGERATION UNIT THAT SERVICING IS PERIODICALLY PERFORMED ACCORDING TO THE FREQUENCY INDICATED BY THE MANUFACTURED (SEE SERVICE MANUAL) ; SERVICE OPERATIONS AND REPAIRS MUST BE CARRIED OUT BY APPROVED CARRIER SERVICE STATIONS ;
- 3.2. **[ETO ONLY]** GOLDEN COLD SERVICE CONTRACTS : THE PROOF OF OUR COMMITMENT TO YOUR PROFITABILITY WITH A CHOICE OF CONTACTS : FULL SERVICE / ROUTINE MAINTENANCE / EXTENDED WARRANTY.

CONTENTS

Section	page
BOM	1
UNIT DIMENSIONS	2
TRUCK BODY PREPARATION	3
UNIT INSTALLATION	4
REFRIGERANT HOSE INSTALLATION	7
ELECTRICAL CONNECTION	8
VACCUM, CHARGE, TEST AND RECORDS	9
GENERAL INFORMATION	11

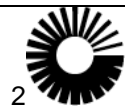

Carrier
A United Technologies Company

CARRIER TRANSICOLD DIVISION, CARRIER CORPORATION
CARRIER TRANSICOLD INDUSTRIES S.A.S.
BP 16
76520 FRANQUEVILLE ST PIERRE – France
RC ROUEN 8 310 041 577

THIS DOCUMENT IS THE PROPERTY OF CARRIER CORPORATION AND IS
DELIVERED UPON THE EXPRESS CONDITION THAT THE CONTENTS WILL
NOT BE DISCLOSED OR USED WITHOUT CARRIER CORPORATION
WRITTEN CONSENT.

SUBMISSION OF THESE DRAWINGS OR DOCUMENTS DOES NOT
CONSTITUTE PART PERFORMANCE OR ACCEPTANCE OF CONTACT

CONDENSER XARIOS 500-04/600

WEIGHT :	X500-04 ROAD :	80 kg (177 lb)
	X500-04 ROAD/STANDBY :	144 kg (318 lb)
	X600 ROAD	83 kg (183 lb)
	X600 ROAD/STANDBY	147 kg (324 lb)

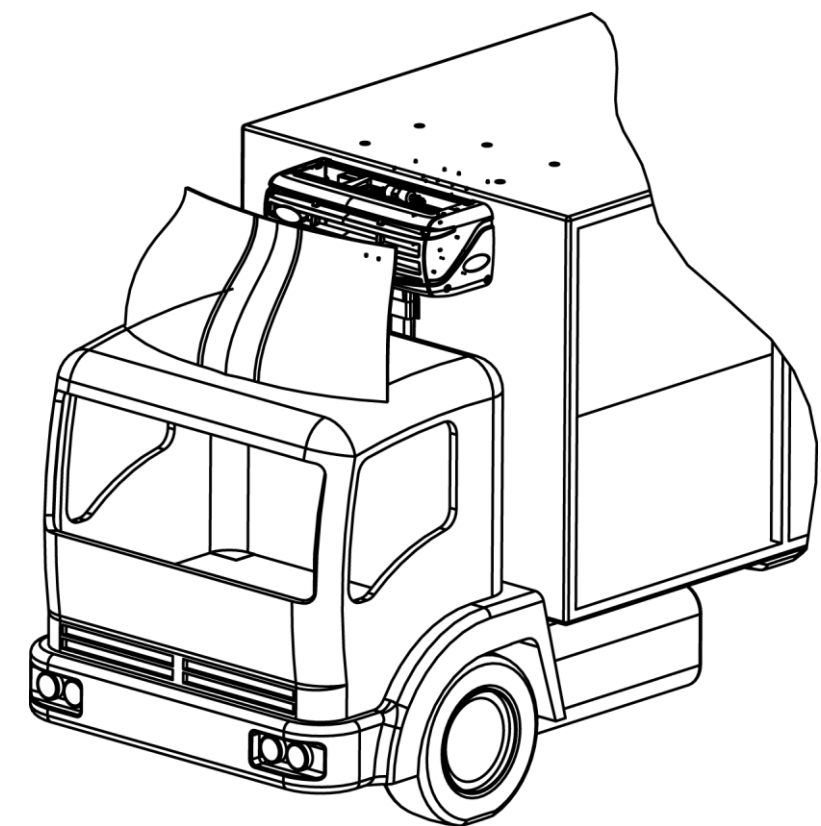
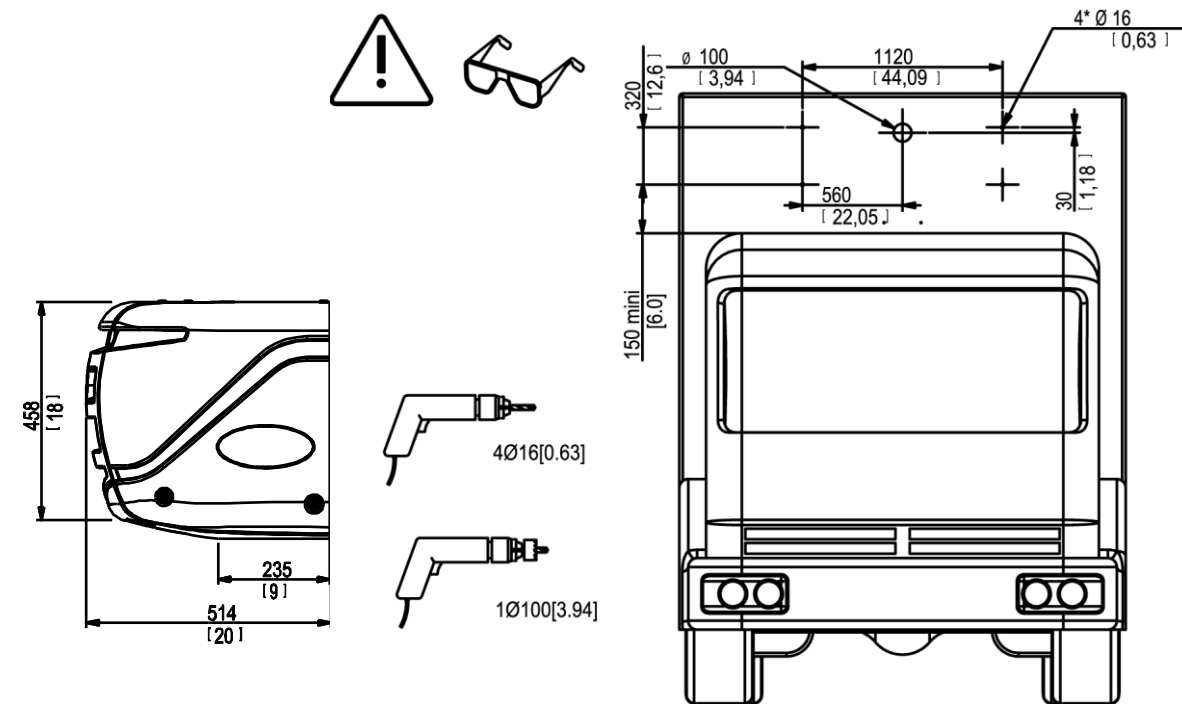
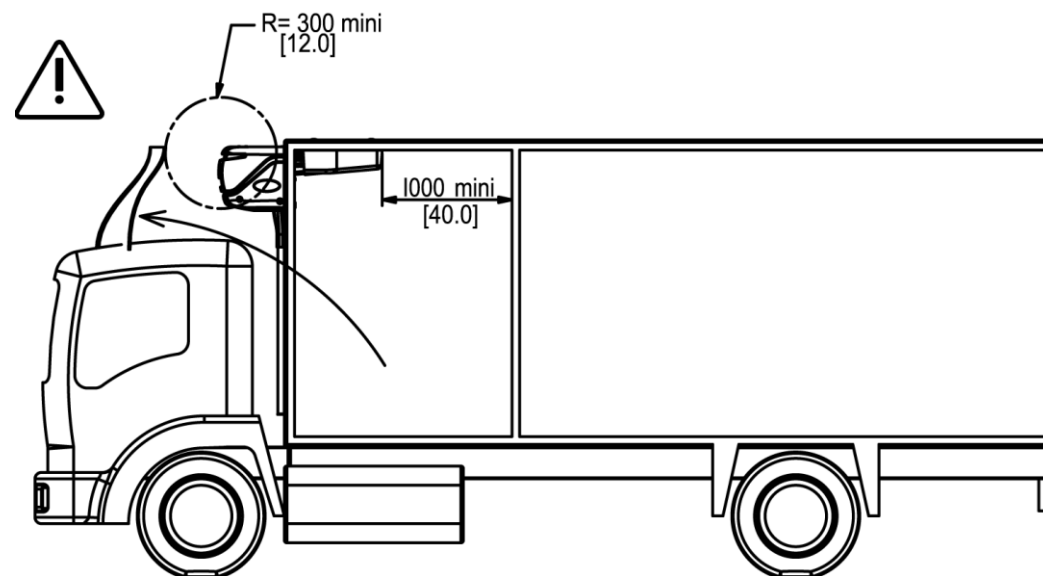
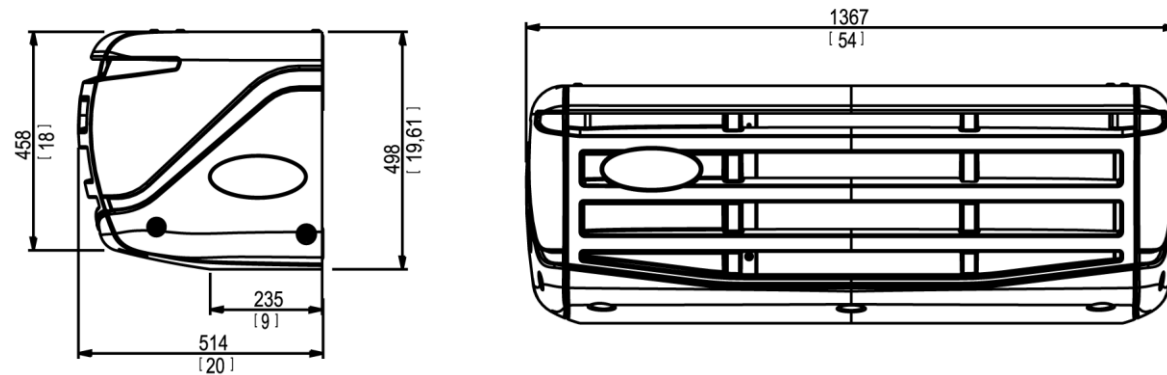

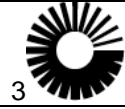

Carrier
A United Technologies Company

CARRIER TRANSICOLD DIVISION, CARRIER CORPORATION
CARRIER TRANSICOLD INDUSTRIES S.A.S.
BP 16
76520 FRANQUEVILLE ST PIERRE – France
RC ROUEN 8 310 041 577

THIS DOCUMENT IS THE PROPERTY OF CARRIER CORPORATION AND IS
DELIVERED UPON THE EXPRESS CONDITION THAT THE CONTENTS WILL
NOT BE DISCLOSED OR USED WITHOUT CARRIER CORPORATION
WRITTEN CONSENT.

SUBMISSION OF THESE DRAWINGS OR DOCUMENTS DOES NOT
CONSTITUTE PART PERFORMANCE OR ACCEPTANCE OF CONTACT

EVAPORATOR MXL 1100 - XARIOS 500-04

WEIGHT : 28 kg (62 lb)

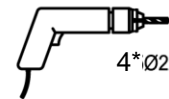
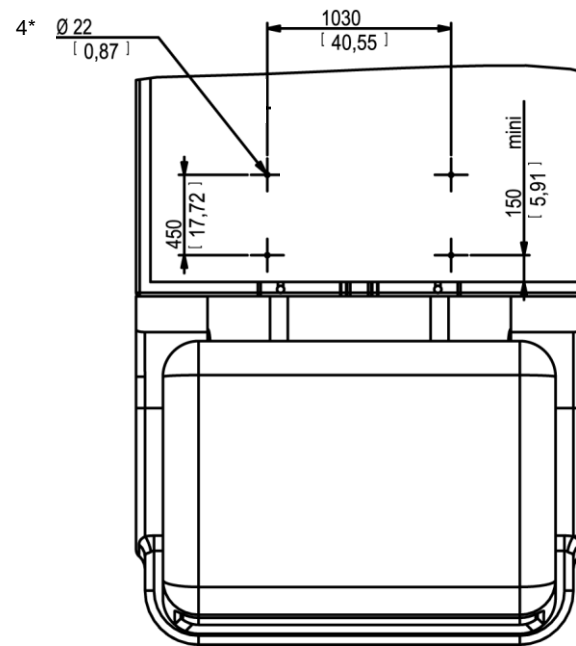
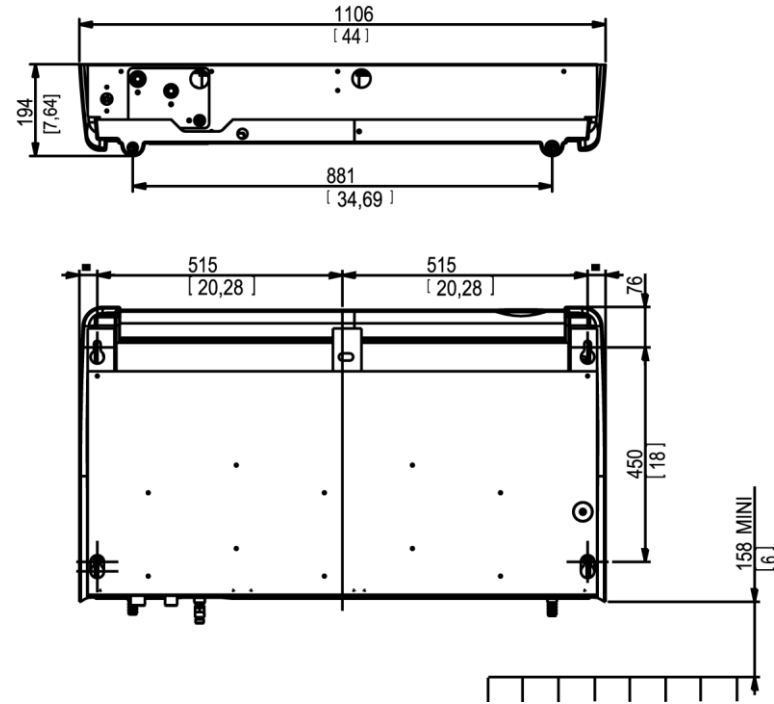

4*Ø22[0.87]

EVAPORATOR MXL 1550 - XARIOS 600

WEIGHT : 42 kg (93 lb)

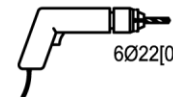
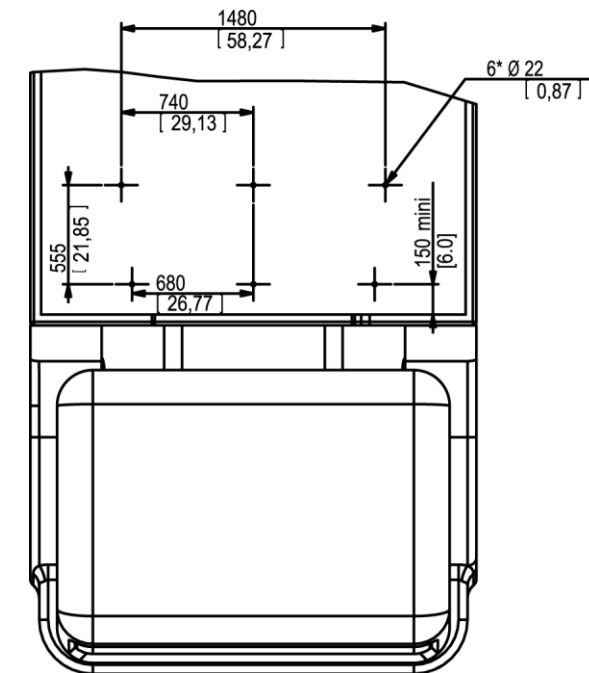
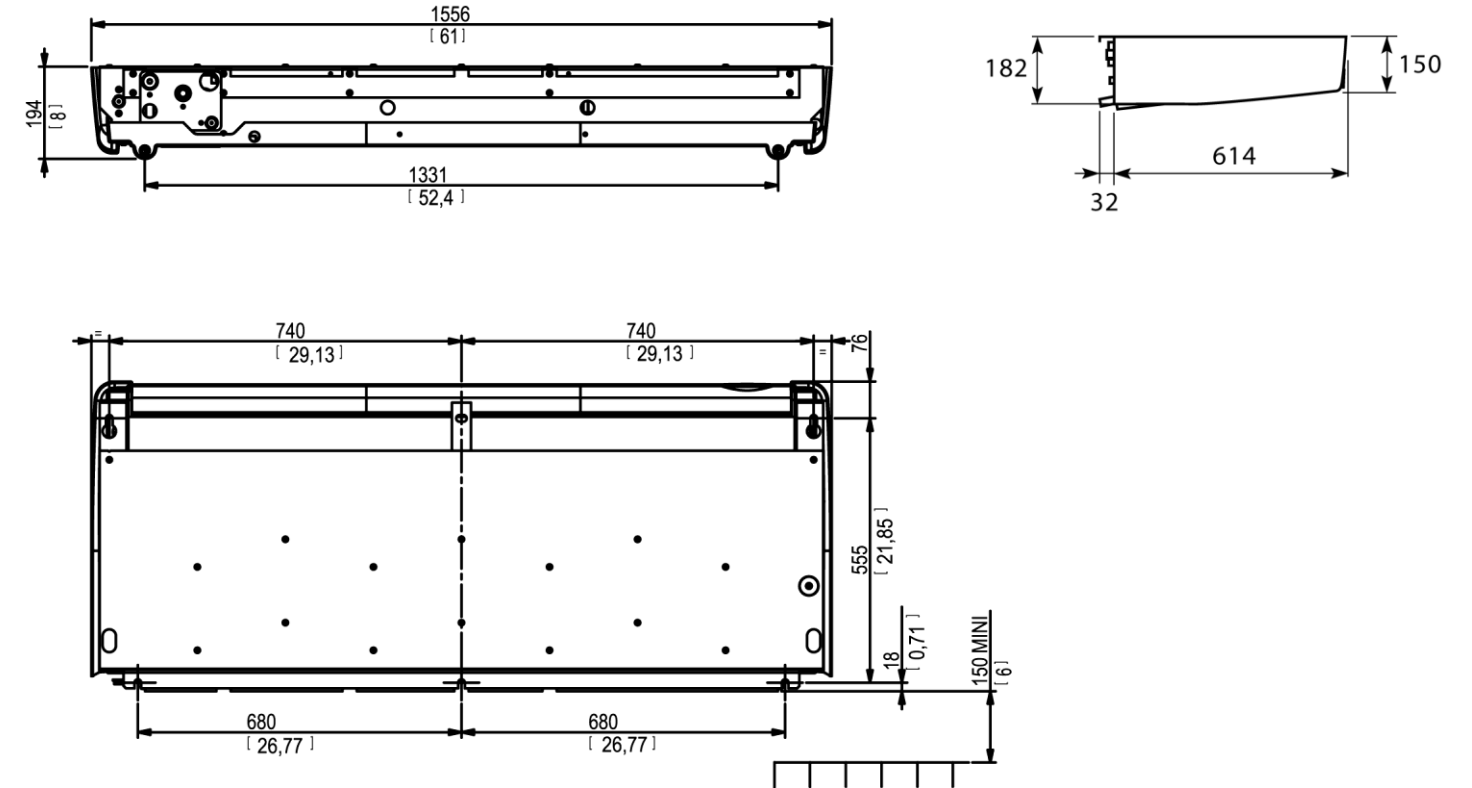

6Ø22[0.87]



Carrier
A United Technologies Company

CARRIER TRANSCOLD DIVISION, CARRIER CORPORATION
CARRIER TRANSCOLD INDUSTRIES S.A.S.
BP 16
76520 FRANQUEVILLE ST PIERRE – France
RC ROUEN 8 310 041 577

THIS DOCUMENT IS THE PROPERTY OF CARRIER CORPORATION AND IS
DELIVERED UPON THE EXPRESS CONDITION THAT THE CONTENTS WILL
NOT BE DISCLOSED OR USED WITHOUT CARRIER CORPORATION
WRITTEN CONSENT.

SUBMISSION OF THESE DRAWINGS OR DOCUMENTS DOES NOT
CONSTITUTE PART PERFORMANCE OR ACCEPTANCE OF CONTACT

1

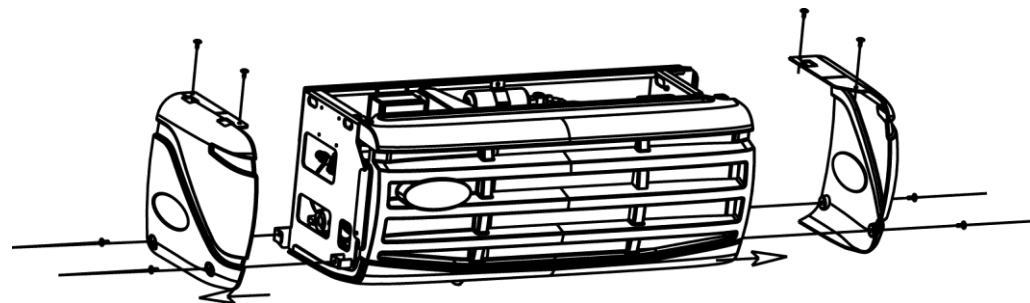

2

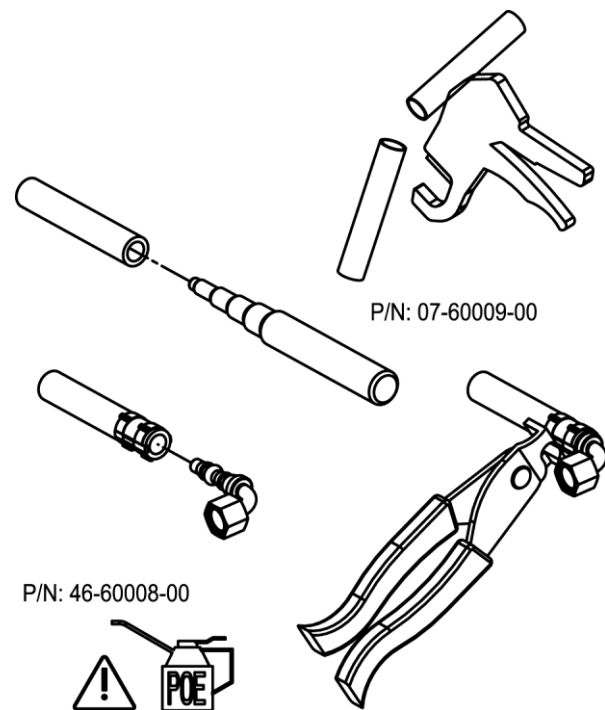

3

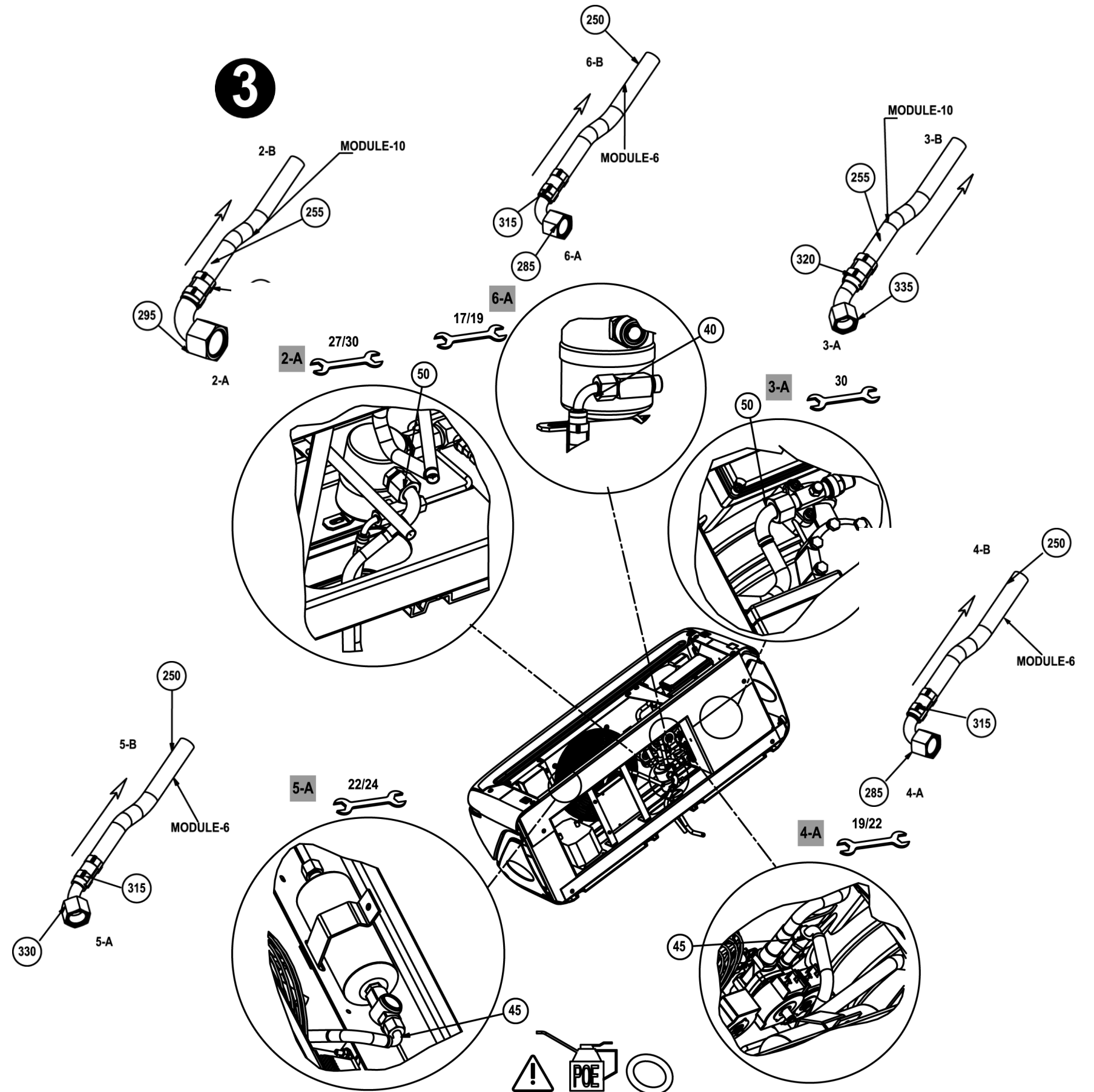



SUBMISSION OF THESE DRAWINGS OR DOCUMENTS DOES NOT
CONSTITUTE PART PERFORMANCE OR ACCEPTANCE OF CONTACT

5

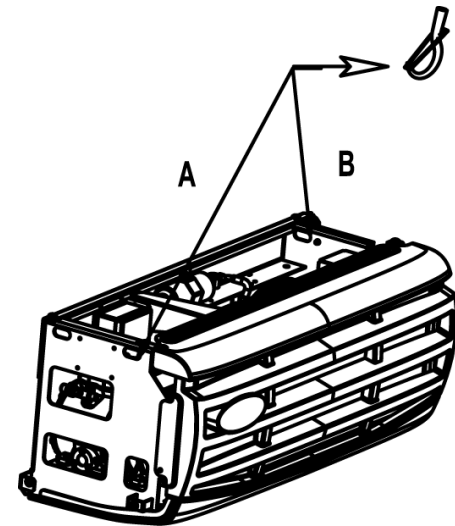
4



		
A (mm)	1040[41]	940[37]
B (mm)	940[37]	1040[41]

P/N : 07-60091-00

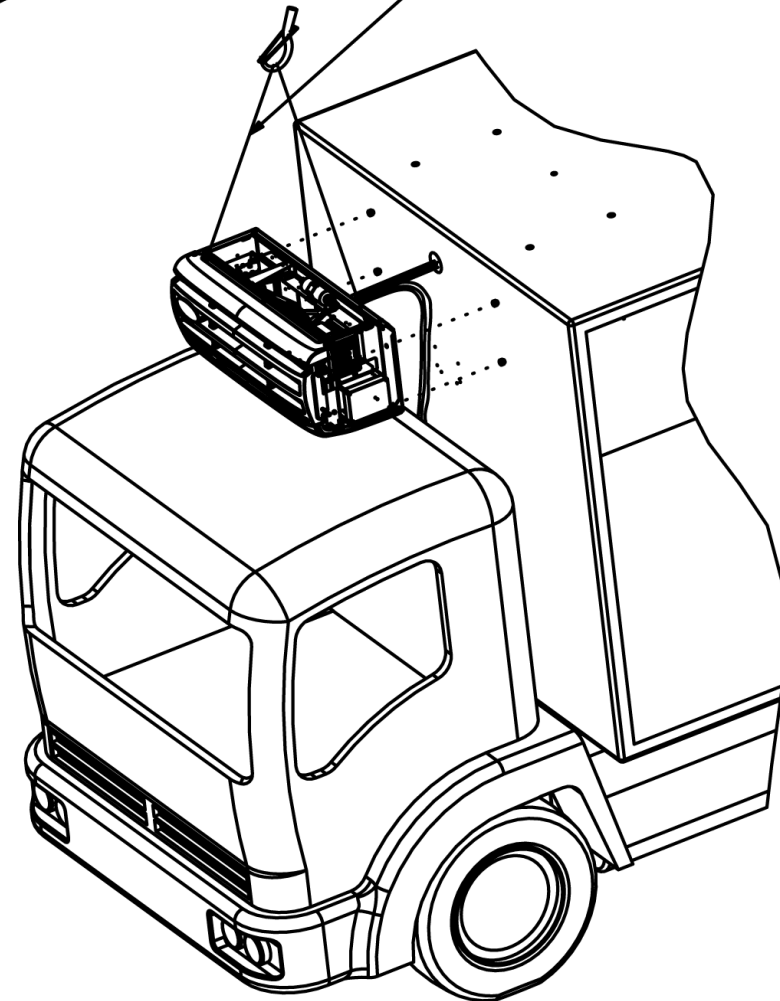

5

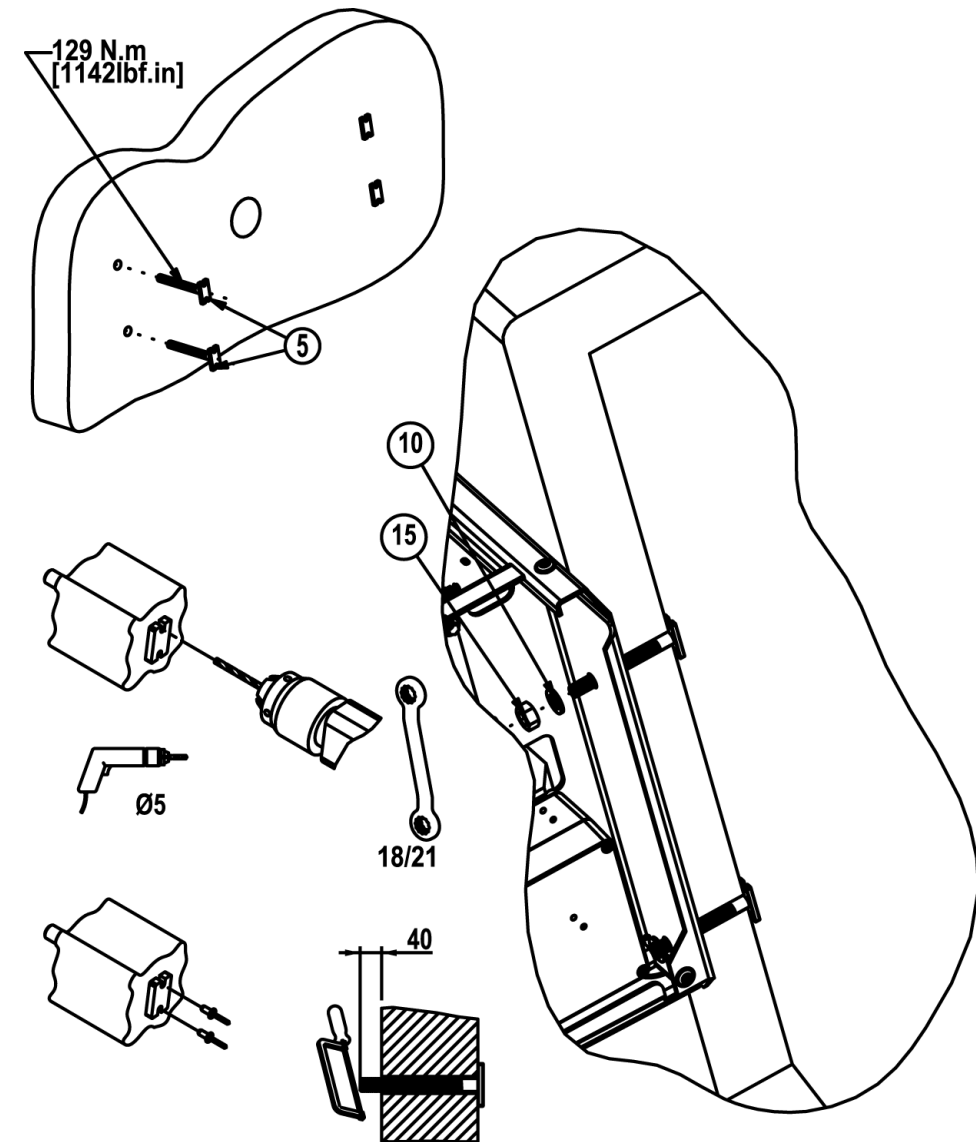

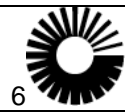

Carrier
A United Technologies Company

CARRIER TRANSICOLD DIVISION, CARRIER CORPORATION
CARRIER TRANSICOLD INDUSTRIES S.A.S.
BP 16
76520 FRANQUEVILLE ST PIERRE – France
RC ROUEN 8 310 041 577

THIS DOCUMENT IS THE PROPERTY OF CARRIER CORPORATION AND IS
DELIVERED UPON THE EXPRESS CONDITION THAT THE CONTENTS WILL
NOT BE DISCLOSED OR USED WITHOUT CARRIER CORPORATION
WRITTEN CONSENT.

SUBMISSION OF THESE DRAWINGS OR DOCUMENTS DOES NOT
CONSTITUTE PART PERFORMANCE OR ACCEPTANCE OF CONTACT

6

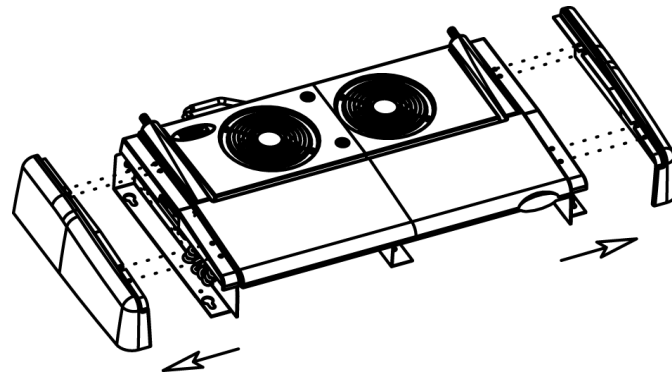

8

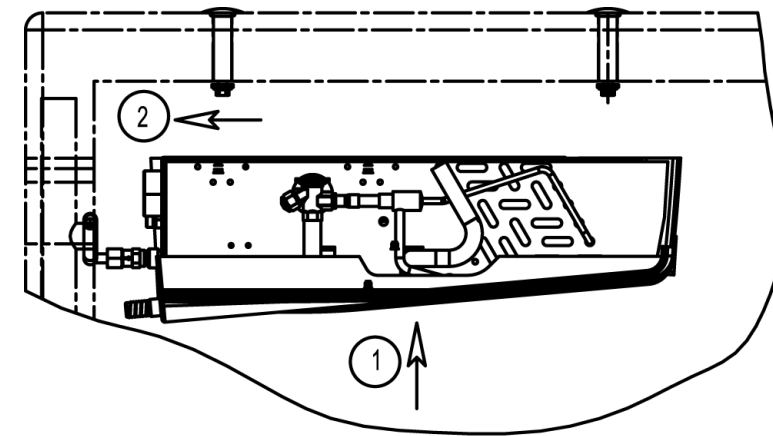

7

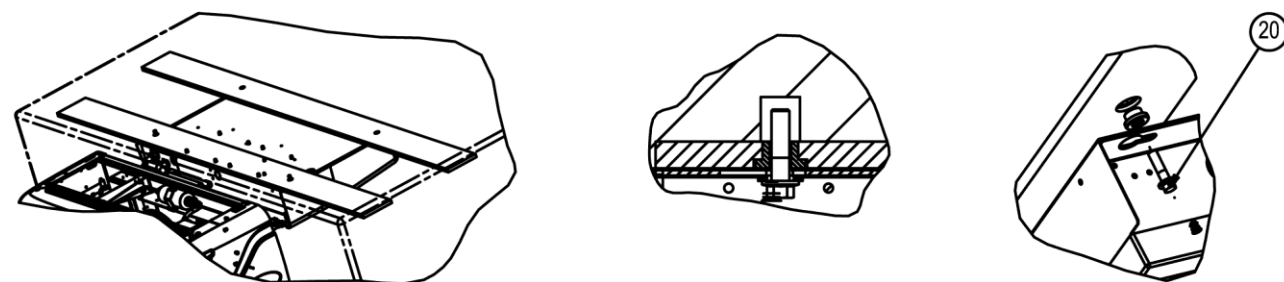
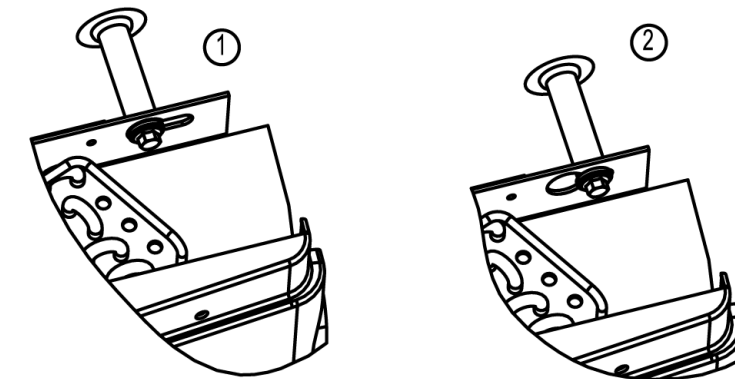
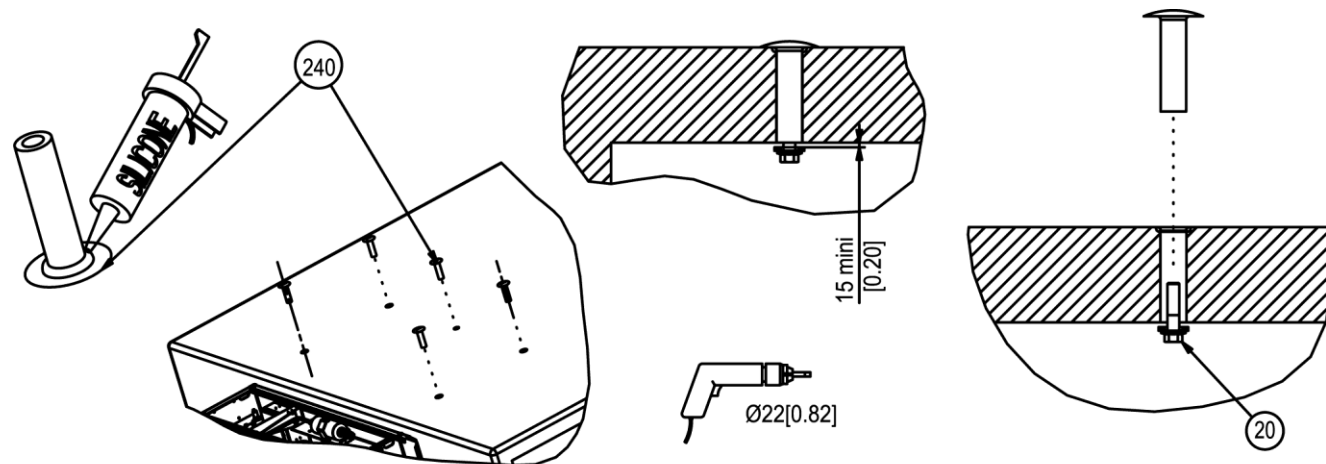



Carrier
A United Technologies Company

CARRIER TRANSICOLD DIVISION, CARRIER CORPORATION
CARRIER TRANSICOLD INDUSTRIES S.A.S.
BP 16
76520 FRANQUEVILLE ST PIERRE – France
RC ROUEN 8 310 041 577

THIS DOCUMENT IS THE PROPERTY OF CARRIER CORPORATION AND IS
DELIVERED UPON THE EXPRESS CONDITION THAT THE CONTENTS WILL
NOT BE DISCLOSED OR USED WITHOUT CARRIER CORPORATION
WRITTEN CONSENT.

SUBMISSION OF THESE DRAWINGS OR DOCUMENTS DOES NOT
CONSTITUTE PART PERFORMANCE OR ACCEPTANCE OF CONTACT

9

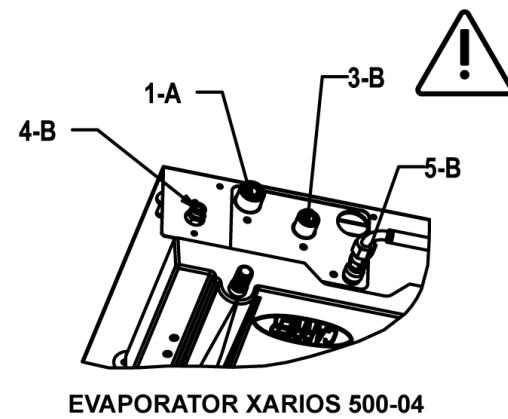
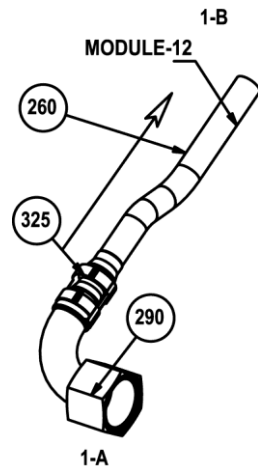

EVAPORATOR XARIOS 500-04

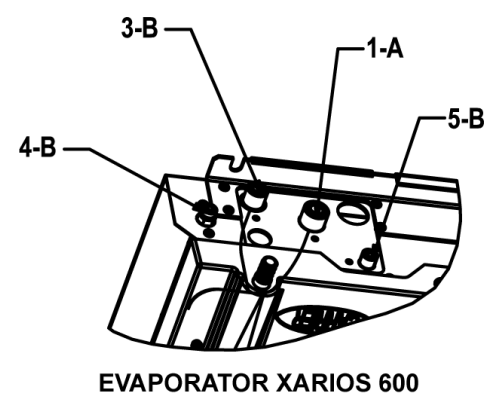

EVAPORATOR XARIOS 600

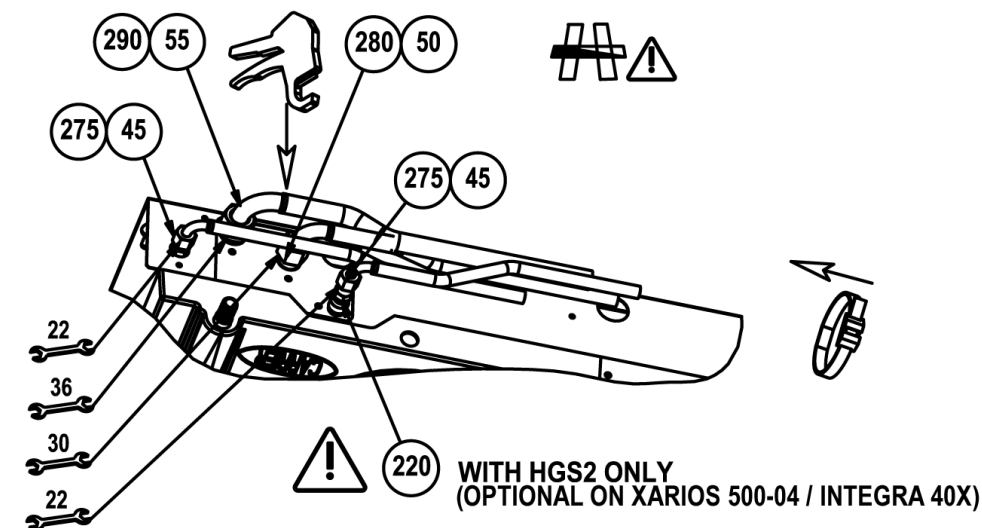
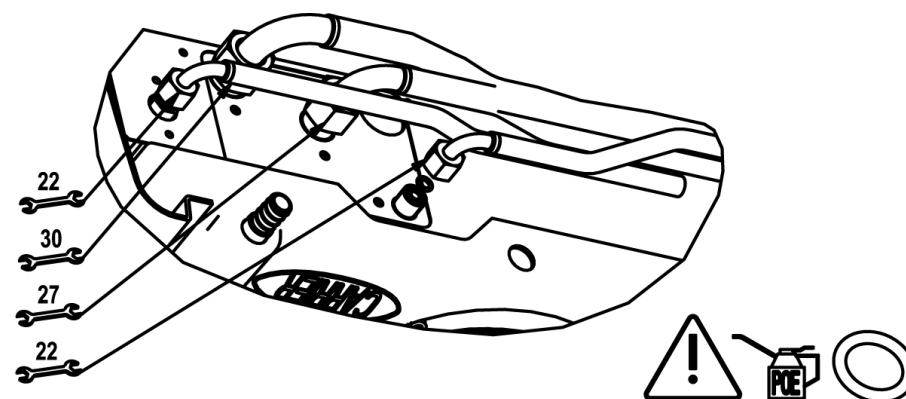

10

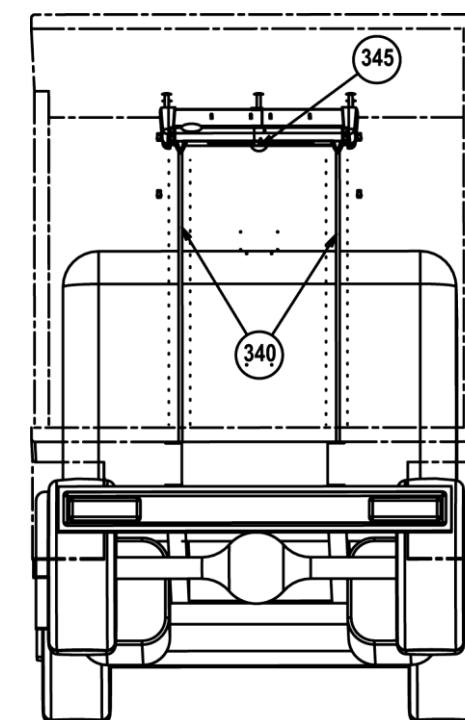
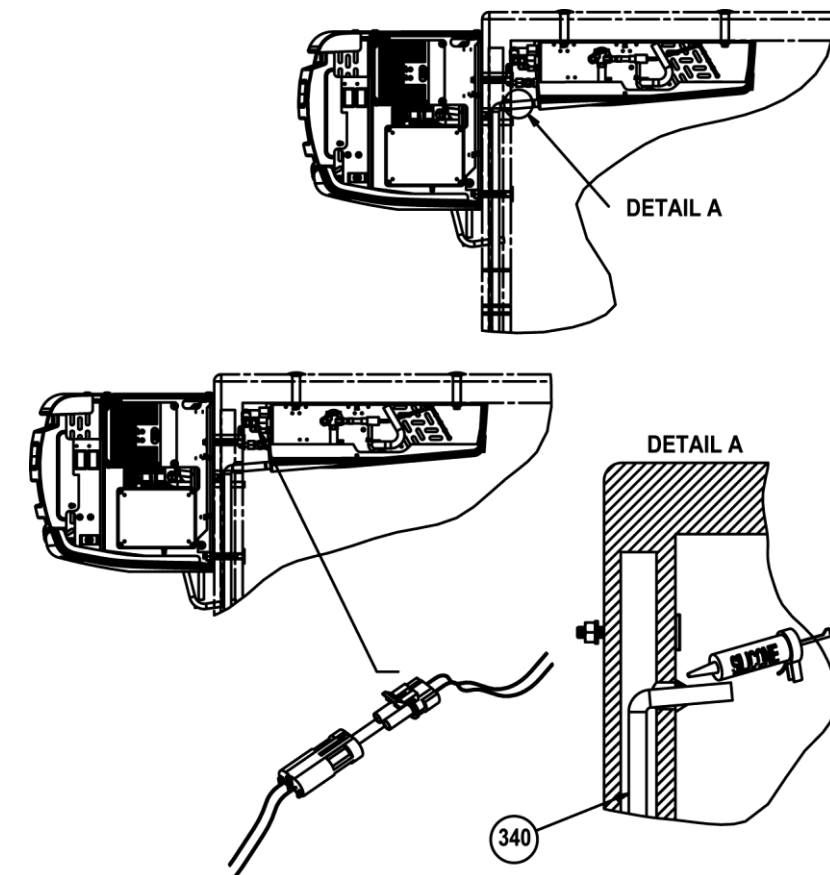



Carrier
A United Technologies Company

CARRIER TRANSICOLD DIVISION, CARRIER CORPORATION
CARRIER TRANSICOLD INDUSTRIES S.A.S.
BP 16
76520 FRANQUEVILLE ST PIERRE – France
RC ROUEN 8 310 041 577

THIS DOCUMENT IS THE PROPERTY OF CARRIER CORPORATION AND IS
DELIVERED UPON THE EXPRESS CONDITION THAT THE CONTENTS WILL
NOT BE DISCLOSED OR USED WITHOUT CARRIER CORPORATION
WRITTEN CONSENT.

SUBMISSION OF THESE DRAWINGS OR DOCUMENTS DOES NOT
CONSTITUTE PART PERFORMANCE OR ACCEPTANCE OF CONTACT

11

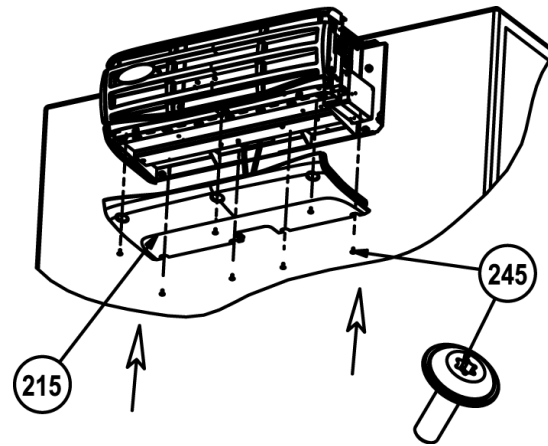

13

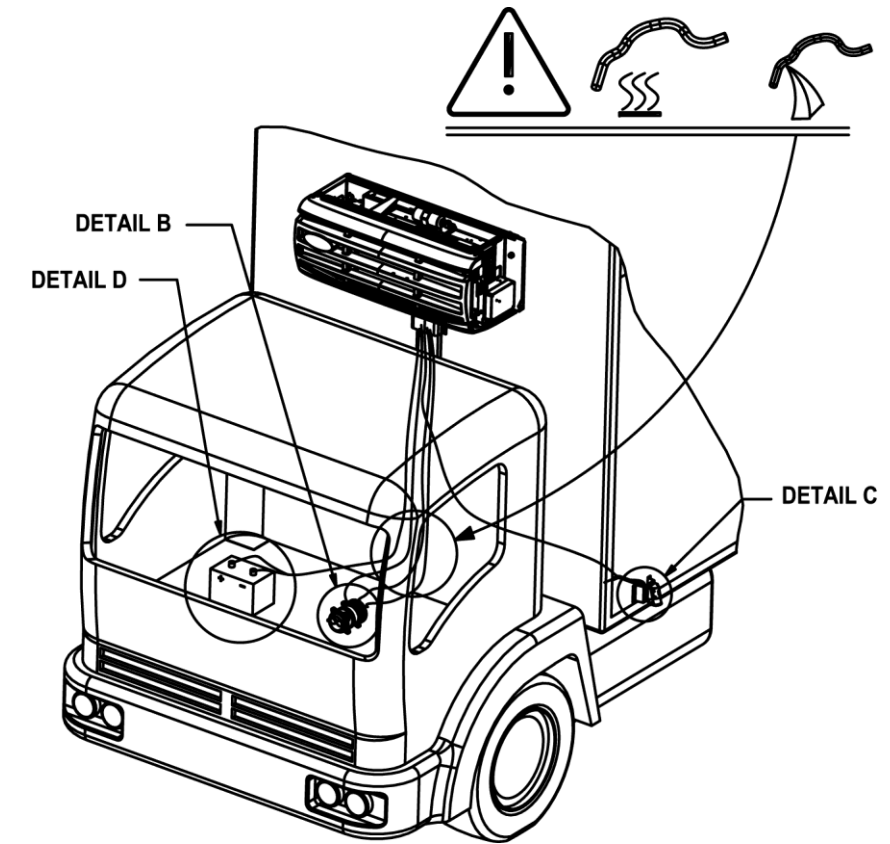

12

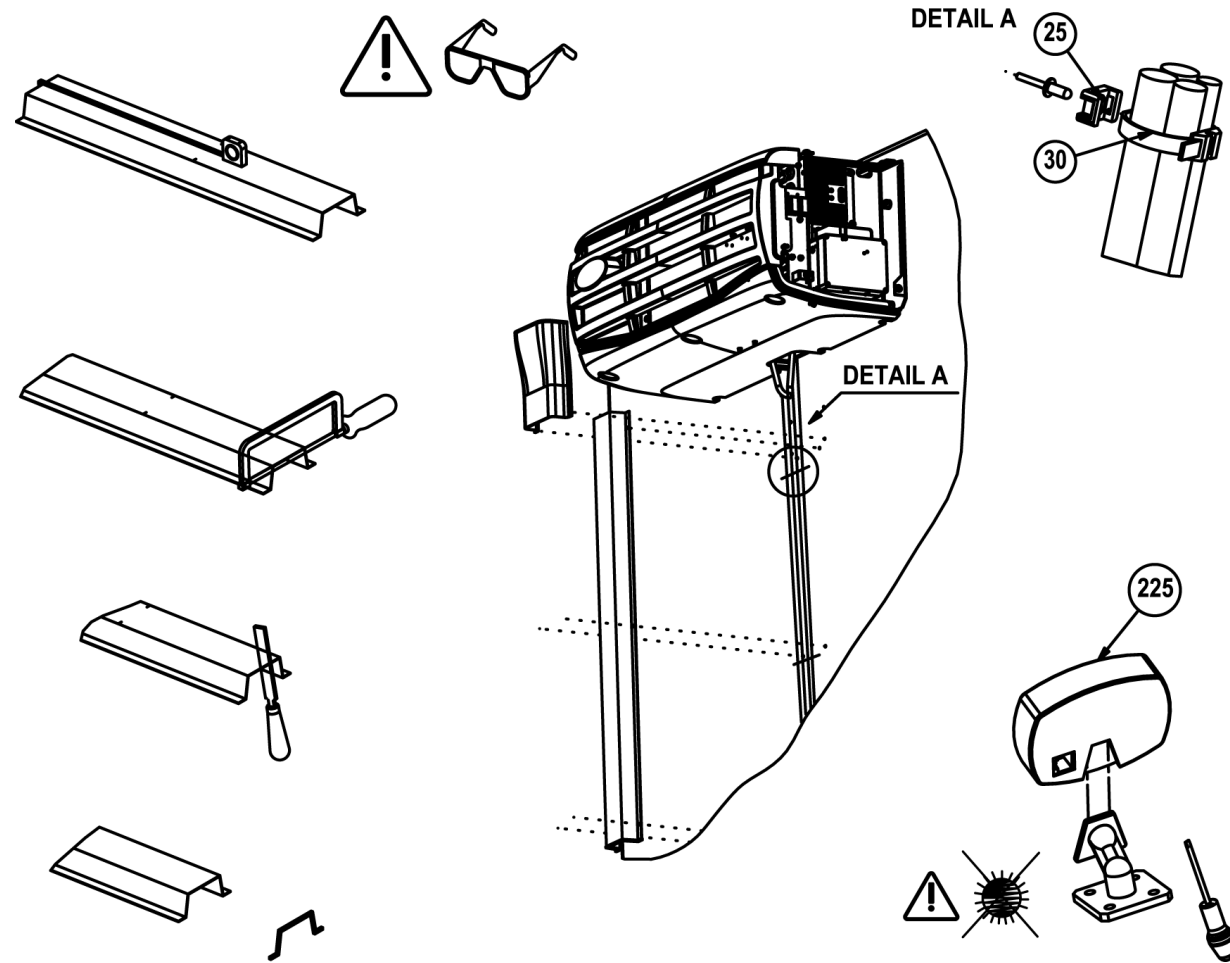

14

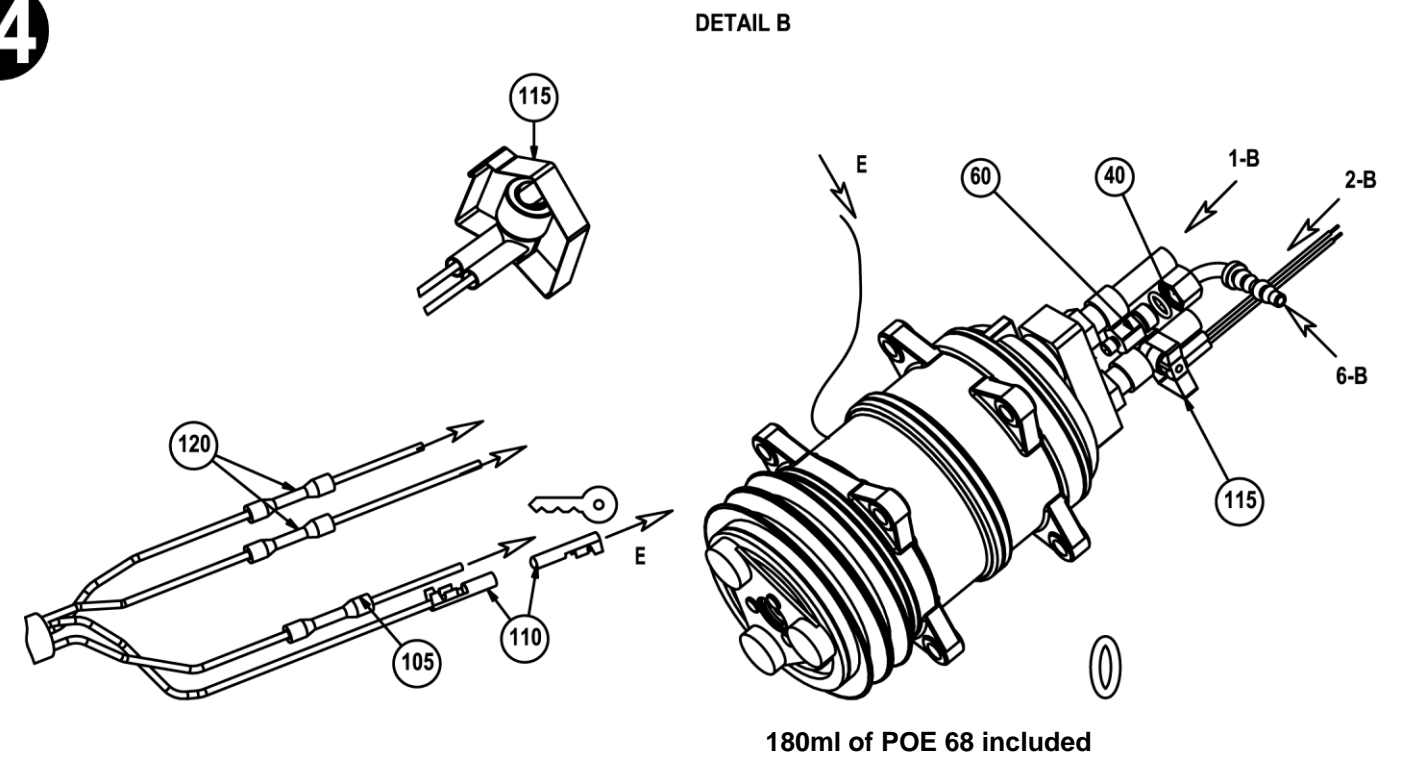



Carrier
A United Technologies Company

CARRIER TRANSICOLD DIVISION, CARRIER CORPORATION
CARRIER TRANSICOLD INDUSTRIES S.A.S.
BP 16
76520 FRANQUEVILLE ST PIERRE – France
RC ROUEN 8 310 041 577

THIS DOCUMENT IS THE PROPERTY OF CARRIER CORPORATION AND IS
DELIVERED UPON THE EXPRESS CONDITION THAT THE CONTENTS WILL
NOT BE DISCLOSED OR USED WITHOUT CARRIER CORPORATION
WRITTEN CONSENT.

SUBMISSION OF THESE DRAWINGS OR DOCUMENTS DOES NOT
CONSTITUTE PART PERFORMANCE OR ACCEPTANCE OF CONTACT

15

DETAIL C

135	140
400/3/50	230/3/60

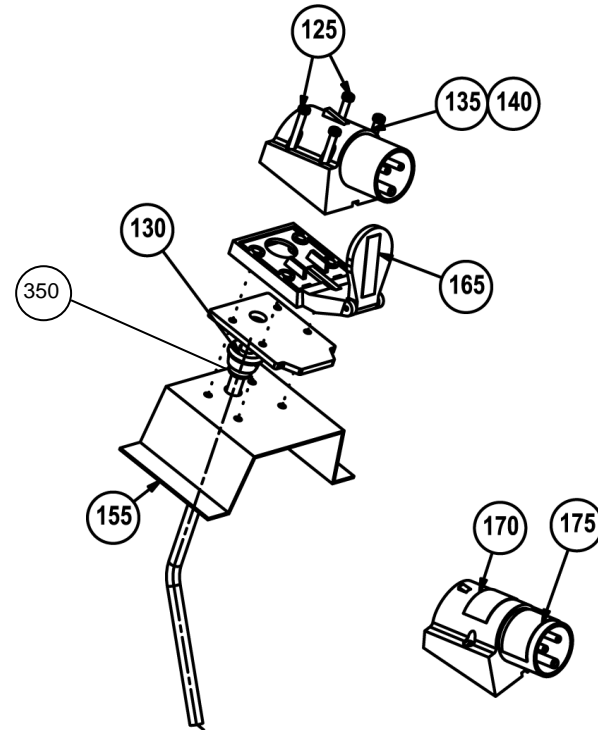

16

DETAIL D

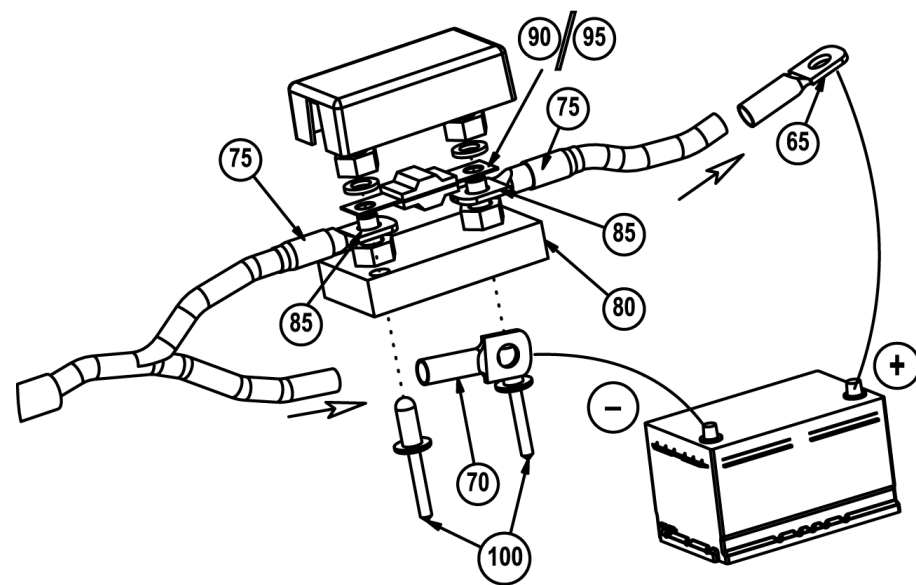

17

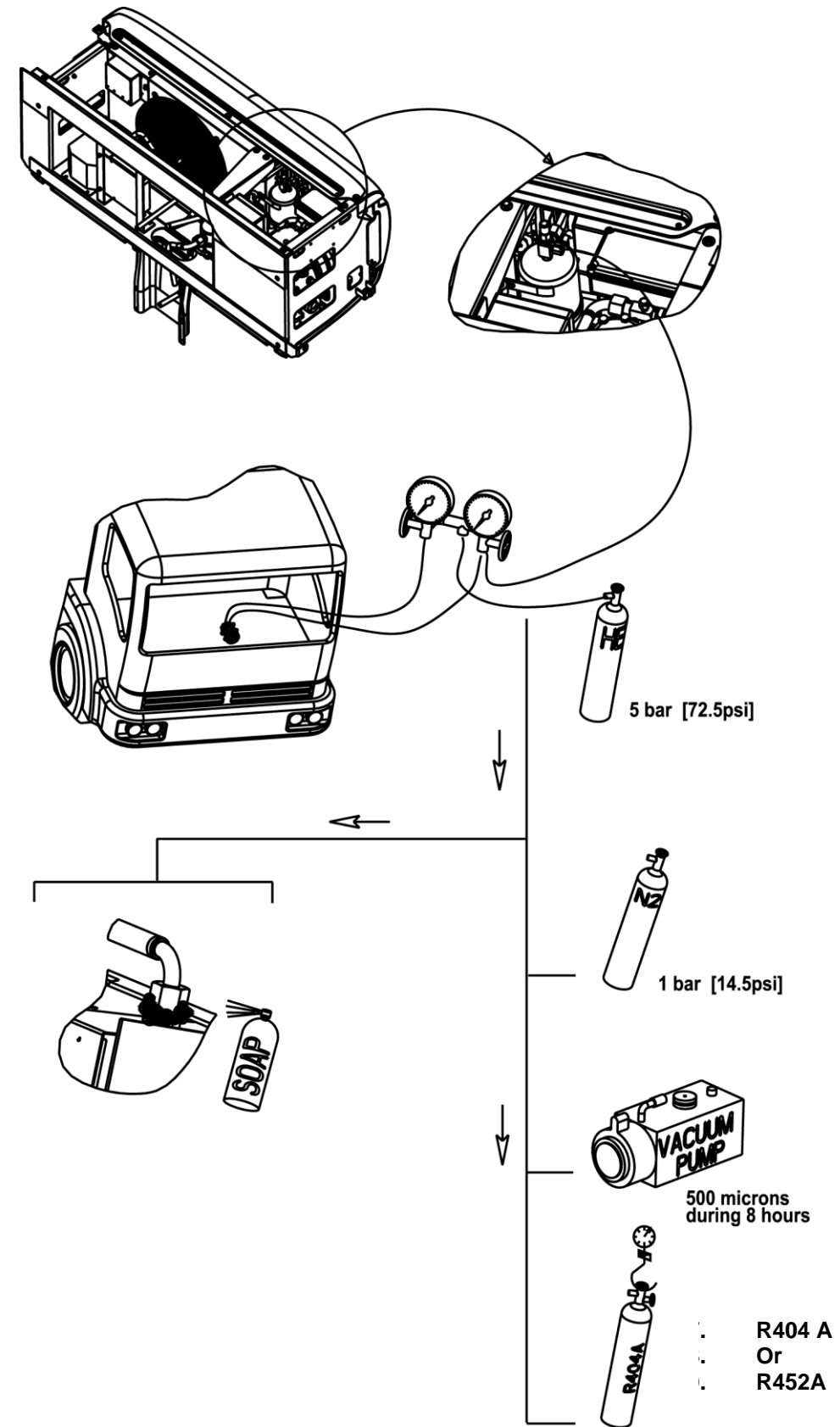

XARIOS 500-04 / INTEGRA 40X :
3 Kg (6.6 lb)

XARIOS 600 / INTEGRA 50X :
3.2 Kg (7.1 lb)

XARIOS 500-04 & 600 INSTALLATION INSTRUCTIONS
(INTEGRA 40X/50X) P/N 98-60503-00 Rev.E



Carrier
A United Technologies Company

CARRIER TRANSICOLD DIVISION, CARRIER CORPORATION
CARRIER TRANSICOLD INDUSTRIES S.A.S.
BP 16
76520 FRANQUEVILLE ST PIERRE – France
RC ROUEN 8 310 041 577

THIS DOCUMENT IS THE PROPERTY OF CARRIER CORPORATION AND IS
DELIVERED UPON THE EXPRESS CONDITION THAT THE CONTENTS WILL
NOT BE DISCLOSED OR USED WITHOUT CARRIER CORPORATION
WRITTEN CONSENT.

SUBMISSION OF THESE DRAWINGS OR DOCUMENTS DOES NOT
CONSTITUTE PART PERFORMANCE OR ACCEPTANCE OF CONTACT

18

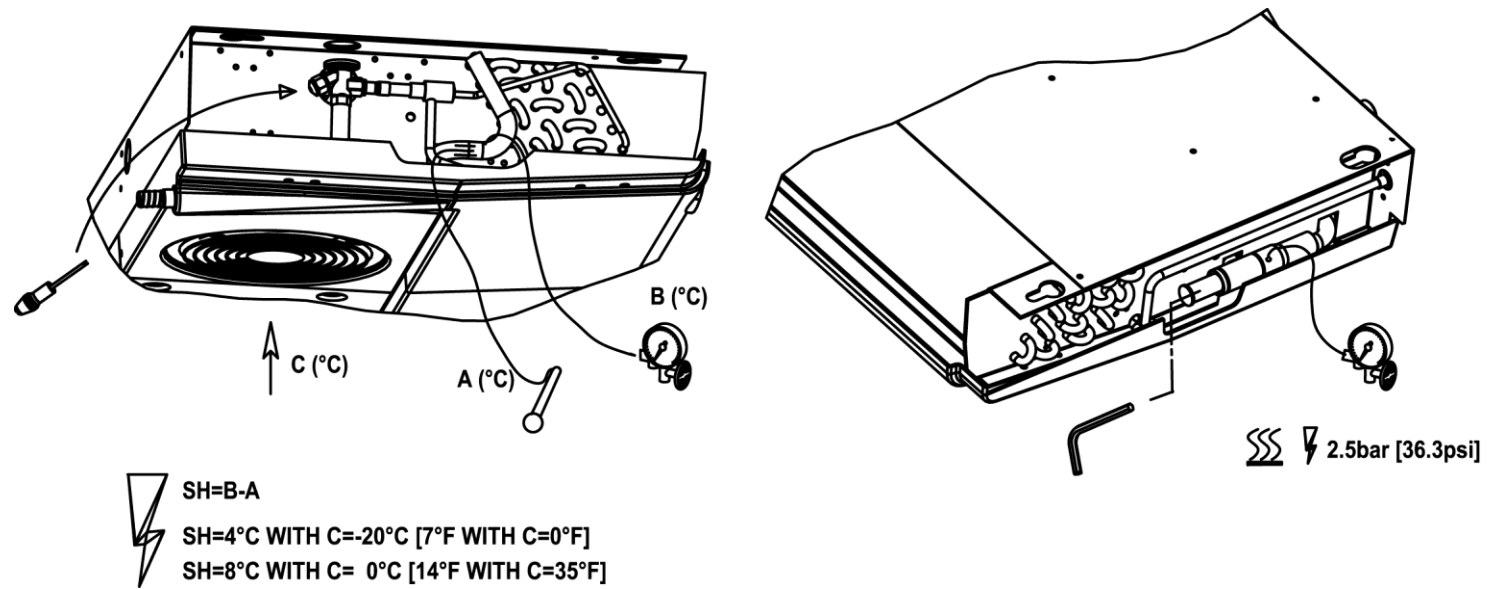

19

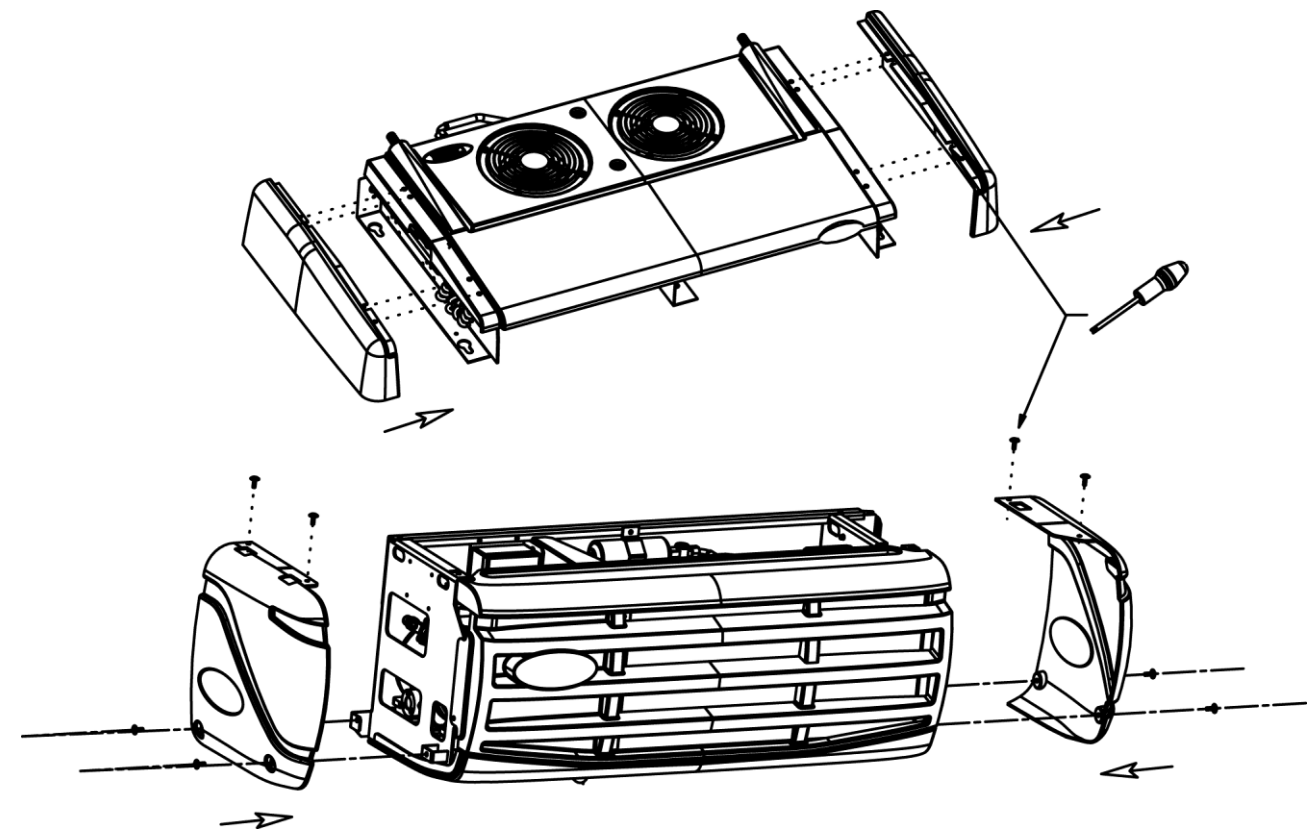

➤ COMPRESSOR



Read carefully the following instructions, strict observance of these procedures are essential for operator safety.



DO NOT SWITCH ON COMPRESSOR WITH TERMINAL BOX OPEN.
REMOVE TERMINAL BOX COVER ONLY WITH POWER SOURCE DISCONNECTED.
WIRING DIAGRAMS AND FURTHER INSTRUCTIONS INSIDE THE TERMINAL BOX.



BEFORE COMPRESSOR INSTALLATION, SLOWLY OPEN THE PLUG ON THE DISCHARGE VALVE AND VENT THE NITROGEN HOLDING CHARGE.
ENSURE THAT SUCTION AND DISCHARGE VALVES ARE OPEN BEFORE STARTING THE COMPRESSOR.



DO NOT TOUCH THE COMPRESSOR SHORTLY AFTER STOPPING AS SURFACE TEMPERATURES WILL BE DANGEROUS.

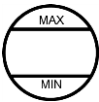

CHECK THE LEVEL OF THE LUBRICANT, IT MUST BE WITHIN ¼ AND ¾ OF THE OIL SIGHTGLASS.



DO NOT OPERATE THE COMPRESSOR WITH HYDROCARBON GASES.

➤ WHEN INSTALLING

- WHEN HANDLING THE UNIT, USE SUITABLE LIFTING GEAR ATTACHED TO THE EYE-BOLTS PROVIDED FOR THAT PURPOSE ON THE UNIT ;
- NOTE : THE UNIT SHOULD NOT PROTUDE OUT OF THE BODY.

➤ BATTERY

- NEVER LEAVE A UNIT MORE THAN A MONTH WITHOUT RUNNING ; IN CASE OF LONG STANDSTILL, CHARGE THE BATTERY INDEPENDENTLY ;
- BEFORE PERFORMING ANY WELDING ON THE CHASSIS, TAKE CARE TO DISCONNECT THE BATTERY FROM THE UNIT AND THE VEHICLE AS WELL AS FROM THE CHARGE ALTERNATOR AND ANY OTHER ELECTRONIC SYSTEM (MICROPROCESSOR).
- NEVER TRY TO START THE VEHICLE WITH A BOOSTER BECAUSE THIS COULD DAMAGE THE ELECTRONIC COMPONENTS IN THE UNIT OR ON THE VEHICLE ;

EXTRACT FROM MATERIAL SAFETY DATA BULLETIN

4.1 Polyolester oil (POE oil)

1. PRODUCT AND COMPANY IDENTIFICATION

CARRIER TRANSICOLD INDUSTRIES
810 route de Paris
76520 FRANQUEVILLE ST PIERRE
FRANCE

4. FIRST AID MEASURES

EYE CONTACT :
flush thoroughly with water. If irritation occurs, call a physician.
SKIN CONTACT :
wash contact areas with soap and water. High pressure accidental injection through the skin requires immediate medical attention for possible incision, irrigation and/or debridement.
INHALATION :
not expected to be a problem.
INGESTION :
not expected to be a problem. However, if greater than 1/2 liter (pint) ingested, seek medical attention.

5. FIRE-FIGHTING MEASURES

EXTINGUISHING MEDIA :
carbon dioxide, foam, dry chemical and water fog
SPECIAL FIRE FIGHTING PROCEDURES :
water or foam may cause frothing. Use water to keep fire exposed containers cool. Water spray may be used to flush spills away from exposure. Prevent runoff from fire control or dilution from entering streams, sewers, or drinking water supply.
SPECIAL PROTECTIVE EQUIPMENT :
for fires in enclosed areas, fire fighters must use self-contained breathing apparatus.
UNUSUAL FIRE AND EXPLOSION HAZARDS :
none. Flash point C (F) : 232 (450) (ASTM D-92). Flammable limits - LEL : NA, UEL: NA.
NFPA HAZARD ID :
health : 0,
flammability : 1,
reactivity : 0
HAZARDOUS DECOMPOSITION PRODUCTS :
carbon monoxide

6. ACCIDENTAL RELEASE MEASURES

PROCEDURES IF MATERIAL IS RELEASED OR SPILLED :
small spills can be absorbed with fire retardant treated sawdust, diatomaceous earth, etc. Contain and remove larger spills for salvage or disposal according to applicable regulation.
ENVIRONMENTAL PRECAUTIONS :
prevent spills from entering storm sewers or drains and contact with soil.
PERSONAL PRECAUTIONS :
see section 8.

7. HANDLING AND STORAGE

STORAGE :
do not store in open or unlabelled containers. Store away from strong oxidizing agents or combustible material.

8. EXPOSURE CONTROLS / PERSONAL PROTECTION

VENTILATION :
no special requirements under ordinary conditions of use and with adequate ventilation.
RESPIRATORY PROTECTION :
no special requirements under ordinary conditions of use and with adequate ventilation.

EYE PROTECTION :

normal industrial eye protection practices should be employed.
SKIN PROTECTION :
no special equipment required. However, good personal hygiene practices should always be followed.

10. STABILITY AND REACTIVITY

HAZARDOUS DECOMPOSITION PRODUCTS :
carbon monoxide (in case of fire)

13. DISPOSAL CONSIDERATIONS

WASTE DISPOSAL :
EVEN THOUGH THIS PRODUCT IS READILY BIODEGRADABLE, IT MUST NOT BE INDISCRIMINATELY DISCARDED INTO THE ENVIRONMENT.

This product is suitable for burning in an enclosed, controlled burner for fuel value and for recycling at an approved facility. In addition, it can be disposed of at an approved waste disposal facility. Land farming and processing through sewage treatment facilities may be available disposal options but necessary approvals must first be obtained from appropriate regulatory authorities. Specific characteristics of the waste at the time of disposal may affect the availability of the above options.

The complete data sheets are available in English and French from Carrier Transicold Industries on request.