



Carrier Transicold Division
Carrier Corporation
P.O. Box 4805
Syracuse, New York 13221

THIS DOCUMENT AND THE INFORMATION CONTAINED THEREIN IS PROPRIETARY TO CARRIER CORPORATION AND SHALL NOT BE USED OR DISCLOSED TO OTHERS, IN WHOLE OR IN PART, WITHOUT THE WRITTEN AUTHORIZATION OF CARRIER CORPORATION.

SUBMISSION OF THESE DRAWINGS OR DOCUMENTS DOES NOT CONSTITUTE PART PERFORMANCE OR ACCEPTANCE OF CONTRACT

UNIT PREPARATION AND INSTALLATION PROCEDURE.

NOTE: THE FOLLOWING INSTRUCTIONS ARE FOR INSTALLING BUMPER ONTO A MOUNTED TRAILER UNIT.

- 1.0 REMOVE UPPER SURROUND/GRILLE ASSY FROM UNIT, RETAIN CENTER MOUNTING SCREW FOR REINSTALLATION.
- 2.0 DISCARD SCREWS (BUT NOT FENDER WASHERS) FROM EACH END ON TOP OF SHROUD. USE A 3/8" DRILL BIT TO DRILL OUT RIV NUTS ON EACH END. FOLLOW BY USING AN APPROPRIATE DRILL TO ENLARGE THE TOP END HOLES TO .540 DIA FOR A 3/8-16 RIV NUT. INSTALL 3/8-16 RIV NUT (IT. 15) EACH END.
- 3.0 INSPECT FRAME TO SEE IF 0.69 DIA HOLES ARE PRE-EXISTING IN FRAME. IF HOLES ARE NOT PRESENT SEE DETAIL "A" FOR DIMENSIONS TO LOCATE AND DRILL REQUIRED HOLES.
- 4.0 REMOVE RUBBER PLUGS (2) FROM TOP REAR FRAME POSTS. DISCARD PLUGS.
- 5.0 REMOVE SCREWS AND RIV NUTS FOR ATTACHING UPPER SIDE SURROUND MOUNTING (AS INDICATED). USE A 3/8" DRILL BIT ON RIV NUTS. DISCARD RIV NUT. WITH RIV NUTS REMOVED OPEN HOLES UP WITH A 1/2" DRILL BIT (THIS WILL ENSURE ADEQUATE CLEARANCE WHEN FASTENERS ARE REINSTALLED).
- 6.0 REMOVE UPPER UNIT MOUNTING NUTS AND WASHERS FROM EACH SIDE OF VERTICAL FRAME TUBES. RETAIN FOR RE-INSTALLATION.
- 7.0 REMOVE (3) 1/4" SCREWS FROM THE VERTICAL BUMPER SUPPORT CHANNELS.

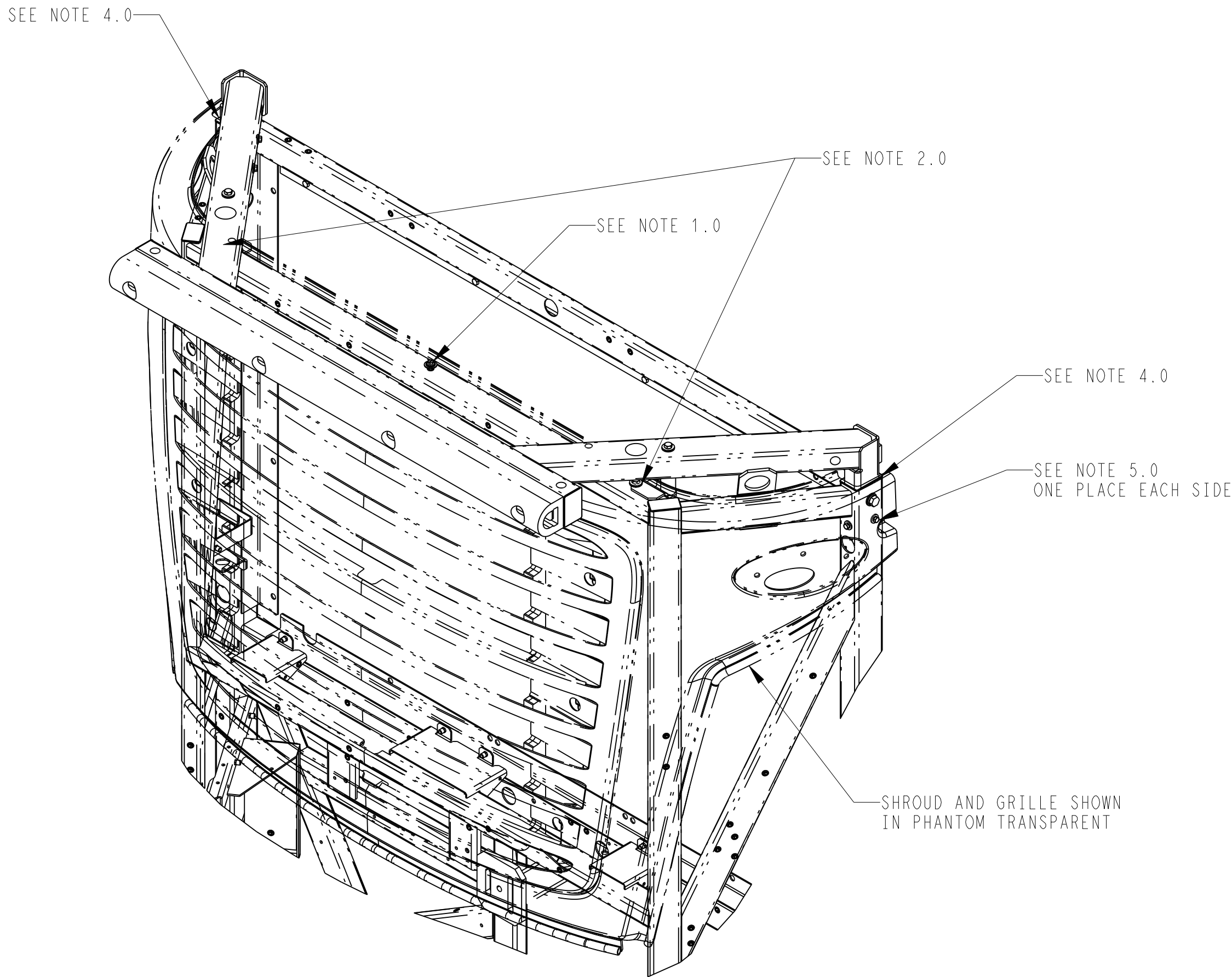

UNIT PREPARATION AND INSTALLATION PROCEDURE CONTINUED

- 8.0 INSTALL VERTICAL BUMPER CHANNELS INTO TOP OF VERTICAL FRAME TUBES UNTIL THEY CONTACT THE UNIT MOUNTING STUDS. VERIFY THAT BUMPER IS FULLY SEATED ONTO MOUNTING STUDS THEN REINSTALL UNIT MOUNTING WASHERS AND NUTS. DO NOT TIGHTEN COMPLETELY. INSTALL 1/2" SCREWS WITH SUPPLIED FLAT AND LOCK WASHERS ON EACH SIDE ALONG WITH 1/4" HARDWARE REMOVED IN STEP 7. DO NOT TIGHTEN COMPLETELY.
- 9.0 ASSEMBLE BRACKET, ROAD SIDE (IT.25) TO FRAME. HOLD LOOSELY WITH ORIGINAL FENDER WASHER, NEW WASHER (IT. 10), AND NEW SCREW (IT. 3).
- 10.0 ASSEMBLE BRACKET, CURB SIDE (IT.30) TO FRAME. HOLD LOOSELY WITH ORIGINAL FENDER WASHER, NEW WASHER (IT. 10), AND NEW SCREW (IT. 3).
- 11.0 INSTALL SPACERS (ITEM 18) QTY OF 2, BETWEEN BOTTOM OF BUMPER ASSY AND TOP OF EACH BUMPER BRACKET INSTALLED IN NOTES 9 & 10.
- 12.0 INSTALL SCREWS (ITEM 6) QTY OF 2 (ONE EACH SIDE), WASHER (ITEM 10) QTY OF 4 (TWO EACH SDE) TO TOP OF BUMPER ASSY THRU SPACER AND BUMPER BRACKETS. INSTALL WASHER (ITEM 10) QTY OF 4 (TWO EACH SIDE) AND AND LOCK NUT (ITEM 8) QTY OF 2 (ONE EACH SIDE) UNDER BRACKETS.
- 13.0 TIGHTEN UNIT MOUNTING NUTS AND 1/2" SCREWS. REMOVE ALL 1/4" SCREWS ON SIDE OF FRAME AND ON BRACKETS FOR SHROUD ASSY.
- 14.0 REINSTALL SURROUND USING ORIGINAL CENTER TOP HARDWARE AND 3 SETS OF ORIGINAL BOTTOM HARDWARE. DO NOT TIGHTEN COMPLETELY
- 15.0 FULLY TIGHTEN ALL BUMPER AND SURROUND HARDWARE.

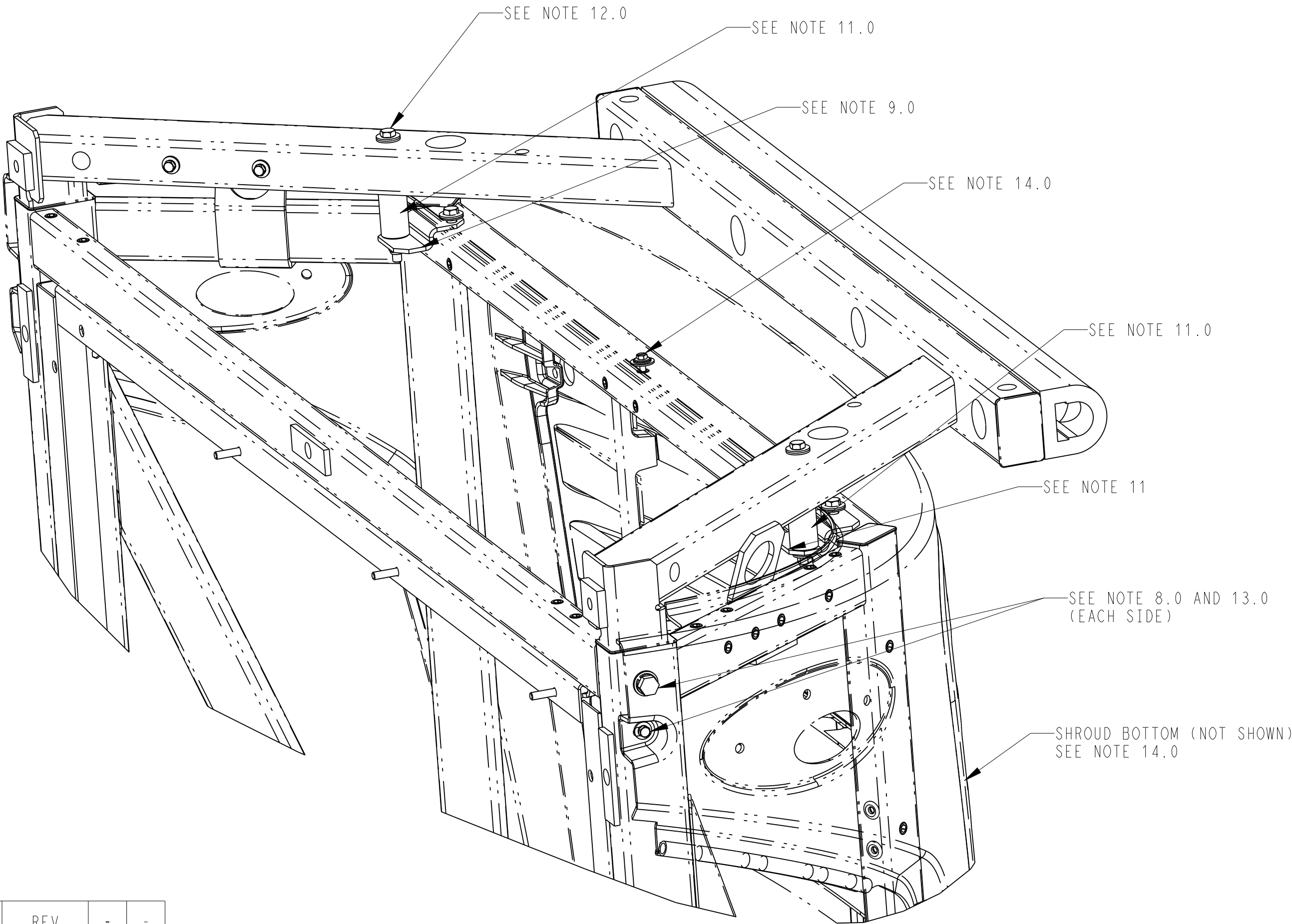

| | | | | | | | | | | | |
|-----|------------------|-----------|-----|-------|------|------------|---------------------------|---|--|---|----------|
| - | INITIAL RELEASE. | 05 MAY 15 | ZMG | | | 72N0263P15 | THIRD ANGLE PROJECTION | IMPERIAL INCH FORMAT: UNLESS OTHERWISE SPECIFIED DIMENSIONS ARE IN INCHES WITH METRIC CONVERSIONS IN [MILLIMETERS] | TITLE INSTALLATION INSTRUCTIONS CONDENSER BUMPER | DRAWING NO. 98-03345 SHEET 1 of 2 | REV - |
| SYM | REVISION RECORD | DATE | BY | ENGR. | M.E. | NPCA NO. | | | | | |

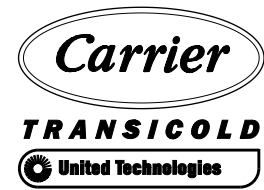

Carrier Transicold Division
Carrier Corporation
P.O. Box 4805
Syracuse, New York 13221

THIS DOCUMENT AND THE INFORMATION CONTAINED THEREIN IS
PROPRIETARY TO CARRIER CORPORATION AND SHALL NOT BE USED
OR DISCLOSED TO OTHERS, IN WHOLE OR IN PART, WITHOUT THE
WRITTEN AUTHORIZATION OF CARRIER CORPORATION.

SUBMISSION OF THESE DRAWINGS OR DOCUMENTS
DOES NOT CONSTITUTE PART PERFORMANCE OR
ACCEPTANCE OF CONTRACT

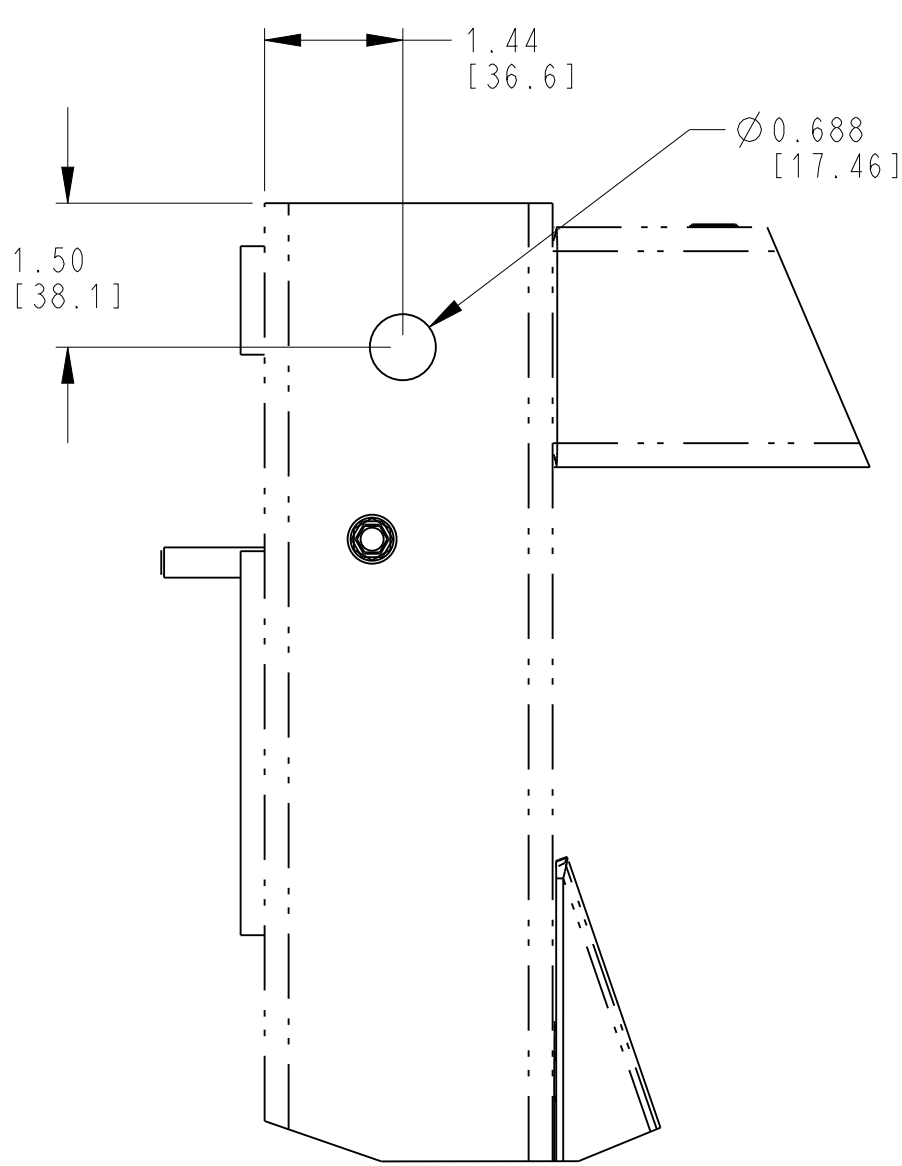
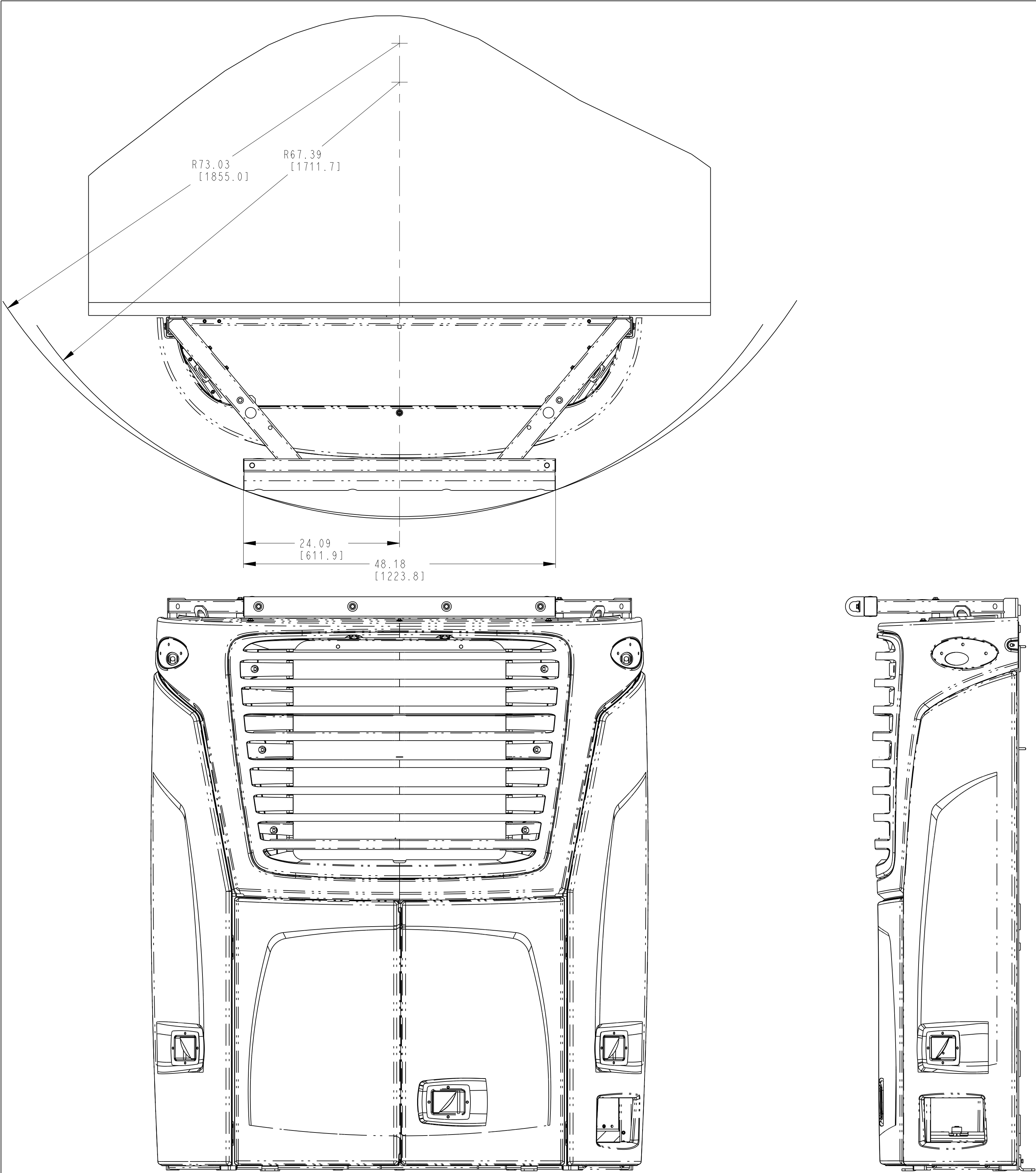

CURBSIDE OF FRAME
SCALE 0.500

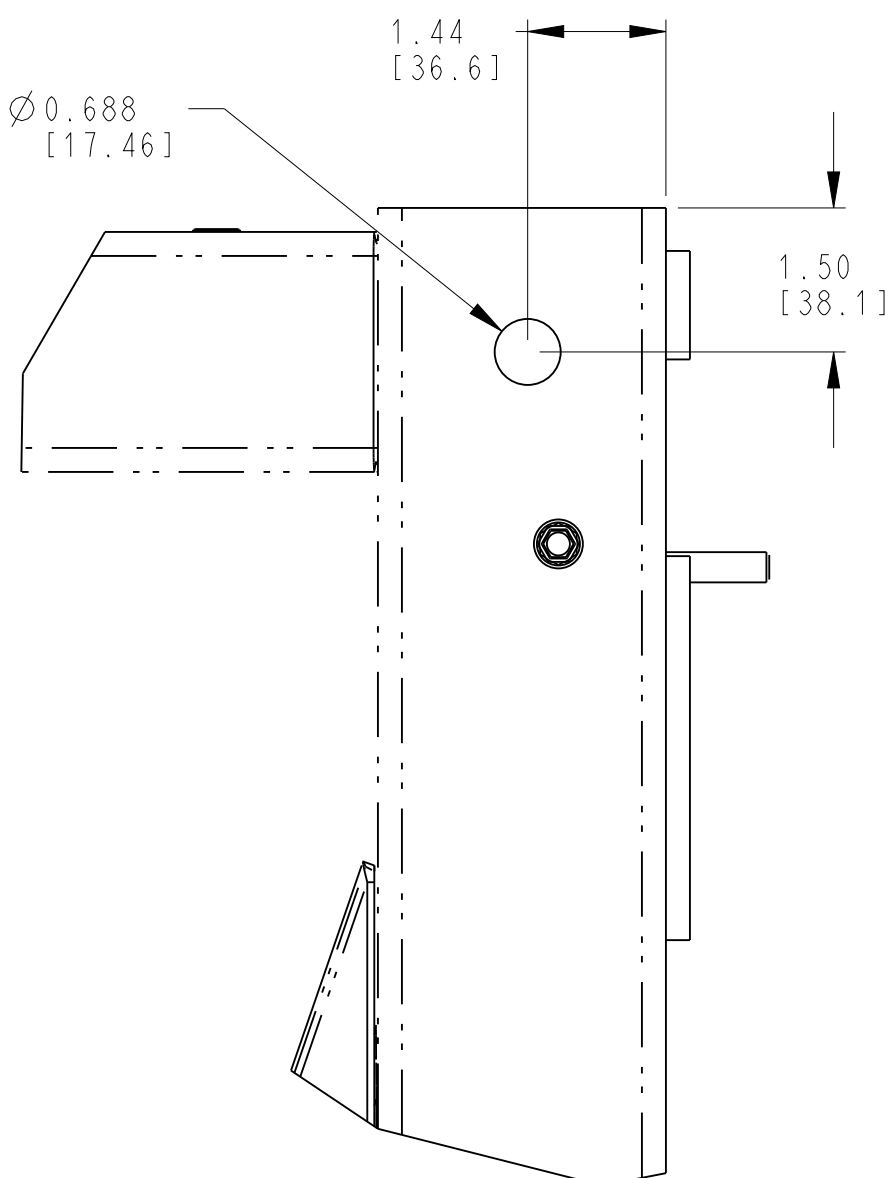

ROADSIDE OF FRAME
SCALE 0.500

DETAIL A
Ø0.69 HOLE LOCATIONS ON VERTICAL FRAME MEMBERS.
DRILL HOLES IF REQUIRED.

| | | | | | | | | | | | |
|-----|------------------|-----------|-----|-------|------|------------|---------------------------|---|--|---------------------------------------|----------|
| - | INITIAL RELEASE. | 05 MAY 15 | ZMG | | | 72N0263P15 | THIRD ANGLE PROJECTION | IMPERIAL INCH FORMAT: UNLESS OTHERWISE SPECIFIED DIMENSIONS ARE IN INCHES WITH METRIC CONVERSIONS IN [MILLIMETERS] | TITLE INSTALLATION INSTRUCTIONS CONDENSER BUMPER | DRAWING NO. 98-03345 SHEET 2 OF | REV 1 |
| SYM | REVISION RECORD | DATE | BY | ENGR. | M.E. | NPCA NO. | | | | | |

SUPSEDES _____

PRINT DISTRIBUTION _____

EXPORT CLASSIFICATION: